

- 11 STA. 563+85.0, 24.0' RT.
CB TA 4 DIA. T23F&G
RIM EL. = 679.30
INV. EL. = 671.23 (NE)
- 12 STA. 563+85.0, 24.0' RT.
INLET TA T23F&G
RIM EL. = 679.11
INV. EL. = 676.61
- 13 STA. 562+75.0, 26.0' RT.
MAN TA 4 DIA T23F&G
RIM EL. = 679.37
INV. EL. = 676.08 (SE)
INV. EL. = 676.08 (NE)
- 14 STA. 562+75.0, 43.5' LT.
FR & LIDS ADJUST SPL
RIM EL. = 678.80
INV. EL. = 671.00 (NE)
INV. EL. = 671.00 (NW)
INV. EL. = 674.30 (SE)
INV. EL. = 674.07 (SW)

- 11 7' - STORM SEW CL A 1, 12" @ 2.00%
T.B.F. = 3 CU. YD.
- 12 107' - STORM SEW CL A 1, 12" @ 0.50%
T.B.F. = 25 CU. YD.
- 13 67' - STORM SEW CL A 1, 12" @ 3.00%
T.B.F. = 30 CU. YD.

TEST HOLES (TH)			
TH	STATION	OFFSET	TOP OF UTILITY ELEV.
11	562+88.40	27.80 RT	675.72
12	562+88.47	31.24 RT	676.11
13	563+87.03	28.11 RT	675.39
14	563+86.92	31.65 RT	675.92

DATE	
BY	
REVIEWED	
PLOTTED	
NOTE BOOK	
NO.	

DATE	
BY	
REVIEWED	
PLOTTED	
NOTE BOOK	
NO.	

MATCH LINE STA. 562+00
(SEE SHEET NO. 42)

BEGIN OMISSION
STA. 564+66

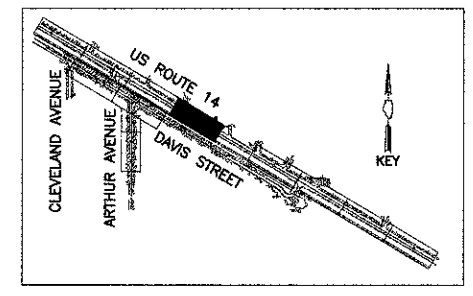
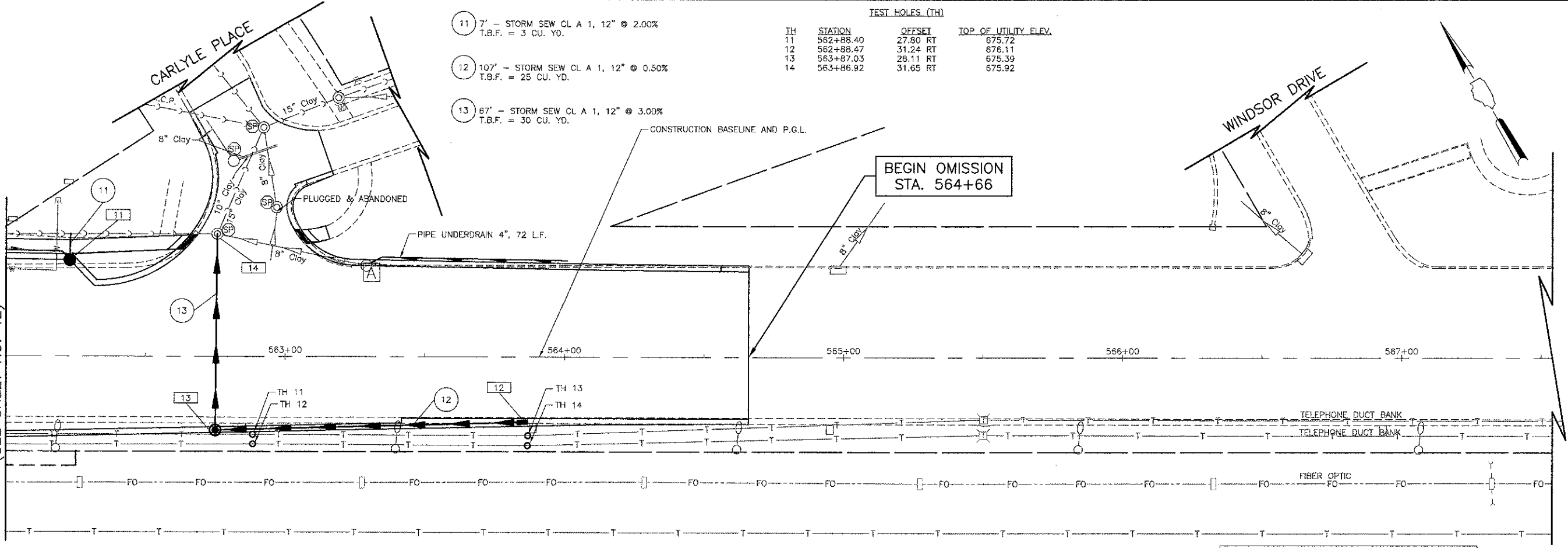

U.S. ROUTE 14

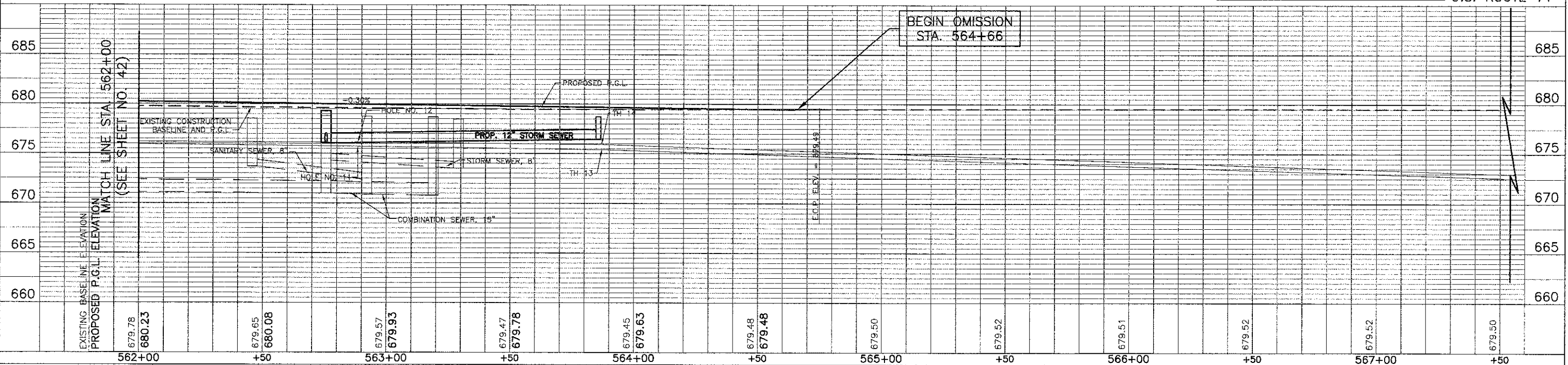

BEGIN OMISSION
STA. 564+66

EXISTING BASELINE ELEVATION	679.78	680.23	679.65	680.08	679.57	679.93	679.47	679.78	679.45	679.63	679.48	679.48	679.50	679.52	679.51	679.52	679.52	679.50
PROPOSED P.G.L. ELEVATION	679.78	680.23	679.65	680.08	679.57	679.93	679.47	679.78	679.45	679.63	679.48	679.48	679.50	679.52	679.51	679.52	679.52	679.50



USER NAME = #USER#	DESIGNED - RTM	REVISED -
PLOT SCALE = #SCALE#	DRAWN - JRR	REVISED -
PLOT DATE = #DATE#	CHECKED - RTM	REVISED -
	DATE - 10/22/12	REVISED -

STATE OF ILLINOIS
DEPARTMENT OF TRANSPORTATION

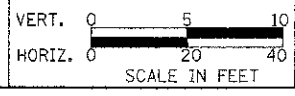

DRAINAGE AND UTILITIES - U.S. ROUTE 14 WEST

F.A.U. RTE. 3512	SECTION 02-00177-00 WR	COUNTY COOK	TOTAL SHEETS 142	SHEET NO. 43
PROJECT NO. M-8003(426)		CONTRACT NO. 63514		
FED. ROAD DIST. NO. 1 ILLINOIS FED. AID PROJECT				

SHEET NO. 4 OF 12 SHEETS STA. 562+50 TO STA. 564+65