

PLAN
 SURVEYED
 ADJUSTED
 NOTE BOOK
 DATE
 BY
 CHECKED
 DATE
 BY

PROFILE
 SURVEYED
 ADJUSTED
 NOTE BOOK
 DATE
 BY
 CHECKED
 DATE
 BY

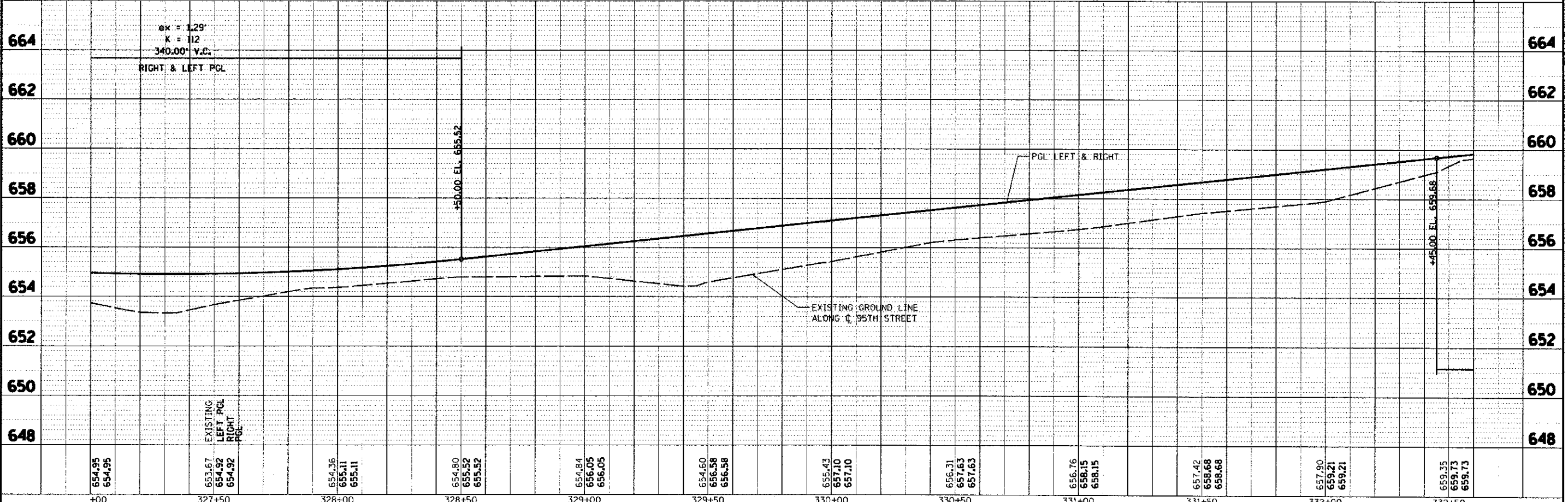
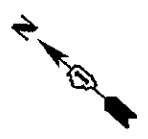
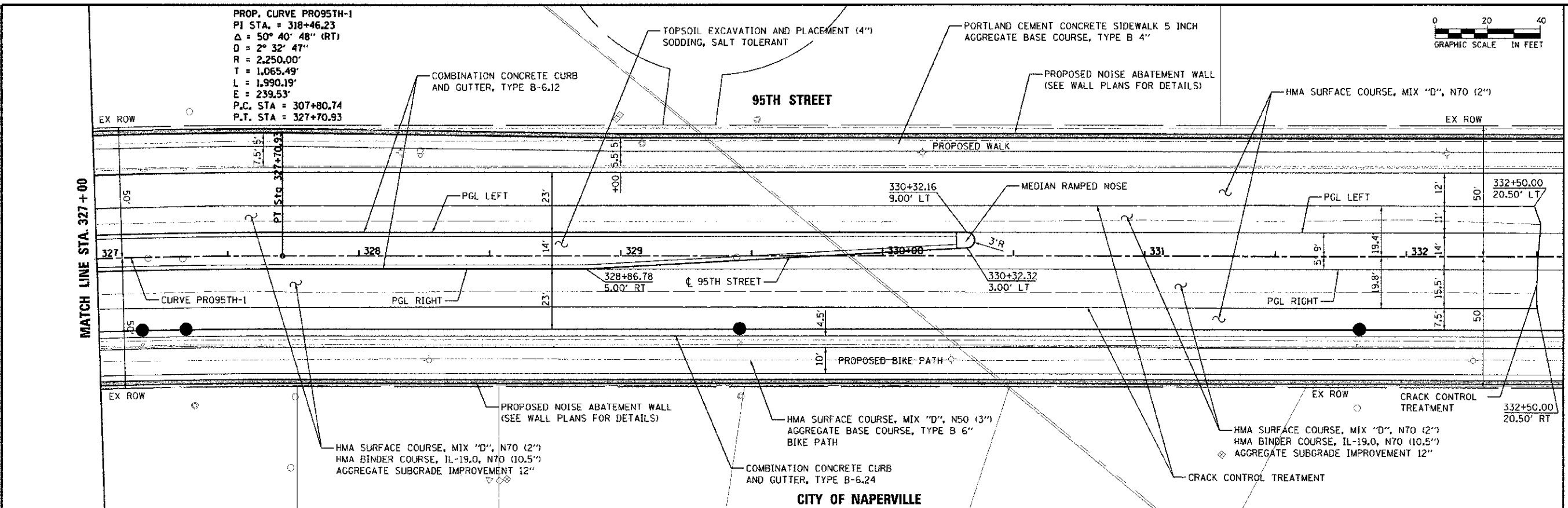

654.95	654.95	653.67	654.36	654.80	654.84	654.60	655.43	656.31	656.76	657.42	657.90	659.35
654.95	654.92	655.11	655.52	656.05	656.58	657.10	657.63	658.15	658.68	659.21	659.73	659.73
+00	327+50	328+00	328+50	329+00	329+50	330+00	330+50	331+00	331+50	332+00	332+50	332+60

URS
 100 S. WACKER DR.
 SUITE 500
 CHICAGO, IL 60606
 TEL (312) 939-4000
 FAX (312) 939-4000

DESIGNED - JRP	REVISOR
DRAWN - KB	REVISOR
CHECKED - JRP	REVISOR
DATE - 10/19/2012	REVISOR

STATE OF ILLINOIS
 DEPARTMENT OF TRANSPORTATION

95TH STREET
 ROADWAY PLAN & PROFILE
 SCALE: 1"=20' DRAWING NO. 5 OF 17 STA. 327+00 TO STA. 332+60

F.A.U. R.T.E. 1644	SECTION 01-00181-00-FP	COUNTY WILL	TOTAL SHEETS 328	SHEET NO. 40
CONTRACT NO. 63647			ILLINOIS FED. AID PROJECT	