

**LEGEND**

- 1 THERMOPLASTIC PAVEMENT MARKING - LINE 4" (SOLID YELLOW)
- 2 THERMOPLASTIC PAVEMENT MARKING - LINE 4" (DOUBLE YELLOW, 11" C-C)
- 3 THERMOPLASTIC PAVEMENT MARKING - LINE 4" (SOLID WHITE)
- 4 THERMOPLASTIC PAVEMENT MARKING - LINE 4" (WHITE SKIP DASH, 10' LINE 30' SPACE)
- 5 THERMOPLASTIC PAVEMENT MARKING - LINE 12" (YELLOW DIAGONALS @ 30' C-C)
- 6 THERMOPLASTIC PAVEMENT MARKING - LINE 6" (SOLID WHITE)
- 7 THERMOPLASTIC PAVEMENT MARKING - LINE 6" (WHITE SKIP DASH, 2' LINE 6' SPACE)
- 8 THERMOPLASTIC PAVEMENT MARKING - LINE 12" (WHITE DIAGONALS @ 3' C-C)
- 9 THERMOPLASTIC PAVEMENT MARKING - LINE 24" (SOLID WHITE STOP BAR)
- 10 THERMOPLASTIC PAVEMENT MARKING - LETTERS AND SYMBOLS (WHITE)
- 11 RAISED REFLECTIVE PAVEMENT MARKER (AMBER 2-WAY @ 40' C-C)
- 12 RAISED REFLECTIVE PAVEMENT MARKER (AMBER 1-WAY @ 40' C-C)
- 13 RAISED REFLECTIVE PAVEMENT MARKER (CRYSTAL 1-WAY 2 EACH @ 80' C-C)
- 14 RAISED REFLECTIVE PAVEMENT MARKER (CRYSTAL 1-WAY @ 40' C-C)
- 15 POLYUREA PAVEMENT MARKING - LINE 4" (WHITE SKIP DASH, 10' LINE 30' SPACE)

**NOTE:**  
ALL RAISED REFLECTIVE PAVEMENT MARKERS USED WITH SKIP DASHES SHALL BE CENTERED IN THE GAP BETWEEN SEGMENTS, AND OFFSET 4 INCHES FROM THE CENTERLINE OF THE DASH TO MATCH THE EXISTING MARKERS ON THE COUNTY HIGHWAY

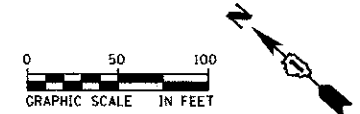

MATCH LINE STA. 348 + 25

MATCH LINE STA. 362 + 75

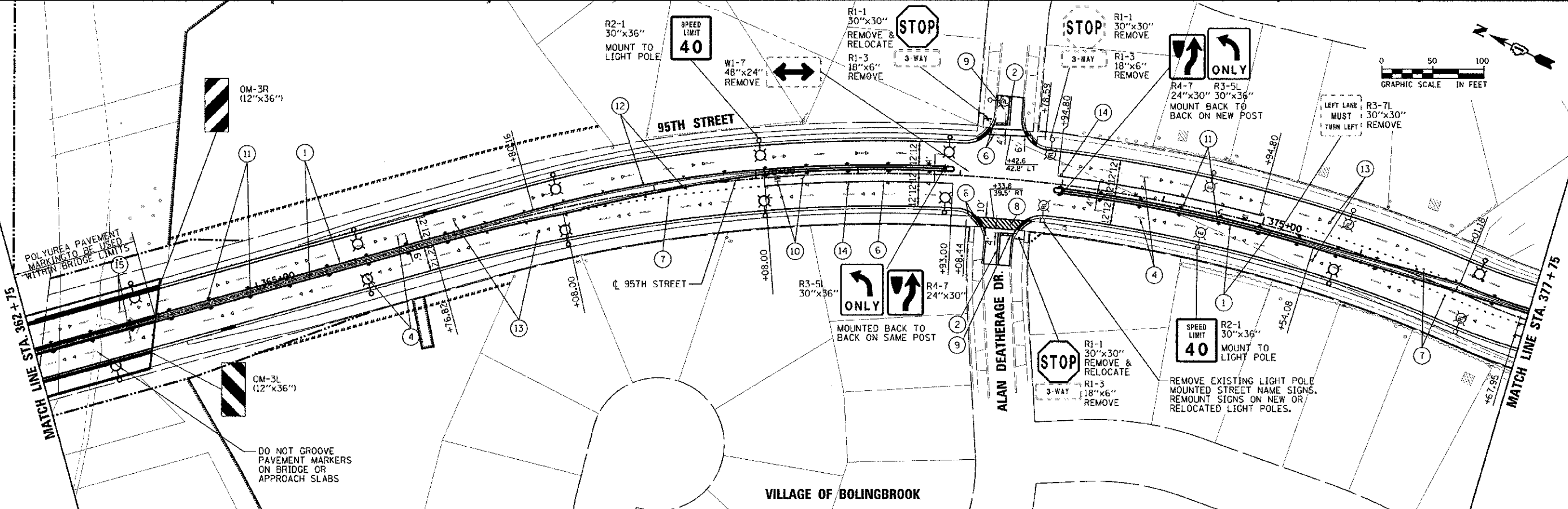
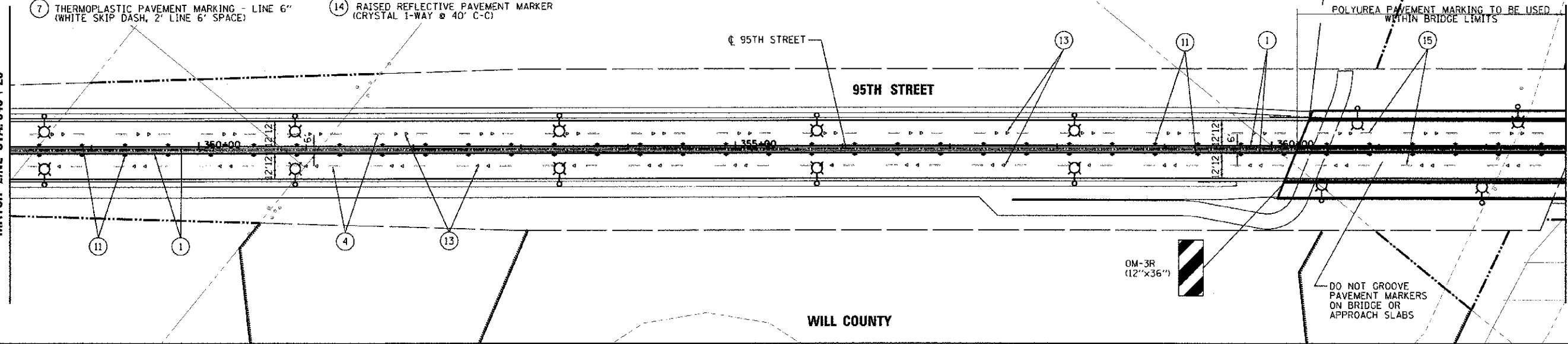

100 S. WACKER DR.  
SUITE 500  
CHICAGO, IL 60606  
TEL (312) 939-4000  
FAX (312) 939-4990

DESIGNED - JRP	REVISED -
DRAWN - MRF	REVISED -
CHECKED - JRP	REVISED -
DATE - 10/19/2012	REVISED -

**STATE OF ILLINOIS  
DEPARTMENT OF TRANSPORTATION**

**95TH STREET  
PAVEMENT MARKING & SIGNING PLAN**

SCALE: 1"=50' DRAWING NO. 3 OF 4 STA. 348+25 TO STA. 377+75

F.A.U. R.T.L. 1644	SECTION 01-00181-00-FP	COUNTY WILL	TOTAL SHEETS 328	SHEET NO. 115
CONTRACT NO. 63647				

PLOT NAME: C:\Users\jrp\Documents\Projects\95th Street\95th Street.dwg