

RESTORATION OF WORK AREA. RESTORATION OF THE TRAFFIC SIGNAL WORK AREA SHALL BE INCIDENTAL TO THE RELATED PAY ITEM SUCH AS FOUNDATION, CONDUIT, HANDHOLE, TRENCH AND BACKFILL, ETC., AND NO EXTRA COMPENSATION SHALL BE ALLOWED. ALL ROADWAY SURFACES SUCH AS SHOULDERS, MEDIANS, SIDEWALKS, PAVEMENT, ETC. SHALL BE REPLACED IN KIND. ALL DAMAGE TO MOWED LAWNS SHALL BE REPLACED WITH AN APPROVED SOD, AND ALL DAMAGE TO UNMOWED FIELDS SHALL BE SEEDED IN ACCORDANCE WITH STANDARD SPECIFICATIONS 252 AND 250 RESPECTIVELY.

SEE TRAFFIC SIGNAL PLANS FOR CONDUIT SIZING (CONDUIT INSTALLED AS INTERSECTION ITEM)

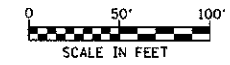

SCHEDULE OF QUANTITIES
(QUANTITIES INCLUDED IN TRAFFIC SIGNAL SCHEDULE OF QUANTITIES)

PAY ITEM	UNITS	QNTY.
UNDERGROUND CONDUIT, GALVANIZED STEEL, 2" DIA.	FOOT	48
HANDHOLE	EACH	1
TRANSCIEVER - FIBER OPTIC	EACH	1
PULL & REINSTALL FIBER OPTIC CABLE	L SUM	1

THE TRAFFIC SIGNAL CONTROL EQUIPMENT FOR THIS PROJECT SHALL BE ECONOLITE TO MATCH THE EXISTING SYSTEM.

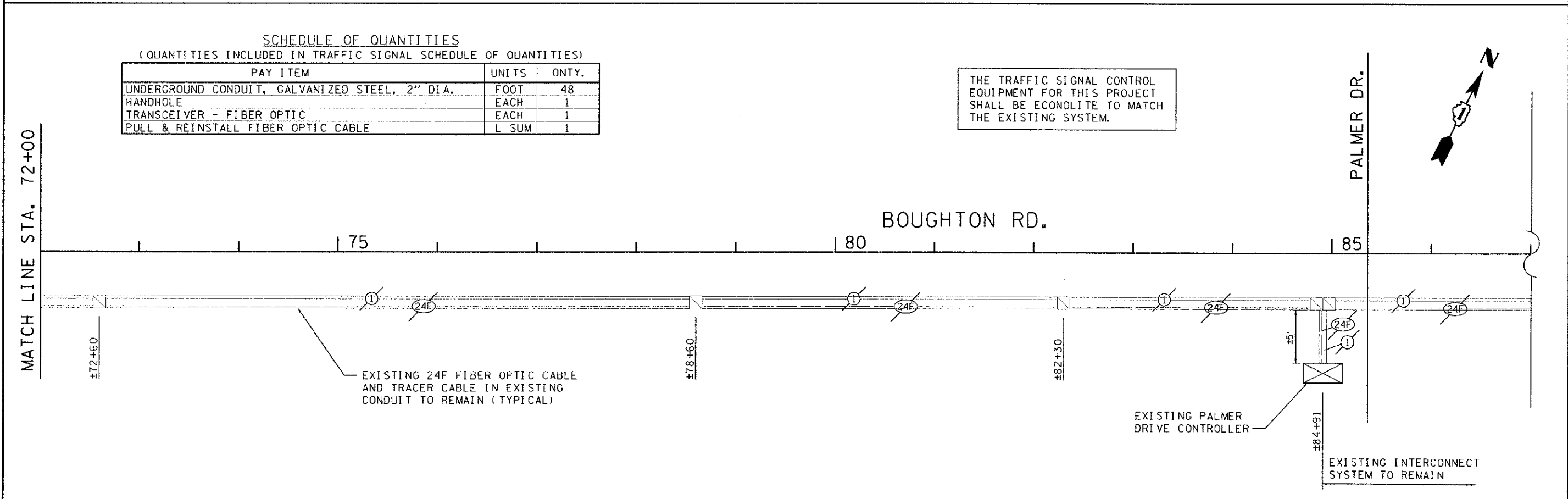

URS
100 S. WACKER DR.
SUITE 500
CHICAGO, IL 60606
TEL (312) 939-1000
FAX (312) 939-4198

USER NAME: james.pugh
DESIGNED: JRP
DRAWN: MRF
CHECKED: JRP
DATE: 10/19/2012
PLOT SCALE: 1/2" = 20' / 1/4" = 40'
PLOT DATE: 10/18/2012

DESIGNED: JRP
DRAWN: MRF
CHECKED: JRP
DATE: 10/19/2012
REVISED: -
REVISED: -
REVISED: -
REVISED: -

STATE OF ILLINOIS
DEPARTMENT OF TRANSPORTATION

INTERCONNECT SCHEMATIC
95TH/KINGS AND BOUGHTON RD
SCALE: 1" = 20' DRAWING NO. 6 OF 6 STA. TO STA.

P.A.U. RTE.	SECTION	COUNTY	TOTAL SHEETS	SHEET NO.
1644	01-00181-00-FP	WILL	328	122
CONTRACT NO. 63647				
ILLINOIS FED. AID PROJECT				