

- NOTES:**
- ALL LIGHT POLE SETBACKS SHOWN ARE MEASURED FROM THE BACK OF CURB TO THE CENTER OF THE POLE BASE.
 - THE CONTRACTOR SHALL FURNISH AND INSTALL BREAKAWAY BASES MEETING THE CONTRACT SPECIFICATIONS ON ALL NEW AND RELOCATED LIGHT POLES. EXISTING BASES THAT ARE IN GOOD CONDITION CAN BE REUSED WITH THE RELOCATED POLES. THE ENGINEER SHALL BE THE JUDGE OF THE REUSABILITY OF EXISTING EQUIPMENT. EXISTING COUPLINGS SHALL NOT BE REUSED.
 - THE FINAL LOCATIONS OF ALL ELECTRIC SERVICE TRANSFORMERS AND PEDESTALS FEEDING THE LIGHTING CABINETS SHALL BE DETERMINED BY THE UTILITY. ADJUSTMENTS TO THE LENGTH OF THE SERVICE CABLE AND CONDUIT SHALL BE MADE ACCORDINGLY. ALSO SEE GENERAL NOTE 13 ON LIGHTING SHEET 1 OF 30 FOR ADDITIONAL REQUIREMENTS.
 - ALL MATERIALS, EQUIPMENT, AND LABOR NEEDED TO INSTALL AND CONNECT THE SERVICE FROM THE UTILITY TRANSFORMER OR PEDESTAL TO THE LIGHTING CONTROLLER CABINET SHALL BE PART OF PAY ITEM NO. 80400100 - ELECTRIC SERVICE INSTALLATION. WORK SHALL INCLUDE THE CABLE, CONDUIT AND TRENCHING FOR THE CONDUIT SHOWN ON THE PLANS. ALL CONNECTIONS, SPLICING, AND WIRING TO THE NEW LIGHTING CONTROLLER ARE ALSO INCLUDED UNDER THE SAME PAY ITEM. THE SERVICE CABLE AND CONDUIT SIZE SHALL BE AS SHOWN ON THE PLANS.

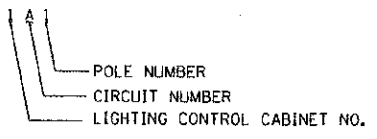
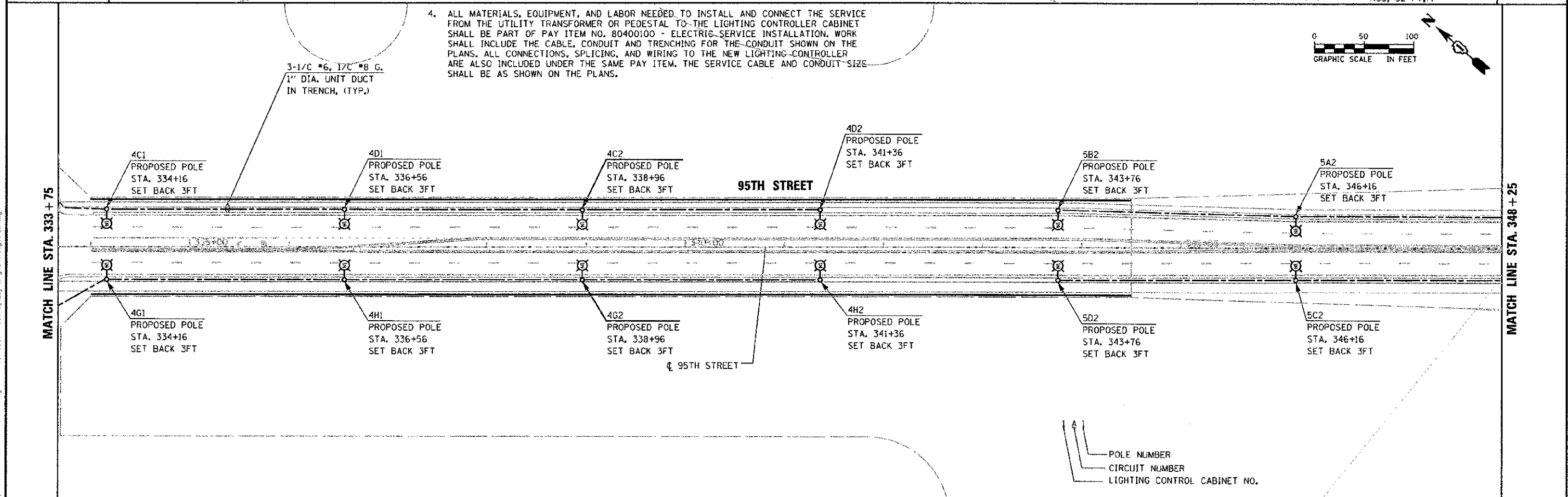

URS 100 S. WACKER DR. SUITE 500 CHICAGO, IL 60606 TEL (312) 939-1000 FAX (312) 939-4198	USER NAME: james.pugh PLOT SCALE: 1"=50' PLOT DATE: 4/16/2012	DESIGNED: MAE DRAWN: MAE CHECKED: DAD DATE: 2/1/2012	REVISED: - REVISED: - REVISED: - REVISED: -	STATE OF ILLINOIS DEPARTMENT OF TRANSPORTATION	95TH STREET PROPOSED LIGHTING PLAN (SHEET 2 OF 4) SCALE: 1"=50' DRAWING NO. 4 OF 30 STA. 318+75 TO STA. 348+25	F.A.J. RTE. 1644 SECTION 01-001B1-00-PP COUNTY WILL TOTAL SHEETS 328 SHEET NO. 132 CONTRACT NO. 63647 ILLINOIS FED. AID PROJECT
---	---	---	--	--	---	---