

(SEE DRAWING NO. 5 OF 35)  
MATCH LINE STA. 377+75

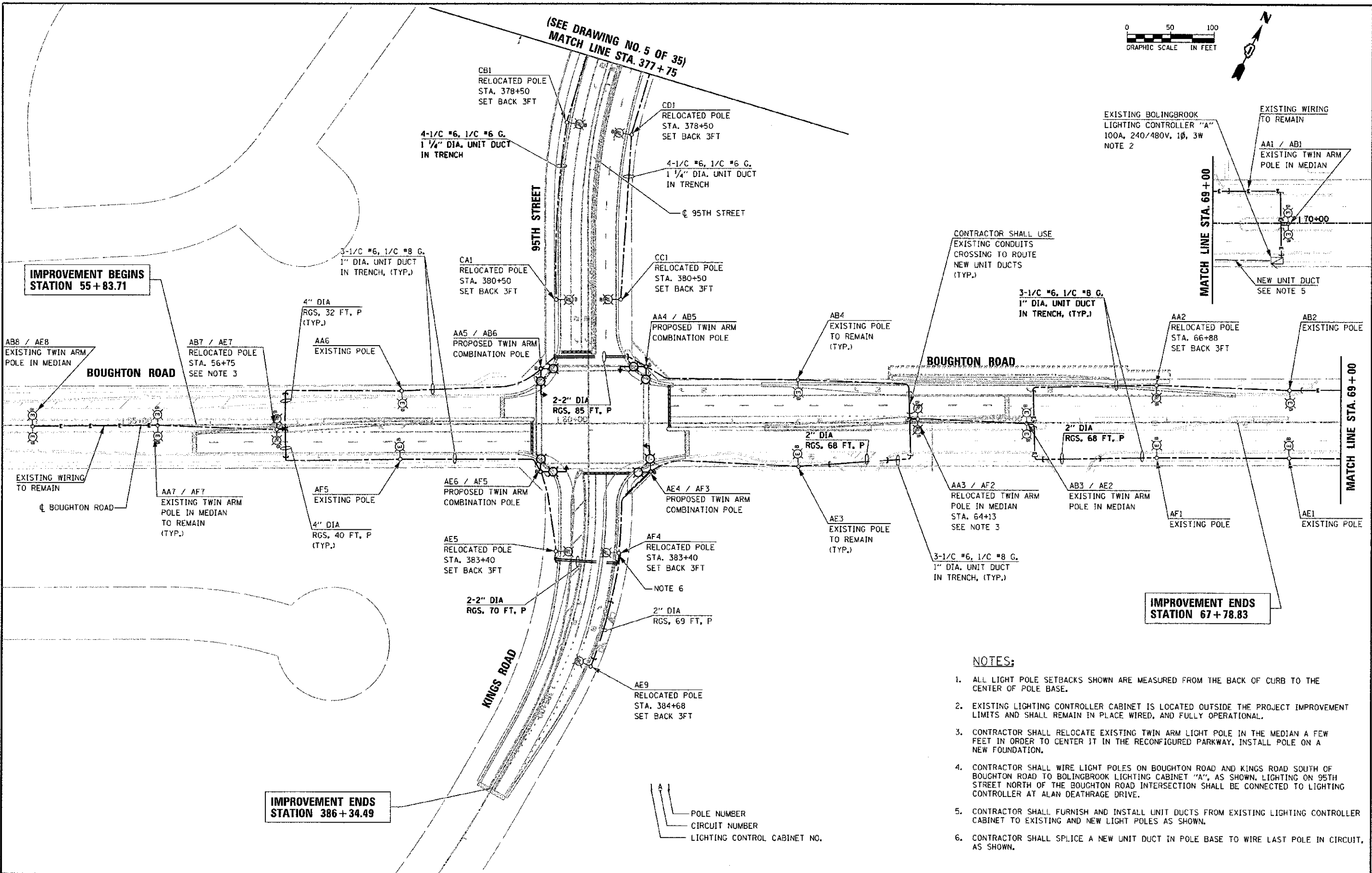

EXISTING BOLINGBROOK LIGHTING CONTROLLER "A"  
100A, 240/480V, 1Ø, 3W  
NOTE 2

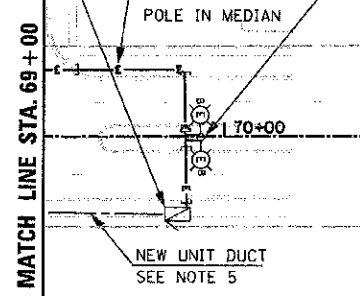

CONTRACTOR SHALL USE EXISTING CONDUITS CROSSING TO ROUTE NEW UNIT DUCTS (TYP.)

IMPROVEMENT ENDS STATION 67+78.83

**NOTES:**

- ALL LIGHT POLE SETBACKS SHOWN ARE MEASURED FROM THE BACK OF CURB TO THE CENTER OF POLE BASE.
- EXISTING LIGHTING CONTROLLER CABINET IS LOCATED OUTSIDE THE PROJECT IMPROVEMENT LIMITS AND SHALL REMAIN IN PLACE WIRED, AND FULLY OPERATIONAL.
- CONTRACTOR SHALL RELOCATE EXISTING TWIN ARM LIGHT POLE IN THE MEDIAN A FEW FEET IN ORDER TO CENTER IT IN THE RECONFIGURED PARKWAY. INSTALL POLE ON A NEW FOUNDATION.
- CONTRACTOR SHALL WIRE LIGHT POLES ON BOUGHTON ROAD AND KINGS ROAD SOUTH OF BOUGHTON ROAD TO BOLINGBROOK LIGHTING CABINET "A", AS SHOWN. LIGHTING ON 95TH STREET NORTH OF THE BOUGHTON ROAD INTERSECTION SHALL BE CONNECTED TO LIGHTING CONTROLLER AT ALAN DEATHRAGE DRIVE.
- CONTRACTOR SHALL FURNISH AND INSTALL UNIT DUCTS FROM EXISTING LIGHTING CONTROLLER CABINET TO EXISTING AND NEW LIGHT POLES AS SHOWN.
- CONTRACTOR SHALL SPLICE A NEW UNIT DUCT IN POLE BASE TO WIRE LAST POLE IN CIRCUIT, AS SHOWN.

POLE NUMBER  
CIRCUIT NUMBER  
LIGHTING CONTROL CABINET NO.

**URS**  
100 S. WACKER DR.  
SUITE 500  
CHICAGO, IL 60606  
TEL (312) 539-1000  
FAX (312) 539-4938

USER NAME: j\_paulo\_push  
DESIGNED: MAE  
DRAWN: MAE  
CHECKED: DAD  
DATE: 2/1/2012

REVISIONS:  
REVISED: -  
REVISED: -  
REVISED: -  
REVISED: -

STATE OF ILLINOIS  
DEPARTMENT OF TRANSPORTATION

95TH STREET  
PROPOSED LIGHTING PLAN (SHEET 4 OF 4)  
SCALE: 1"=50'  
DRAWING NO. 6 OF 30  
STA. 377+75 TO STA. 386+34.49

F.A.I. RTE. 1644	SECTION 01-001B1-00-PP	COUNTY WILL	TOTAL SHEETS 328	SHEET NO. 134
CONTRACT NO. 63647				ILLINOIS FED. AID PROJECT

FILE NAME: c:\projects\25367381\95th\drawing\95th\roadway\lighting\04-18-12.dwg