

NOTES:

1. THE CONTRACTOR SHALL MAINTAIN THE EXISTING LIGHTING EQUIPMENT IN A FULLY OPERATIONAL STATE ON THE TRAFFIC SIDE OF THE ROADWAY. THE CONTRACTOR SHALL REWIRE EXISTING LIGHTING CIRCUITS, AS NECESSARY, TO KEEP THE LIGHT POLES OPERATIONAL DURING CONSTRUCTION. THE CONTRACTOR SHALL PROVIDE AND INSTALL ANY EQUIPMENT, MATERIALS, AND LABOR NECESSARY TO ACCOMPLISH THIS GOAL INCLUDING WOOD POLES, TEMPORARY WIRING (UNDERGROUND AND AERIAL) OF POLES, LUMINAIRES AND LIGHTING CONTROLLERS.
2. ALL LIGHTING RELATED EQUIPMENT, MATERIALS AND LABOR FURNISHED AND INSTALLED BY THE CONTRACTOR DURING CONSTRUCTION TO MAINTAIN THE OPERATION OF THE EXISTING LIGHTING SYSTEM SHALL BE PAID FOR UNDER PAY ITEM "MAINTAIN EXISTING LIGHTING SYSTEM". THIS PAYMENT SHALL INCLUDE ALL MATERIALS AND EQUIPMENT NOT SPECIFICALLY SHOWN ON THE PLANS, BUT ARE NECESSARY TO MAINTAIN THE OPERATION OF THE LIGHTING SYSTEM DURING CONSTRUCTION.
3. EXISTING VILLAGE OF BOLINGBROOK LIGHTING CONTROLLER CABINET "C" FEEDING EXISTING LIGHT POLES ON 95TH STREET BETWEEN ALAN DEATHRAGE DRIVE AND BOUGHTON ROAD. LIGHTING CABINET IS IN CONFLICT WITH PROPOSED BIKE PATH. CABINET SHALL REMAIN OPERATIONAL DURING CONSTRUCTION. CABINET CAN BE RELOCATED AT ANY TIME AS LONG AS IT CAN REMAIN OPERATIONAL AT NIGHT TIME TO POWER THE EXISTING LIGHTS.
4. FURNISH AND INSTALL AERIAL CABLES AND WOOD POLES TO SUPPORT CABLES IF PERMANENT UNDERGROUND WIRING CANNOT BE INSTALLED IN THIS STAGE, OR EXISTING WIRING CANNOT BE MAINTAINED DURING CONSTRUCTION. NUMBER AND LOCATIONS OF TEMPORARY WOOD POLES AND AERIAL WIRING IS SHOWN AS AN EXAMPLE ONLY, AND ARE NOT LIMITED TO WHAT IS SHOWN ON THESE PLANS. PAYMENT FOR THIS WORK SHALL BE AS DESCRIBED IN NOTE 2 ABOVE.

SPECIAL NOTE:

NEW LIGHT POLES AND CONTROLLERS PROPOSED IN THE NEW SECTION OF 95TH STREET DO NOT NEED TO BE OPERATIONAL UNTIL THE ROADWAY IS OPEN TO TRAFFIC.

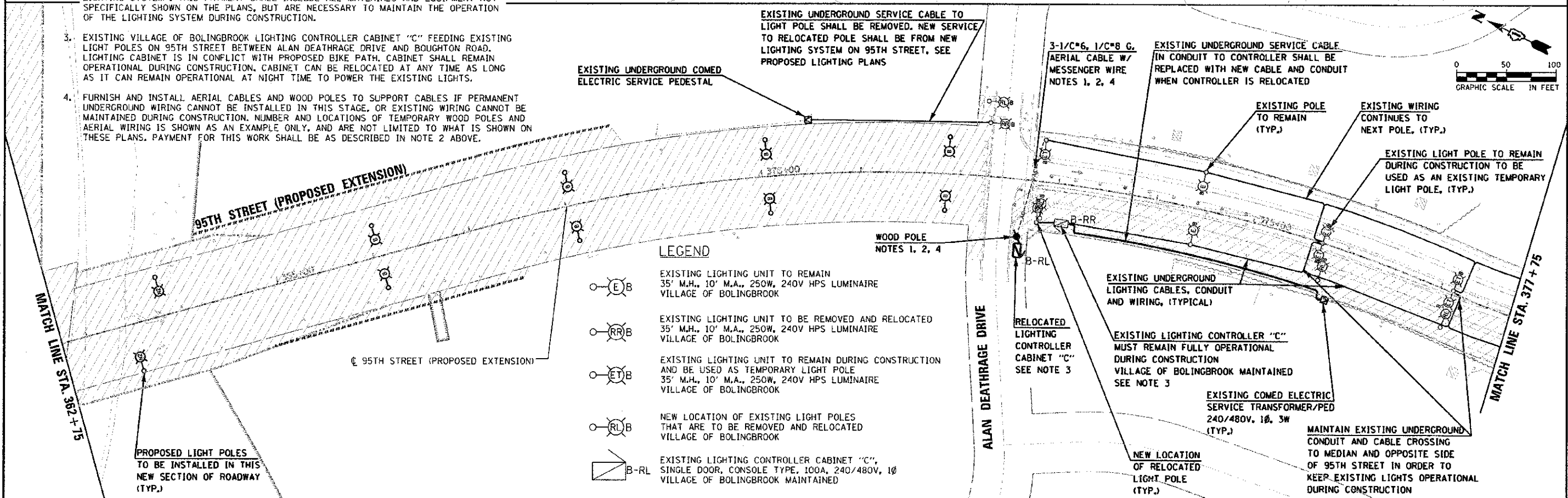

EXISTING UNDERGROUND COMED ELECTRIC SERVICE PEDESTAL

EXISTING UNDERGROUND SERVICE CABLE TO LIGHT POLE SHALL BE REMOVED. NEW SERVICE TO RELOCATED POLE SHALL BE FROM NEW LIGHTING SYSTEM ON 95TH STREET, SEE PROPOSED LIGHTING PLANS

3-1/2" C*6, 1/2" C*8 G. AERIAL CABLE W/ MESSENGER WIRE NOTES 1, 2, 4

EXISTING UNDERGROUND SERVICE CABLE (IN CONDUIT TO CONTROLLER SHALL BE REPLACED WITH NEW CABLE AND CONDUIT WHEN CONTROLLER IS RELOCATED)

EXISTING POLE TO REMAIN (TYP.)

EXISTING WIRING CONTINUES TO NEXT POLE, (TYP.)

EXISTING LIGHT POLE TO REMAIN DURING CONSTRUCTION TO BE USED AS AN EXISTING TEMPORARY LIGHT POLE, (TYP.)

LEGEND

- EXISTING LIGHTING UNIT TO REMAIN 35' M.H., 10' M.A., 250W, 240V HPS LUMINAIRE VILLAGE OF BOLINGBROOK
- EXISTING LIGHTING UNIT TO BE REMOVED AND RELOCATED 35' M.H., 10' M.A., 250W, 240V HPS LUMINAIRE VILLAGE OF BOLINGBROOK
- EXISTING LIGHTING UNIT TO REMAIN DURING CONSTRUCTION AND BE USED AS TEMPORARY LIGHT POLE 35' M.H., 10' M.A., 250W, 240V HPS LUMINAIRE VILLAGE OF BOLINGBROOK
- NEW LOCATION OF EXISTING LIGHT POLES THAT ARE TO BE REMOVED AND RELOCATED VILLAGE OF BOLINGBROOK
- EXISTING LIGHTING CONTROLLER CABINET "C", SINGLE DOOR, CONSOLE TYPE, 100A, 240/480V, 1Ø VILLAGE OF BOLINGBROOK MAINTAINED

WOOD POLE NOTES 1, 2, 4

RELOCATED LIGHTING CONTROLLER CABINET "C" SEE NOTE 3

EXISTING UNDERGROUND LIGHTING CABLES, CONDUIT AND WIRING, (TYPICAL)

EXISTING LIGHTING CONTROLLER "C" MUST REMAIN FULLY OPERATIONAL DURING CONSTRUCTION VILLAGE OF BOLINGBROOK MAINTAINED SEE NOTE 3

EXISTING COMED ELECTRIC SERVICE TRANSFORMER/PED 240/480V, 1Ø, 3W (TYP.)

MAINTAIN EXISTING UNDERGROUND CONDUIT AND CABLE CROSSING TO MEDIAN AND OPPOSITE SIDE OF 95TH STREET IN ORDER TO KEEP EXISTING LIGHTS OPERATIONAL DURING CONSTRUCTION

100 S. WACKER DR. SUITE 500 CHICAGO, IL 60606 TEL (312) 939-1000 FAX (312) 939-4198	USER NAME - jcw/ps/plp DESIGNED - MAE DRAWN - MAE CHECKED - DAD DATE - 2/1/2012	REVISED - REVISED - REVISED - REVISED -	STATE OF ILLINOIS DEPARTMENT OF TRANSPORTATION		95TH STREET TEMPORARY LIGHTING PLAN - STAGE 1 (SHEET 3 OF 4)		F.A.J. RTE. 1644 SECTION 01-00181-00-PP COUNTY WILL TOTAL SHEETS 328 SHEET NO. 141 CONTRACT NO. 63647
	PLOT SCALE = 5/8" = 1' IN. PLOT DATE = 08/16/2012	SCALE: 1" = 50' DRAWING NO. 13 OF 30 STA. 348+25 TO STA. 377+75		ILLINOIS FED. AID PROJECT			