

COUNTY HIGHWAY	FISCAL YEAR	SHEET NO.	TOTAL SHEETS
BTO	2003		

SECTION: 02-BT021-03-CH

- NOTES:**
- THE EXACT LOCATIONS OF ALL UTILITIES SHALL BE FIELD VERIFIED BY THE CONTRACTOR BEFORE THE INSTALLATION OF ANY COMPONENTS OF THE TRAFFIC SIGNAL SYSTEM. FOR EXACT LOCATIONS OF THE UTILITIES, CALL J.M.A.I.E. TOLL FREE AT (800) 892-0123.
  - VEHICLE LOOP DETECTOR SHALL BE COMPATIBLE WITH THE CONTROL EQUIPMENT.
  - ALL ELECTRICAL CABLE SHALL HAVE POLYVINYL JACKET.
  - THE CONTRACTOR SHALL INFORM THE CCHD DESIGN ENGINEER AT (312) 603-1730 PRIOR TO THE START OF ANY WORK ON THE CONTRACT. A MINIMUM OF FIVE (5) WORKING DAYS ADVANCE NOTICE IS REQUIRED.
  - THE CONTRACTOR SHALL MARK THE LOCATIONS OF ALL DETECTOR LOOPS AND CONTACT THE CCHD DESIGN ENGINEER AT (312) 603-1730 FOR LOCATION APPROVAL PRIOR TO THE CUTTING OF THE LOOPS. A MINIMUM OF FIVE (5) WORKING DAYS ADVANCE NOTICE IS REQUIRED.
  - ALL SIGNAL POSTS SHALL BE SET BACK FOUR (4) FEET MINIMUM AND ALL MAST ARM POLES SHALL BE SET BACK SIX (6) FEET MINIMUM FROM THEIR CENTERLINE TO THE BACK OF CURB UNLESS OTHERWISE NOTED. IN NON-CURBED AREAS THE MAST ARM POLE AND SIGNAL POST SHALL BE LOCATED A MINIMUM OF TEN (10) FEET BEHIND THE EDGE OF PAVEMENT OR TWO (2) FEET BEHIND THE EDGE OF SHOULDER, WHICHEVER DISTANCE IS GREATER.
  - CONDUIT UNDER ROADWAYS AND DRIVEWAYS TO BE PLACED IN TRENCH BEFORE PAVEMENT IS PLACED.
  - ALL MAST ARM MOUNTED SIGNAL HEADS ARE TO BE ATTACHED TWO (2) FEET FROM THE END OF THE MAST ARM UNLESS OTHERWISE NOTED.
  - ALL 1" CONDUIT TO BE 1" EMPTY DUCT.
  - THE CORNERS OF ALL NEW DETECTOR LOOPS SHALL BE CORE DRILLED INCLUDING PAVEMENT JOINTS AND CRACKS.
  - IT IS THE CONTRACTOR'S RESPONSIBILITY TO LOCATE THE EXISTING STREET LIGHTING CONDUITS AND CABLES. THIS SHALL BE CONSIDERED INCIDENTAL TO THE CONTRACT.
  - STREET LIGHTS SHALL BE RELOCATED BEFORE ANY PAVEMENT WORK BEGINS AND BE MAINTAINED UNDER THE CONTRACTOR UNTIL THE ROAD WORK IS COMPLETED.
  - THE EXISTING STREET LIGHTINGS ARE MAINTAINED BY THE VILLAGE. THE CONTRACTOR SHALL CONTACT THE VILLAGE FOR DETAIL INFORMATION.
  - ALL NEW DETECTOR LOOPS SHALL BE PUT ON TOP OF THE EXISTING CONCRETE BASE.
  - STREET LIGHTING CONDUIT AND CABLE TO BE PAID FOR UNDER "RELOCATE EXISTING LIGHT STANDARD AND LUMINAIRE IN PLACE".

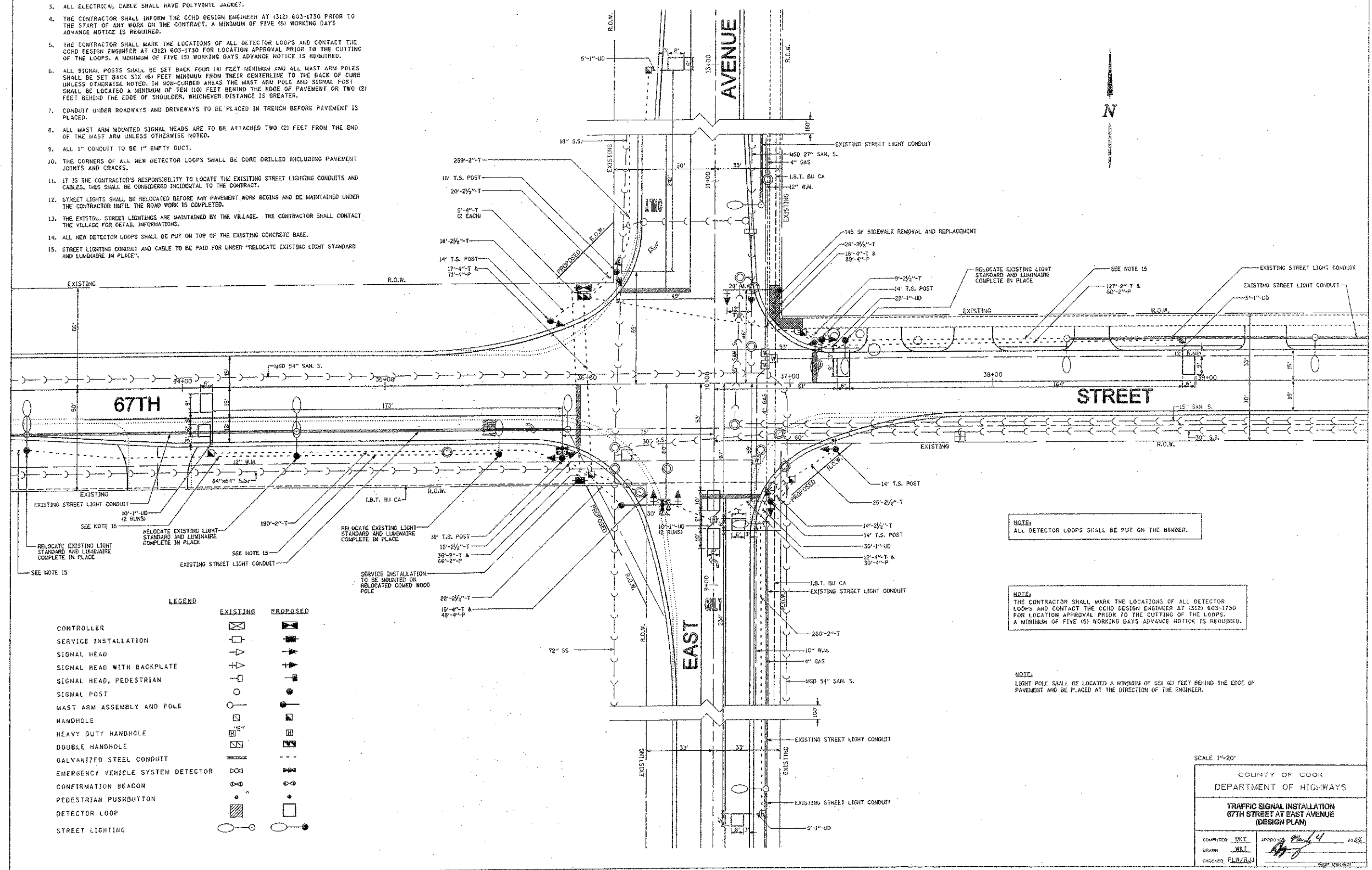

**LEGEND**

	EXISTING	PROPOSED
CONTROLLER	[Symbol]	[Symbol]
SERVICE INSTALLATION	[Symbol]	[Symbol]
SIGNAL HEAD	[Symbol]	[Symbol]
SIGNAL HEAD WITH BACKPLATE	[Symbol]	[Symbol]
SIGNAL HEAD, PEDESTRIAN	[Symbol]	[Symbol]
SIGNAL POST	[Symbol]	[Symbol]
MAST ARM ASSEMBLY AND POLE	[Symbol]	[Symbol]
HANDHOLE	[Symbol]	[Symbol]
HEAVY DUTY HANDHOLE	[Symbol]	[Symbol]
DOUBLE HANDHOLE	[Symbol]	[Symbol]
GALVANIZED STEEL CONDUIT	[Symbol]	[Symbol]
EMERGENCY VEHICLE SYSTEM DETECTOR	[Symbol]	[Symbol]
CONFIRMATION BEACON	[Symbol]	[Symbol]
PEDESTRIAN PUSHBUTTON	[Symbol]	[Symbol]
DETECTOR LOOP	[Symbol]	[Symbol]
STREET LIGHTING	[Symbol]	[Symbol]

- NOTE:**  
ALL DETECTOR LOOPS SHALL BE PUT ON THE BINDER.
- NOTE:**  
THE CONTRACTOR SHALL MARK THE LOCATIONS OF ALL DETECTOR LOOPS AND CONTACT THE CCHD DESIGN ENGINEER AT (312) 603-1730 FOR LOCATION APPROVAL PRIOR TO THE CUTTING OF THE LOOPS. A MINIMUM OF FIVE (5) WORKING DAYS ADVANCE NOTICE IS REQUIRED.
- NOTE:**  
LIGHT POLE SHALL BE LOCATED A MINIMUM OF SIX (6) FEET BEHIND THE EDGE OF PAVEMENT AND BE PLACED AT THE DIRECTION OF THE ENGINEER.

SCALE 1"=20'

COUNTY OF COOK	
DEPARTMENT OF HIGHWAYS	
TRAFFIC SIGNAL INSTALLATION 67TH STREET AT EAST AVENUE (DESIGN PLAN)	
COMPUTED BY: [Signature]	APPROVED BY: [Signature]
DRAWN BY: [Signature]	CHECKED BY: [Signature]

FILE NAME: VILLAGE OF HODGKINS EAST AVENUE 67TH ST. TO JOLIET RD.	USER NAME: [Blank]	DESIGNED: THK	REVISED: [Blank]	STATE OF ILLINOIS DEPARTMENT OF TRANSPORTATION	EXISTING TRAFFIC SIGNAL DESIGN DETAILS - EAST AVENUE AND 67TH STREET (FOR INFORMATION ONLY)	PLAN: 2719	SECTION: 11-00019-00-RS	COUNTY: COOK	TOTAL SHEETS: 29	SHEET NO.: 14
RESURFACING	PLT SCALE: [Blank]	DRAWN: J.C.	REVISED: [Blank]			SCALE: N.T.S.	SHEET NO. OF SHEETS: [Blank]	FED. ROAD DIST. NO.:	ILLINOIS FED. AID PROJ. NO.:	M-9003 (R&B)
	PLT DATE: [Blank]	CHECKED: J.C.	REVISED: [Blank]							
		DATE: 4/12	REVISED: [Blank]							

**Frank Novotny & Associates, Inc.**  
 805 Midway Drive • Wheeling, IL • 60091 • Telephone: (815) 857-8600 • Fax: (815) 857-0130  
 ILLINOIS PROFESSIONAL DESIGN FIRM NO. 184-000028