

PLAN	DATE
REVISIONS	BY
NOTE BOOK	ALIGNED CHECKED
NO.	NO.
	FILE NAME

PROFILE	DATE
REVISIONS	BY
NOTE BOOK	GRADES CHECKED
NO.	NO.
	FILE NAME

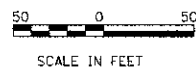
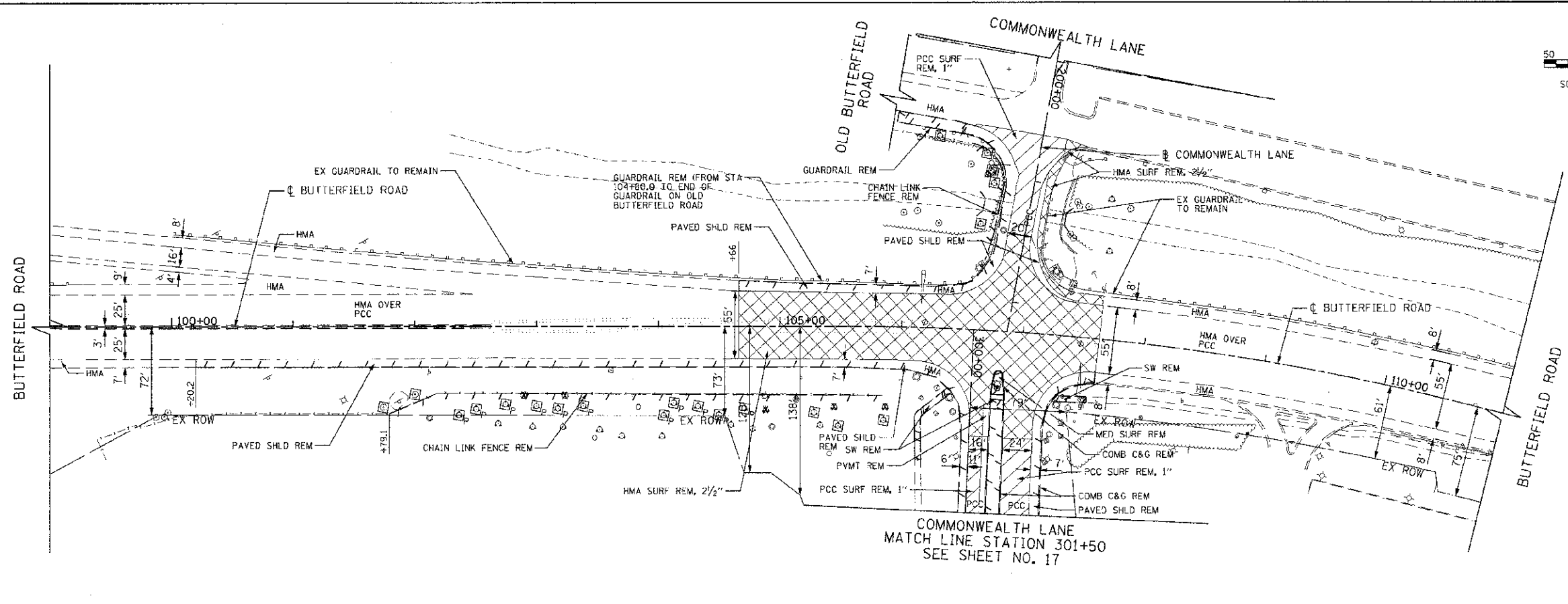

LEGEND

	HMA SURF REM, 2 1/2"
	PCC SURF REM, 1"
	REMOVAL LIMITS (PVT, SHLD, SW, C&G, FENCE AND MEDIANS)
	TREE TRUNK PROTECTION
	TREE PRUNING AND TREE ROOT PRUNING
	TREE REMOVAL

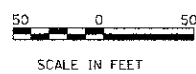
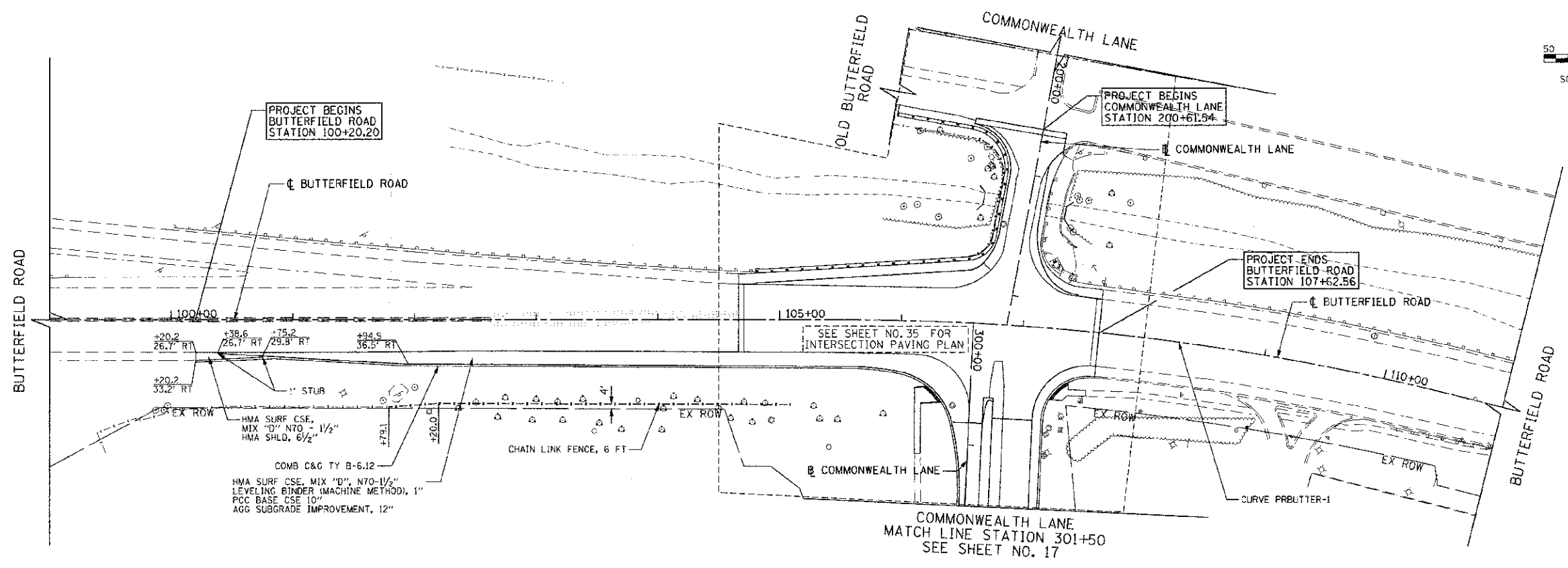

EX CURVE PRBUTTER-1
 PI STA. = 108+08.84
 $\Delta = 14^{\circ} 04' 08''$ (RT)
 $D = 2^{\circ} 46' 04''$
 $R = 2,070.00'$
 $T = 255.43'$
 $L = 508.29'$
 $E = 15.70'$
 $\theta =$ MATCH EXISTING
 T.R. = MATCH EXISTING
 S.E. RUN = MATCH EXISTING
 P.C. STA. = 105+53.41
 P.T. STA. = 110+61.70

- NOTES:**
- FOR PROPOSED RIGHT-OF-WAY INFORMATION, SEE PLAT OF HIGHWAY SHEETS NO. 30 TO 34.
 - FOR PROFILE INFORMATION, SEE ROADWAY PROFILE SHEET NO. 18 AND INTERSECTION PAVING PLAN SHEET NO. 35.
 - PROPOSED PAVEMENT SECTION CONSISTS OF: HMA SURFACE COURSE, MIX "D" N50 - 1 1/2", LEVELING BINDER (MACHINE METHOD) N50 - DEPTH VARIES OR HMA BINDER COURSE, IL-19.0 N50 - DEPTH VARIES FOR BINDER DEPTHS, SEE SHEET NO. 36.
 - A QUANTITY FOR CLASS D PATCHES, TYPE 1, 8" AND CLASS D PATCHES, TYPE II, 8" IS INCLUDED IN THE PLANS. THE ENGINEER SHALL APPROVE THE LOCATIONS OF PAVEMENT PATCHING PRIOR TO PLACEMENT.

FILE NAME =	USER NAME = tkendall	DESIGNED - TKS	REVISED -	STATE OF ILLINOIS DEPARTMENT OF TRANSPORTATION	BUTTERFIELD ROAD AT COMMONWEALTH LANE REMOVAL PLAN AND ROADWAY PLAN	F.A.U. RTE.	SECTION	COUNTY	TOTAL SHEETS	
g:\ah85\0028\road\sheet\DI\0028-SHT-Plan.dgn		DRAWN - TKS	REVISED -			3545	09-00170-00-CH	DUPAGE	108	16
PLOT SCALE = 600.0000 Ft / Ft.		CHECKED - JMG	REVISED -			SCALE: 1"=50' SHEET NO. 16 OF 108 SHEETS STA. 99+00 TO STA. 111+00				
PLOT DATE = 10/21/2012		DATE = 10/22/2012	REVISED -			FED. ROAD DIST. NO. 7 ILLINOIS FED. AID PROJECT CONTRACT NO. 63742				