

DATE	BY
DESIGNED	TKS
DRAWN	TKS
CHECKED	JMC
DATE	10/22/2012

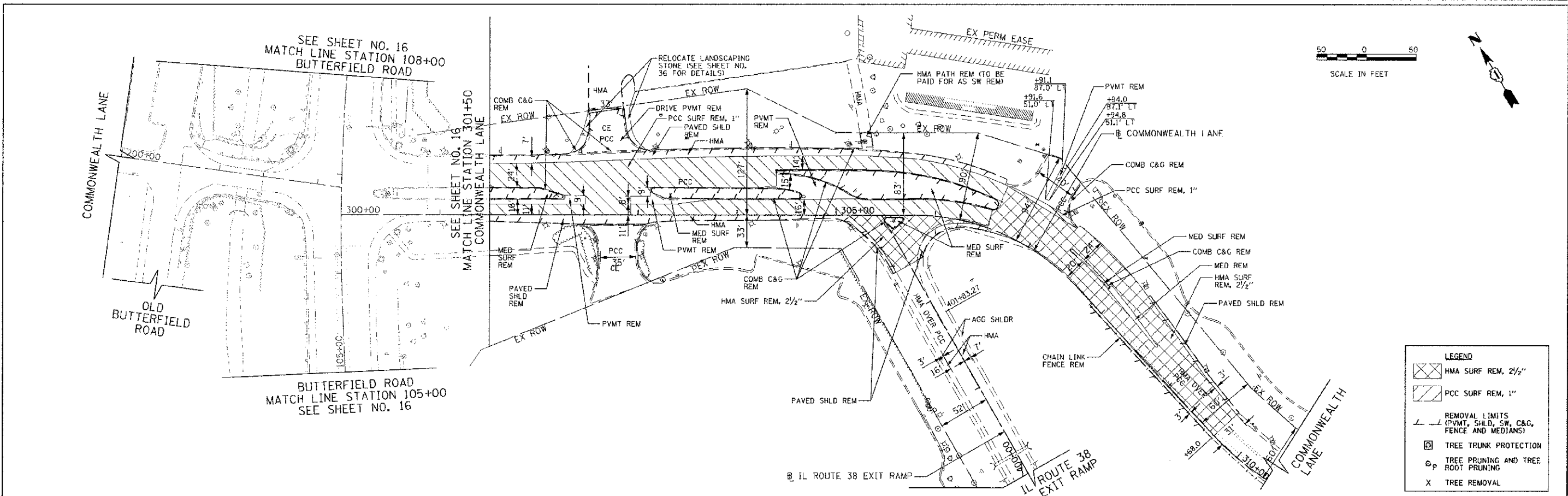

DATE	BY
DESIGNED	TKS
DRAWN	TKS
CHECKED	JMC
DATE	10/22/2012

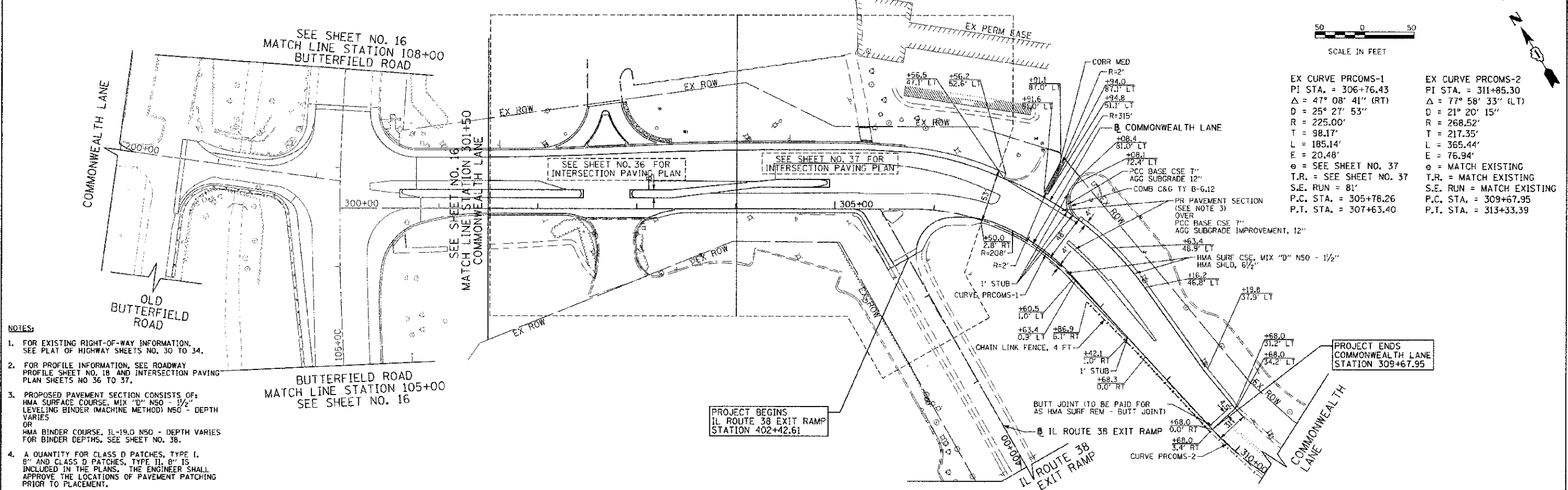

- NOTES:
- FOR EXISTING RIGHT-OF-WAY INFORMATION, SEE PLAT OF HIGHWAY SHEETS NO. 30 TO 34.
 - FOR PROFILE INFORMATION, SEE ROADWAY PROFILE SHEET NO. 18 AND INTERSECTION PAVING PLAN SHEETS NO 36 TO 37.
 - PROPOSED PAVEMENT SECTION CONSISTS OF:
HMA SURFACE COURSE, MIX "D" NSO - 1 1/2" LEVELING BINDER (MACHINE METHOD) NSO - DEPTH VARIES
OR
HMA BINDER COURSE, IL-19.0 NSO - DEPTH VARIES FOR BINDER DEPTHS, SEE SHEET NO. 38.
 - A QUANTITY FOR CLASS D PATCHES, TYPE I, 6" AND CLASS D PATCHES, TYPE II, 8" IS INCLUDED IN THE PLANS. THE ENGINEER SHALL APPROVE THE LOCATIONS OF PAVEMENT PATCHING PRIOR TO PLACEMENT.

FILE NAME -	USER NAME = kalorenz	DESIGNED - TKS	REVISED -	STATE OF ILLINOIS DEPARTMENT OF TRANSPORTATION	BUTTERFIELD ROAD AT COMMONWEALTH LANE REMOVAL PLAN AND ROADWAY PLAN	F.A.U.:	SECTION	COUNTY	TOTAL SHEETS	SHEET NO.	
GA:\CH08\0808\Road\Phase 2\Sheets\11X0808	SHT-Plan2.dgn	DRAWN - TKS	REVISED -			3545	09-00170-00-CH	DUPAGE	108	17	
PLOT SCALE = 50.0000 ft / in.	DATE = 12/4/2012	CHECKED - JMC	REVISED -			CONTRACT NO. 63742					
PLOT DATE = 12/4/2012	DATE = 10/22/2012	REVISED -	REVISED -			FED. ROAD DIST. NO. 7 ILLINOIS FED. AID PROJECT					