

DATE	BY
DESIGNED	TKH
CHECKED	JMG
DATE	10/22/2012

DATE	BY
DESIGNED	TKH
CHECKED	JMG
DATE	10/22/2012

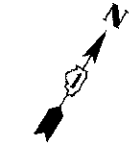
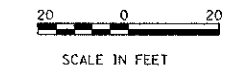
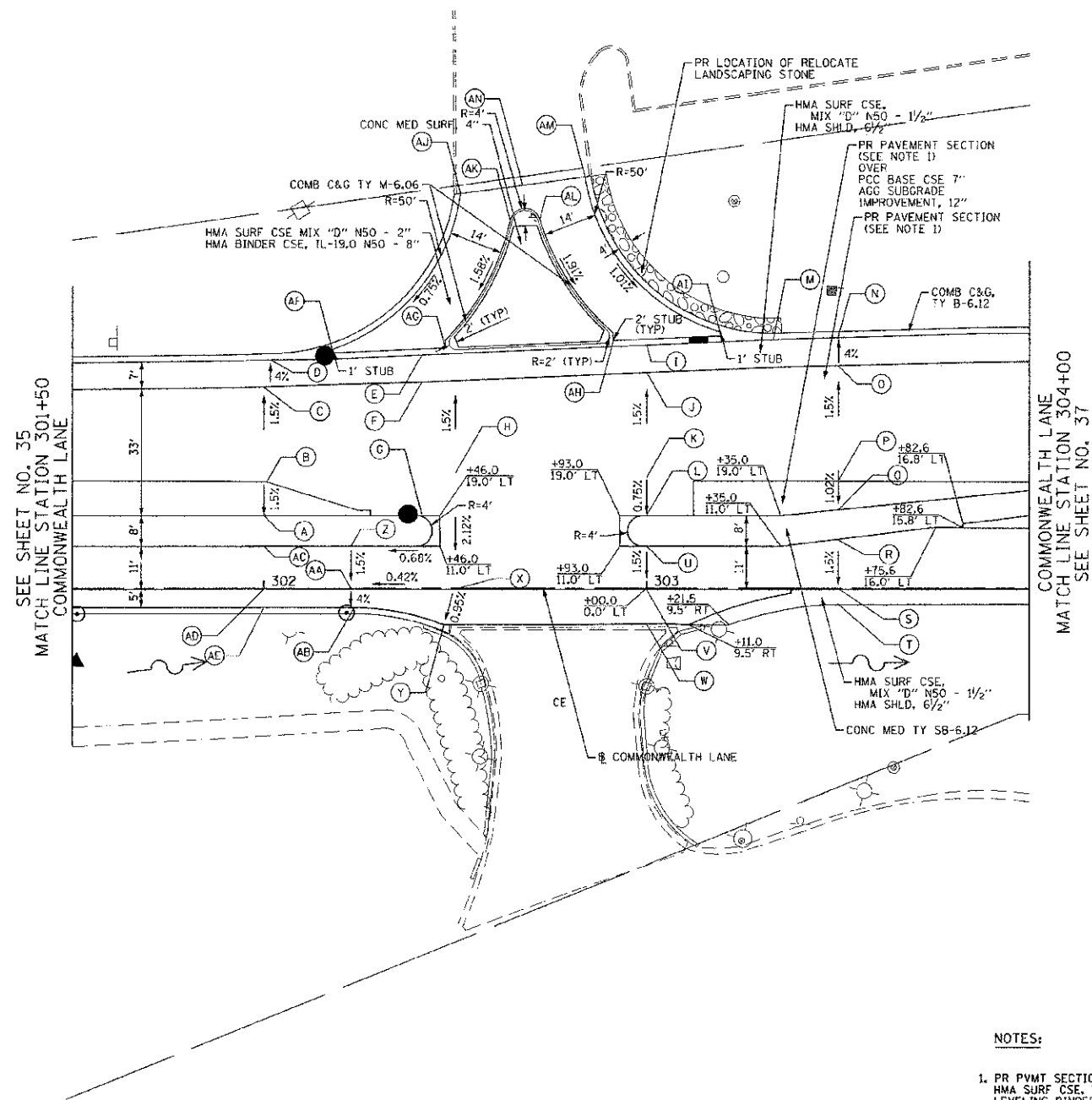

	STATION	OFFSET	ELEVATION
A	302+00.0	19.0' LT	664.55
B	302+00.0	30.0' LT	664.72
C	302+00.0	52.7' LT	664.38
D	302+00.0	39.7' LT	664.09
E	302+50.0	61.3' LT	663.95
F	302+50.0	54.2' LT	664.23
G	302+40.0	19.0' LT	664.45
H	302+50.0	30.0' LT	664.59
I	303+00.0	63.5' LT	663.78
J	303+00.0	56.4' LT	664.07
K	303+00.0	30.0' LT	664.47
L	303+00.0	19.0' LT	664.39
M	303+33.1	64.9' LT	663.69
N	303+50.0	65.5' LT	663.64
O	303+50.0	58.2' LT	663.93
P	303+50.0	30.0' LT	664.35
Q	303+50.0	20.5' LT	664.25
R	303+50.0	12.8' LT	663.65
S	303+50.0	0.3' RT	663.47
T	303+50.0	4.3' RT	663.31
U	303+00.0	11.0' LT	664.00
V	303+00.0	0.2' RT	663.84
W	303+00.0	9.2' RT	663.75
X	302+50.0	0.2' RT	664.02
Y	302+47.1	9.5' RT	663.93
Z	302+23.7	11.0' LT	664.07
AA	302+23.7	0.2' RT	663.91
AB	302+23.7	5.0' RT	663.71
AC	302+00.0	11.0' LT	664.16
AD	302+00.0	0.1' RT	664.00
AE	302+00.0	5.0' RT	663.80
AF	302+18.1	61.5' LT	664.10
AG	302+47.4	62.8' LT	664.00
AH	302+91.3	64.7' LT	663.88
AI	303+19.4	65.9' LT	663.80
AJ	302+51.3	103.1' LT	664.52
AK	302+64.3	96.1' LT	664.60
AL	302+72.0	96.4' LT	664.60
AM	302+83.8	107.4' LT	664.43
AN	302+67.5	105.2' LT	664.55

NOTES:

- PR PAVT SECTION CONSISTS OF:
 HMA SURF CSE, MIX "D" N50 - 1 1/2"
 LEVELING BINDER (MACHINE METHOD) N50 - DEPTH VARIES
 OR
 HMA BINDER CSE, IL-19.0 N50 - DEPTH VARIES
 FOR BINDER DEPTHS, SEE SHEET NO. 38
- A QUANTITY FOR CLASS D PATCHES, TYPE I, 8" AND CLASS D PATCHES, TYPE II, 8" IS INCLUDED IN THE PLANS. THE ENGINEER SHALL APPROVE THE LOCATIONS OF PAVEMENT PATCHING PRIOR TO PLACEMENT.

FILE NAME =	USER NAME = khalorenz	DESIGNED = TKH	REVISED =	STATE OF ILLINOIS DEPARTMENT OF TRANSPORTATION	BUTTERFIELD ROAD AT COMMONWEALTH LANE INTERSECTION PAVING PLAN		F.A.J. RTE. = 3545	SECTION = 09-00170-00-CH	COUNTY = DUPAGE	TOTAL SHEETS = 108	SHEET NO. = 36
CONTRACT NO. = 63742	SCALE = 1"=20'	SHEET NO. = 36 OF 108 SHEETS	STA. 301+50 TO STA. 304+00		FED. ROAD DIST. NO. 7 ILLINOIS FED. AID PROJECT						
CONTRACT NO. = 63742											