

DEMOLITION PLAN NOTES

1. ALL FIRE HYDRANTS SHOWN SHALL BE PROTECTED DURING CONSTRUCTION.
2. CONTRACTOR SHALL PROVIDE AND MAINTAIN POSITIVE DRAINAGE AWAY FROM THE PROPOSED AGGREGATE SUBGRADE DURING CONSTRUCTION. THIS WORK IS CONSIDERED INCLUDED IN THE COST OF THE CONTRACT.

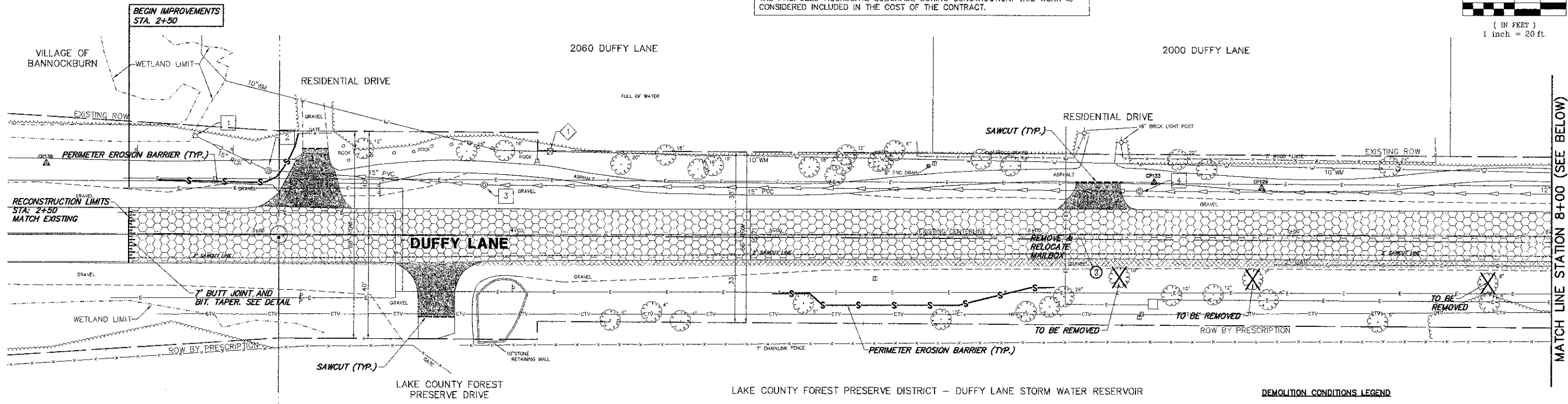
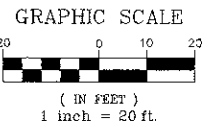

DEMOLITION CONDITIONS LEGEND

HOT-MIX ASPHALT SURFACE REMOVAL, 2 1/2"	
DRIVEWAY PAVEMENT REMOVAL	
BRICK DRIVEWAY REMOVAL & REPLACEMENT (SPECIAL)	
EARTH EXCAVATION	
STORM STRUCTURE TO BE REMOVED	
TREE TO BE REMOVED	
STORM SEWER TO BE REMOVED	
PERIMETER EROSION BARRIER	

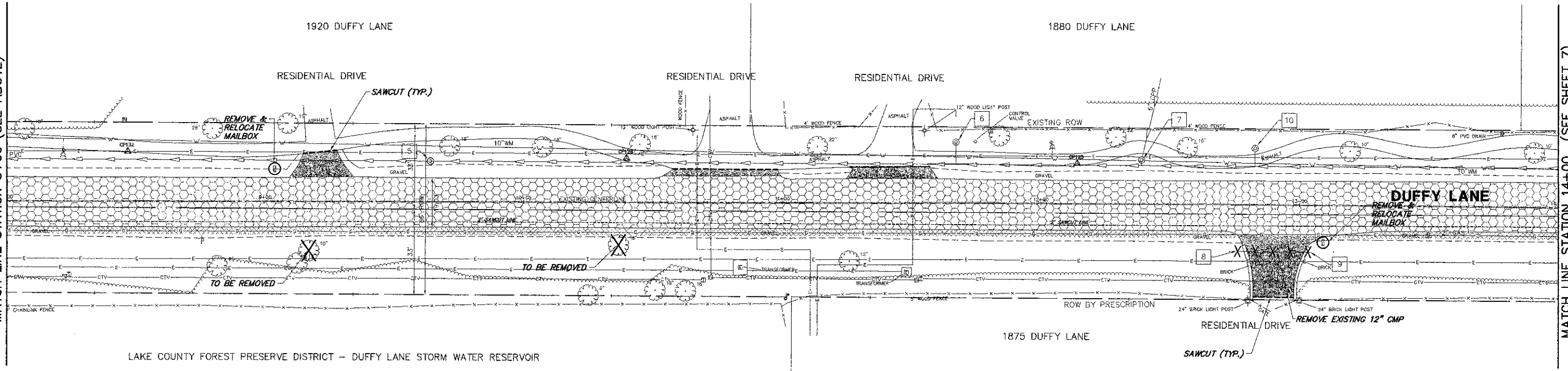

MATCH LINE STATION 8+00 (SEE ABOVE)

MATCH LINE STATION 14+00 (SEE SHEET 7)

FILE NAME = 8101-057 PRB.dwg	USER NAME = GW3	DESIGNED = DJG	REVISED =	STATE OF ILLINOIS DEPARTMENT OF TRANSPORTATION	DEMOLITION PLAN		FA RTE = 1254	SECTION = 12-00013-00-RS	COUNTY = LAKE	TOTAL SHEETS = 32	SHEET NO. = 6
	PLOT SCALE = 1:1	CHECKED = DJG	REVISED =		SCALE = 1"=20'	SHEET NO. 6 OF 32 SHEETS	STA. 2+50 TO STA. 14+00	CONTRACT # = 63751		ILLINOIS FED. AID PROJECT M-4003(095)	
	PLOT DATE = 08.10.2012	DATE = 08.10.2012	REVISED =								