

LAKE COUNTY FOREST PRESERVE DISTRICT - DUFFY LANE STORM WATER RESERVOIR

- 5 EX. STORM MANHOLE
RIM: 673.17 INV: 671.27
E 12" INV: 671.17
STA: 9+64 O/S: 15.7'L
- 6 EX. STORM MANHOLE
RIM: 676.58 INV: 675.28
STA: 11+67 O/S: 23.7'L
- 7 EX. STORM MANHOLE
RIM: 677.94 INV: 676.24
N 6" INV: 676.34
STA: 12+39 O/S: 17.1'L
- 8 EX. 12" FLARED END SECTION
INV: 677.32
STA: 12+76 O/S: 17.9'R
TO BE REMOVED
- 10 EX. STORM MANHOLE
RIM: 679.08 INV: 677.53
STA: 12+83 O/S: 21.9'L
- 2 FLARED END SECTION
18" RCP INV: 677.00
STA: 12+75 O/S: 18.7'R
- 30 LF 18" SS, CL. A. TY 2, @ 1.00%

DRAINAGE & UTILITY PLAN LEGEND

- (10) EXISTING SANITARY STRUCTURE
- (10) EXISTING SANITARY SEWER
- (10) EXISTING WATERMAIN STRUCTURE
- (10) EXISTING WATERMAIN
- (10) EXISTING STORM SEWER STRUCTURE
- (10) EXISTING STORM SEWER
- (10) PROPOSED STORM SEWER STRUCTURE
- (10) PROPOSED STORM SEWER
- (10) PROPOSED STORM SEWER PIPE
- (10) PROPOSED STORM SEWER FLARED END SECTION
- (10) PROPOSED STORM SEWER CATCHBASIN
- (10) PROPOSED STORM SEWER INLET
- (X1) PROPOSED UTILITY CROSSING

PLAN & PROFILE LEGEND

- HOT-MIX ASPHALT SURFACE COURSE, MIX "D", N50
- HOT-MIX DRIVEWAY PAVEMENT, 3"
- BRICK DRIVEWAY REMOVAL & REPLACEMENT
- AGGREGATE SHOULDERS (SPECIAL)
- HOT-MIX ASPHALT SURFACE REMOVAL - BUTT JOINT
- PERIMETER EROSION BARRIER

DUFFY LANE

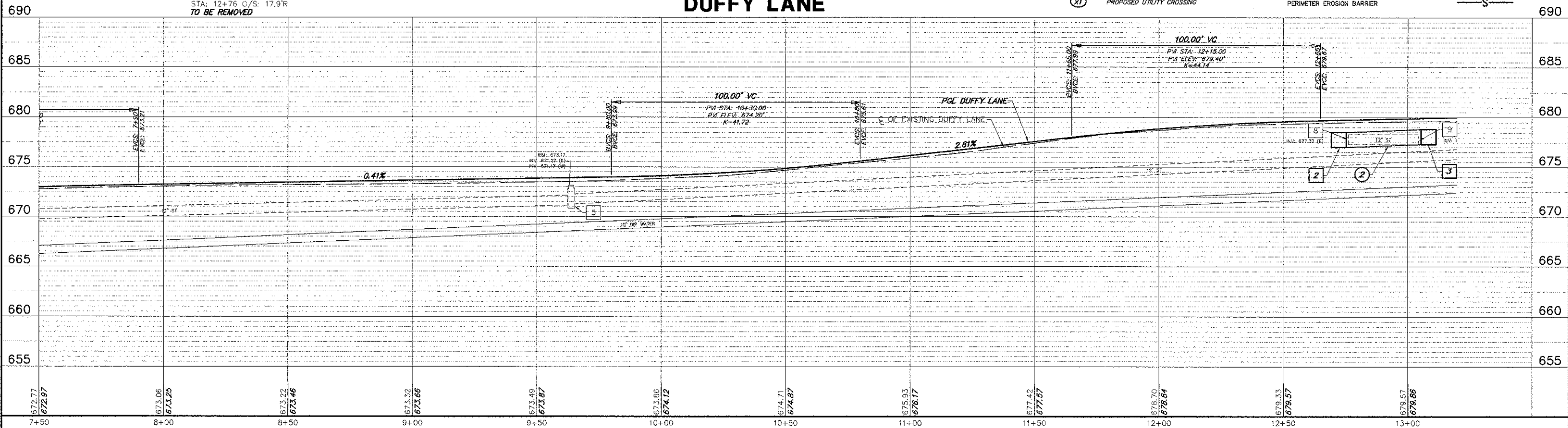

FILE NAME = 8101-057 PR8.dwg	USER NAME = GW3	DESIGNED = DJG	REVISED =	STATE OF ILLINOIS DEPARTMENT OF TRANSPORTATION	PROPOSED PLAN & PROFILE / DRAINAGE AND UTILITIES			FA. RTE. 1254	SECTION 12-00013-00-RS	COUNTY LAKE	TOTAL SHEETS 32	SHEET NO. 10
PLOT SCALE = 1:1	CHECKED = DJG	REVISED =	SCALE: AS NOTED					SHEET NO. 10 OF 32 SHEETS	STA. 7+50 TO STA. 13+00	CONTRACT # 63751	ILLINOIS FED. AID PROJECT M-4003(085)	
PLOT DATE = 08.10.2012	DATE = 08.10.2012	REVISED =										