

MATCH LINE STATION 13+00 (SEE SHEET 10)

MATCH LINE STATION 18+50 (SEE SHEET 12)

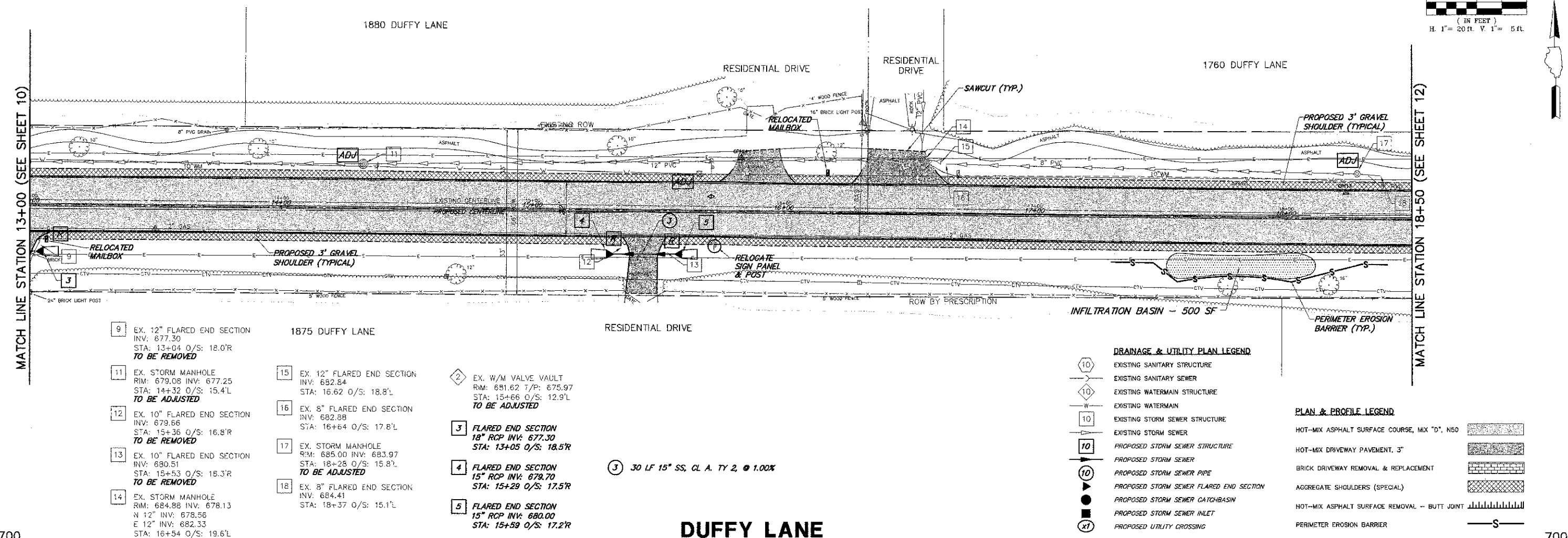

- |   |  |  |  |   |
|---|--|--|--|---|
| 9 EX. 12" FLARED END SECTION<br>INV: 677.30<br>STA: 13+04 O/S: 18.0'R<br><b>TO BE REMOVED</b> | 11 EX. STORM MANHOLE<br>RIM: 679.08 INV: 677.25<br>STA: 14+32 O/S: 15.4'L<br><b>TO BE ADJUSTED</b> | 12 EX. 10" FLARED END SECTION<br>INV: 679.66<br>STA: 15+36 O/S: 16.8'R<br><b>TO BE REMOVED</b>     | 13 EX. 10" FLARED END SECTION<br>INV: 680.51<br>STA: 15+53 O/S: 18.3'R<br><b>TO BE REMOVED</b> | 14 EX. STORM MANHOLE<br>RIM: 684.88 INV: 678.13<br>N 12" INV: 678.56<br>E 12" INV: 682.33<br>STA: 16+54 O/S: 19.6'L |
| 15 EX. 12" FLARED END SECTION<br>INV: 682.84<br>STA: 16+62 O/S: 18.8'L                        | 16 EX. 8" FLARED END SECTION<br>INV: 682.88<br>STA: 16+64 O/S: 17.8'L                              | 17 EX. STORM MANHOLE<br>RIM: 685.00 INV: 683.97<br>STA: 18+28 O/S: 15.8'L<br><b>TO BE ADJUSTED</b> | 18 EX. 8" FLARED END SECTION<br>INV: 684.41<br>STA: 18+37 O/S: 15.1'L                          |   |

- |   |   |   |   |
|---|---|---|---|
| 2 EX. W/M VALVE VAULT<br>RIM: 681.62 T/P: 675.97<br>STA: 15+66 O/S: 12.9'L<br><b>TO BE ADJUSTED</b> | 3 FLARED END SECTION<br>18" RCP INV: 677.30<br>STA: 13+05 O/S: 18.5'R | 4 FLARED END SECTION<br>15" RCP INV: 679.70<br>STA: 15+29 O/S: 17.5'R | 5 FLARED END SECTION<br>15" RCP INV: 680.00<br>STA: 15+59 O/S: 17.2'R |
|---|---|---|---|
- 3 30 LF 15" SS, CL. A. TY 2, @ 1.00%

**DRAINAGE & UTILITY PLAN LEGEND**

- (10) EXISTING SANITARY STRUCTURE
- - - EXISTING SANITARY SEWER
- (10) EXISTING WATERMAIN STRUCTURE
- - - EXISTING WATERMAIN
- (10) EXISTING STORM SEWER STRUCTURE
- - - EXISTING STORM SEWER
- [10] PROPOSED STORM SEWER STRUCTURE
- - - PROPOSED STORM SEWER
- (10) PROPOSED STORM SEWER PIPE
- ▲ PROPOSED STORM SEWER FLARED END SECTION
- PROPOSED STORM SEWER CATCHBASIN
- PROPOSED STORM SEWER INLET
- (X) PROPOSED UTILITY CROSSING

**PLAN & PROFILE LEGEND**

- [Pattern] HOT-MIX ASPHALT SURFACE COURSE, MIX "D", N50
- [Pattern] HOT-MIX DRIVEWAY PAVEMENT, 3"
- [Pattern] BRICK DRIVEWAY REMOVAL & REPLACEMENT
- [Pattern] AGGREGATE SHOULDERS (SPECIAL)
- [Pattern] HOT-MIX ASPHALT SURFACE REMOVAL -- BUTT JOINT
- [Symbol] PERIMETER EROSION BARRIER

**DUFFY LANE**

