

PROP. CURVE GOLFVIEW-1
 PI STA. = 21+97.56
 $\Delta = 4^\circ 42' 58''$ (RT)
 $D = 3^\circ 00' 56''$
 $R = 1,900.00'$
 $T = 78.24'$
 $L = 156.39'$
 $E = 1.61'$
 $e =$
 $T.R. =$
 $S.E. RUN =$
 $P.C. STA = 21+19.32$
 $P.T. STA = 22+75.71$

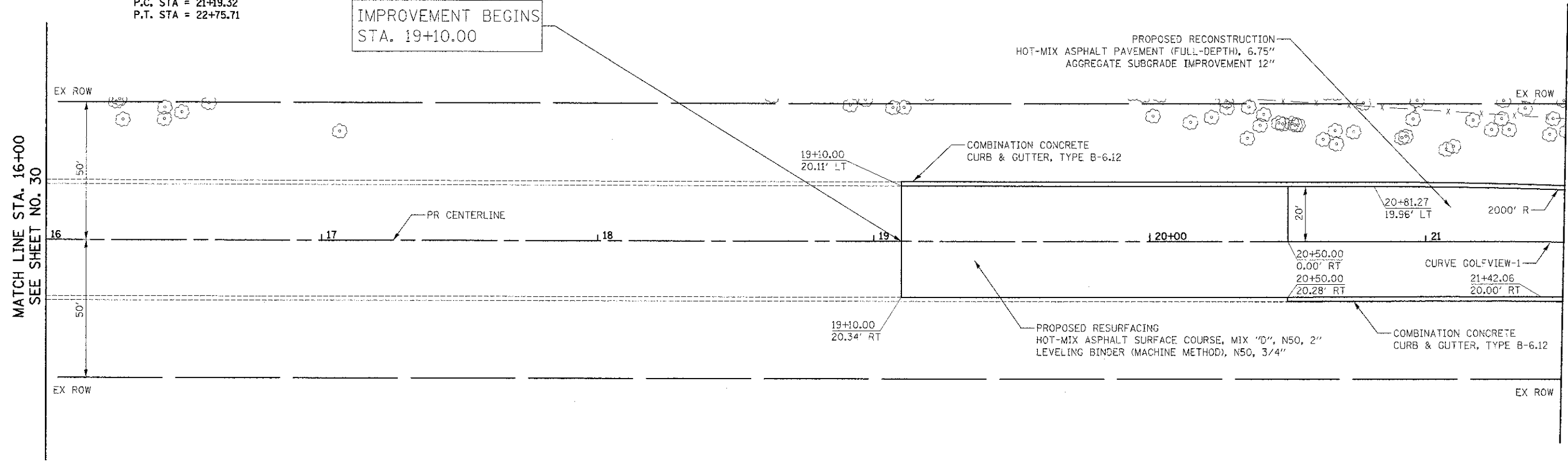

MATCH LINE STA. 16+00
SEE SHEET NO. 30

MATCH LINE STA. 21+50
SEE SHEET NO. 32

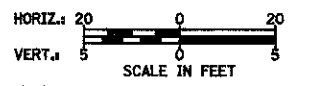

GOLFVIEW AVENUE

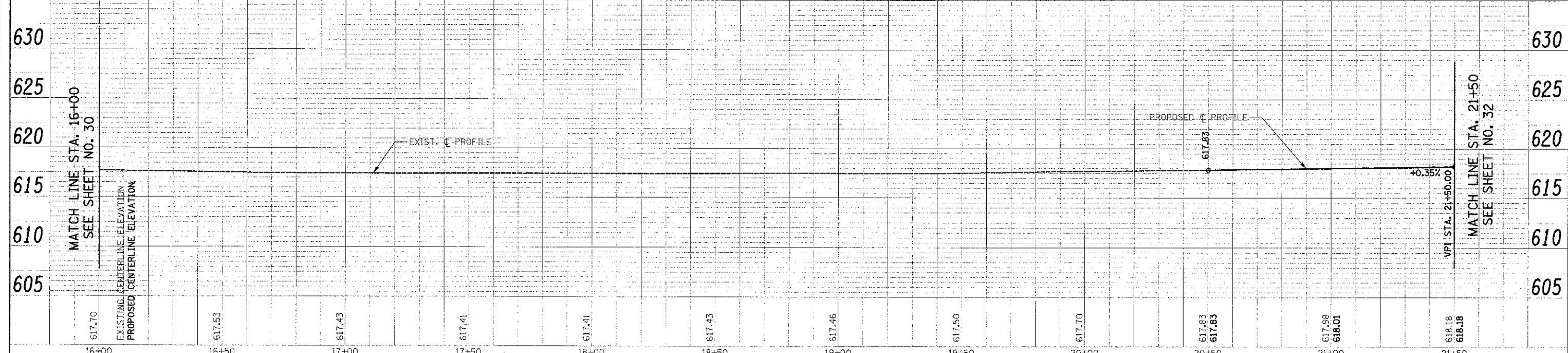

MATCH LINE STA. 16+00
SEE SHEET NO. 30

MATCH LINE STA. 21+50
SEE SHEET NO. 32

DATE	BY
DESIGNED	DTE
DRAWN	DTE
CHECKED	GAB
DATE	10/22/2012

DATE	BY
DESIGNED	DTE
DRAWN	DTE
CHECKED	GAB
DATE	10/22/2012

FILE NAME ...2563_P&P_04.dgn	USER NAME = dte	DESIGNED - DTE	REVISIONS	STATE OF ILLINOIS DEPARTMENT OF TRANSPORTATION		PLAN AND PROFILE		F.A.I. RTE.	SECTION	COUNTY	TOTAL SHEET NO.	
	PLOT SCALE = 20.0/300' / in.	CHECKED - GAB	REVISIONS					3784	12-F3000-23-PK	COOK	133	31
	PLOT DATE = 11/9/2012	DATE - 10/22/2012	REVISIONS					SCALE: 1" = 20' SHEET NO. 4 OF 5 SHEETS STA. 16+00 TO STA. 21+50				
								FED. ROAD DIST. NO. 1 ILLINOIS FED. AID PROJECT				
CONTRACT NO. 63764												