

NOTES

1. SEE SHEET 56 FOR DRAINAGE STRUCTURE INFORMATION.
2. NEW STORM STRUCTURES TO BE CUT INTO AN EXISTING STORM SEWER LINE SHALL REQUIRE 4 FEET OF NEW STORM SEWER IN EACH APPLICABLE DIRECTION. THIS WORK SHALL BE PAID FOR AS THE SAME TYPE AND SIZE OF THE EXISTING SEWER BEING TIED IN TO.

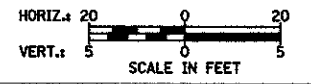

DATE	
NO.	
REVISIONS	
PLAN	
NO.	
NOTE BOOK	
ALIGNED	
CHECKED	
PLOTTED	
DATE	
FILE NAME	

DATE	
NO.	
REVISIONS	
PROFILE	
NO.	
NOTE BOOK	
GRADES CHECKED	
BEAM NOTED	
PLANNING	
NO.	

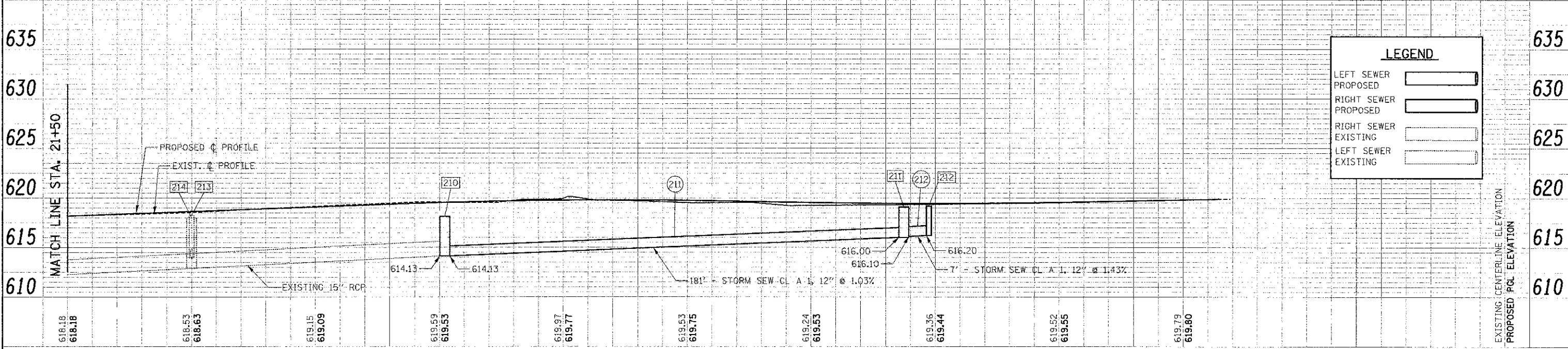

LEGEND	
LEFT SEWER PROPOSED	
RIGHT SEWER PROPOSED	
RIGHT SEWER EXISTING	
LEFT SEWER EXISTING	

FILE NAME = ...2963.0&L.05.dgn	USER NAME = dco	DESIGNED - JES	REVISED -	STATE OF ILLINOIS DEPARTMENT OF TRANSPORTATION	DRAINAGE AND UTILITIES	F.A.U. RTE. 3784	SECTION 12-F3000-23-PK	COUNTY COOK	TOTAL SHEETS 133	SHEET NO. 56	
PLOT SCALE = 20.0000' / 1"	CHECKED - GAB	REVISOR -	REVISOR -			SCALE: 1" = 20'		SHEET NO. 5 OF 6 SHEETS		STA. 21+50 TO STA. 26+15	
PLOT DATE = 11/28/2012	DATE = 10/22/2012	REVISOR -	REVISOR -			FED. ROAD DIST. NO. 1 ILLINOIS		FED. AID PROJECT		CONTRACT NO. 63764	