

NOTES FOR TEMPORARY TRAFFIC SIGNALS

1. THE LEFT TURN INDICATIONS OF THESE SIGNAL HEADS SHALL REMAIN BAGGED AND DISCONNECTED UNTIL THE BEGINNING OF M.O.T. STAGE IV.

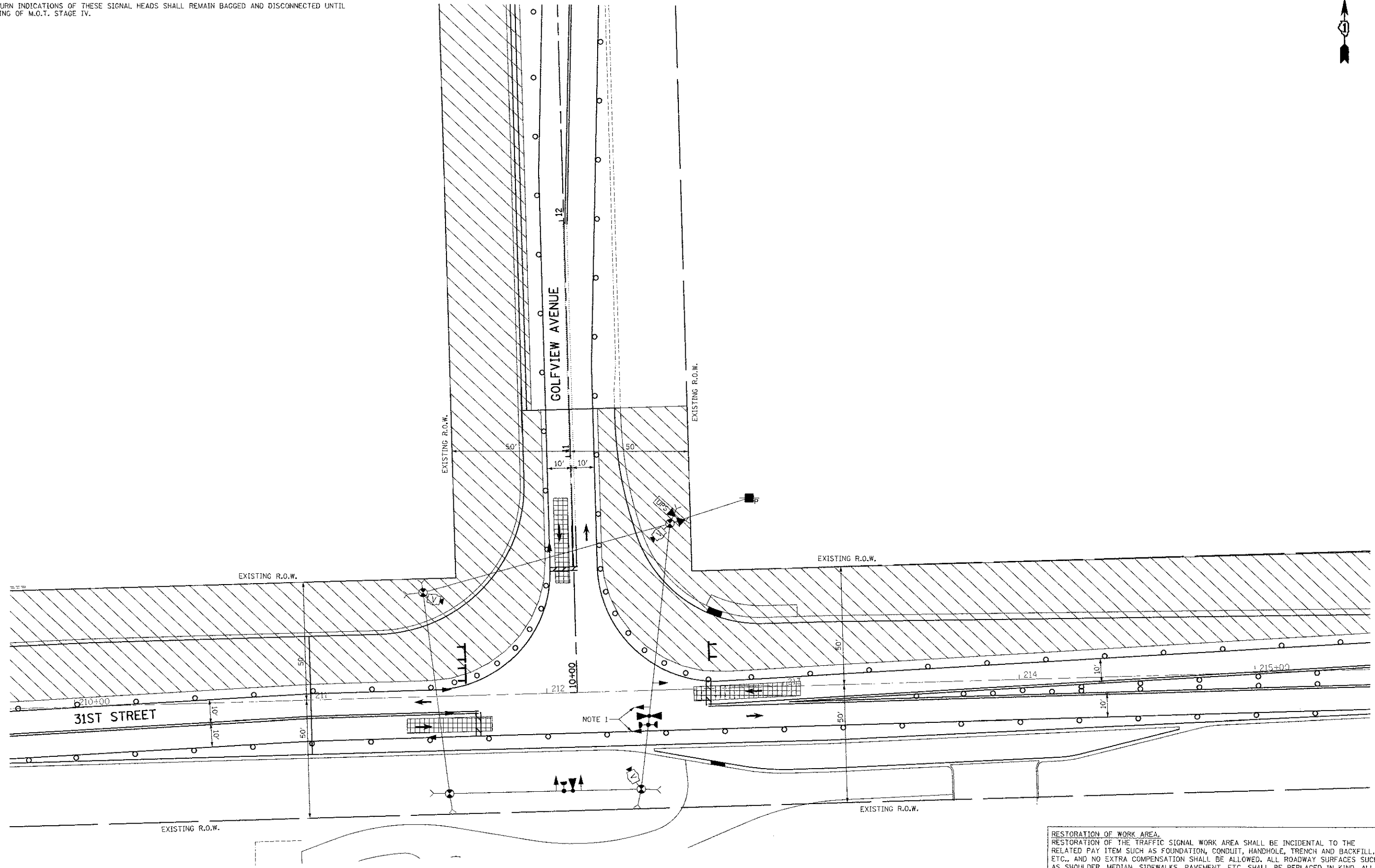

RESTORATION OF WORK AREA.  
 RESTORATION OF THE TRAFFIC SIGNAL WORK AREA SHALL BE INCIDENTAL TO THE RELATED PAY ITEM SUCH AS FOUNDATION, CONDUIT, HANDHOLE, TRENCH AND BACKFILL, ETC., AND NO EXTRA COMPENSATION SHALL BE ALLOWED. ALL ROADWAY SURFACES SUCH AS SHOULDER, MEDIAN, SIDEWALKS, PAVEMENT, ETC. SHALL BE REPLACED IN KIND. ALL DAMAGE TO MOWED LAWNS SHALL BE REPLACED WITH AN APPROVED SALT TOLERANT SOD, AND ALL DAMAGE TO UNMOWED FIELDS SHALL BE SEEDED IN ACCORDANCE WITH STANDARD SPECIFICATIONS 252 AND 250 RESPECTIVELY.



USER NAME = MFB	DESIGNED - BRD	REVISED -
PLST SCALE = 20.0000 1" = 20'	DRAWN - MFB	REVISED -
PLST DATE = 12/12/2012	CHECKED - JJE	REVISED -
	DATE - 12/XX/2012	REVISED -

STATE OF ILLINOIS  
 DEPARTMENT OF TRANSPORTATION

TEMPORARY TRAFFIC SIGNAL STAGING PLAN  
 GOLFWIEV AVENUE AT 31ST STREET - M.O.T. STAGE III

SCALE: 1" = 20' SHEET NO. 1 OF 1 SHEETS STA. TO STA.

F.A.U. RTE.	SECTION	COUNTY	TOTAL SHEETS	SHEET NO.
3784	12-F3000-23-PK	COOK	133	720
FED. ROAD DIST. NO. 1 (ILLINOIS) FED. AID PROJECT			CONTRACT NO. 63764	