

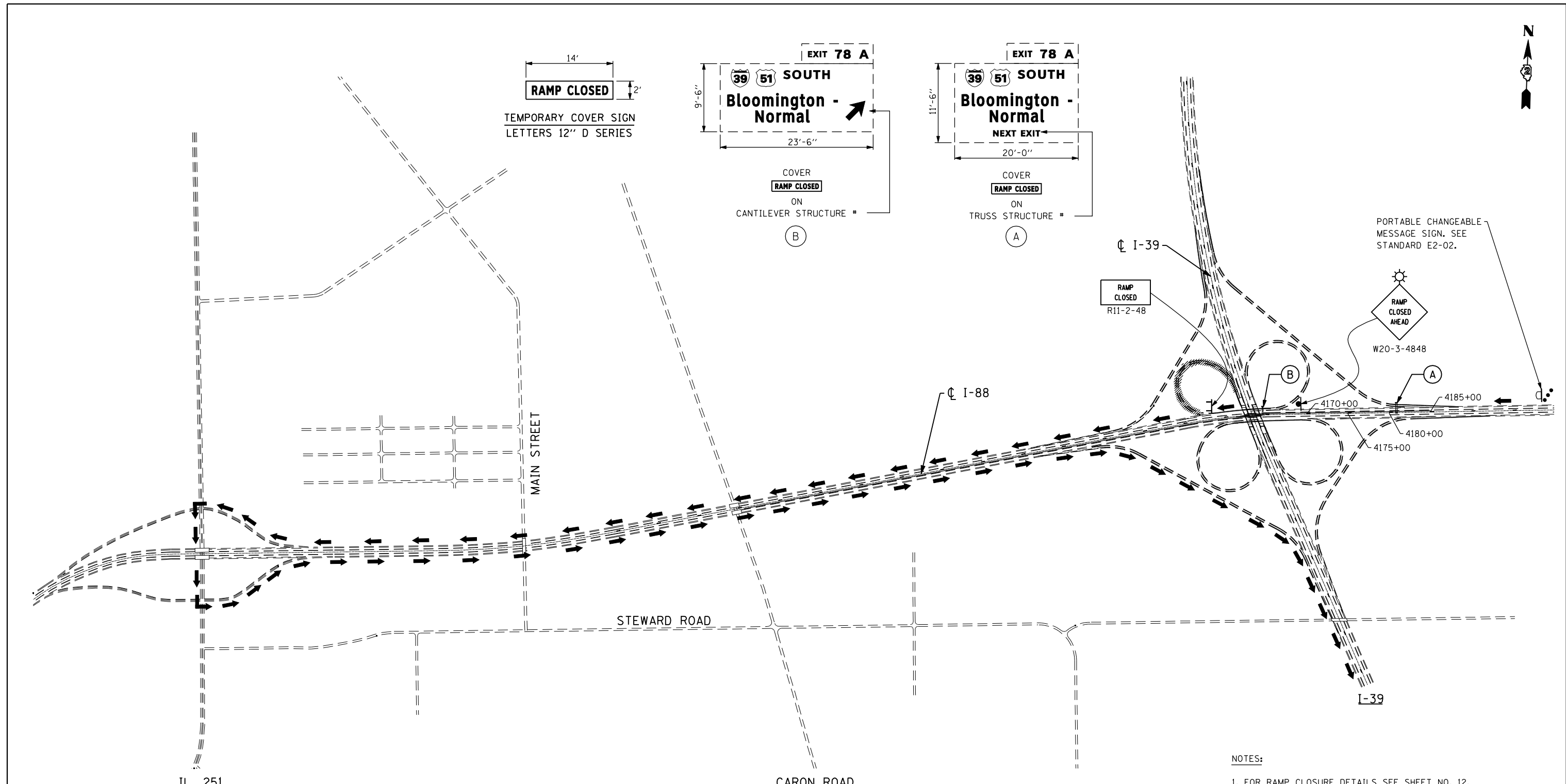

DATE	
BY	
SURVEYED	
PLOTTED	
TEMPLATE	
AREAS CHECKED	
FINAL SURVEY	
NOTE BOOK	
NO.	

DATE	
BY	
SURVEYED	
PLOTTED	
TEMPLATE	
AREAS CHECKED	
ORIGINAL SURVEY	
NOTE BOOK	
NO.	



NOTES:  
1. FOR RAMP CLOSURE DETAILS SEE SHEET NO. 12.

LEGEND  
 PROPOSED DETOUR TRAFFIC  
 RAMP CLOSURE

FILE NAME = #FILES\*  
 PLOT DATE = #DATE\*  
 PLOT SCALE = #SCALE\*

**CR & A**  
**CHRISTIAN-ROGE & ASSOCIATES, INC.**  
 ENGINEERS-PLANNERS-SURVEYORS  
 211 WEST WACKER DRIVE  
 CHICAGO, ILLINOIS 60606  
 PHONE: (312)372-2023 FAX: (312)372-8274

DESIGNED -	G.F.L.	REVISED -	
DRAWN -	B.K.	REVISED -	
CHECKED -	E.J.M.	REVISED -	
DATE -	AUGUST 2012	REVISED -	

**STATE OF ILLINOIS**  
**DEPARTMENT OF TRANSPORTATION**

**DETOUR PLAN**  
**I-39 OVER I-88**  
**RAMP CLOSURE - STAGE II**

SCALE: SHEET NO. OF SHEETS STA. TO STA.

F.A.I. RTE.	SECTION	COUNTY	TOTAL SHEETS	SHEET NO.
39	D2 DECK REPAIR 2013-1	OGLE	32	7
CONTRACT NO. 64H73				
FED. ROAD DIST. NO. 1 ILLINOIS FED. AID PROJECT				