

FINAL SURVEY	DATE
SURVEYED	BY
PLOTTED	
TEMPLATE	
NOTE BOOK	
NO.	
AREAS CHECKED	

ORIGINAL SURVEY	DATE
SURVEYED	BY
PLOTTED	
TEMPLATE	
NOTE BOOK	
NO.	
AREAS CHECKED	

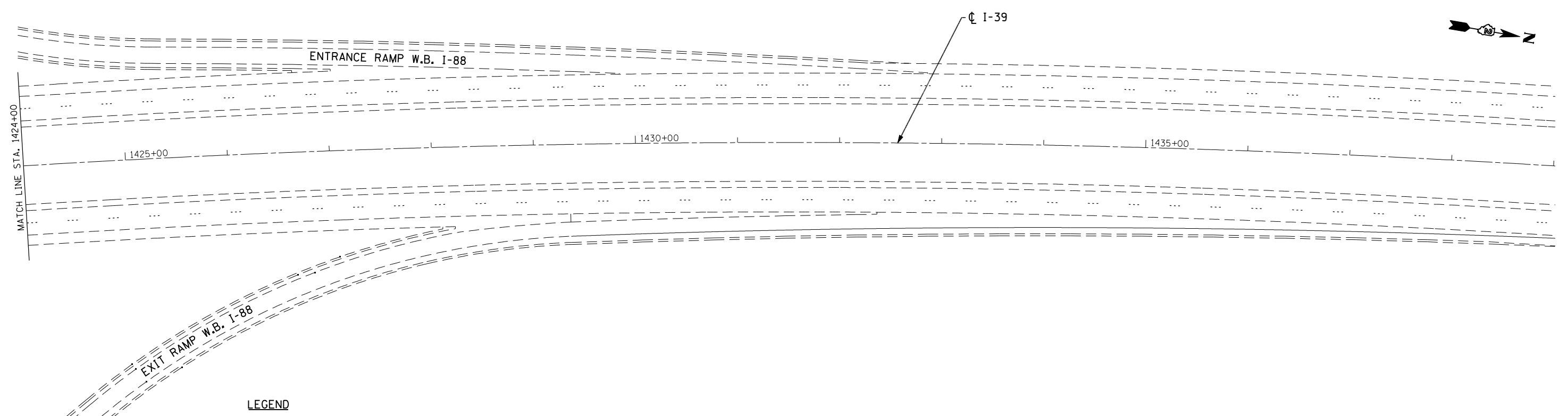
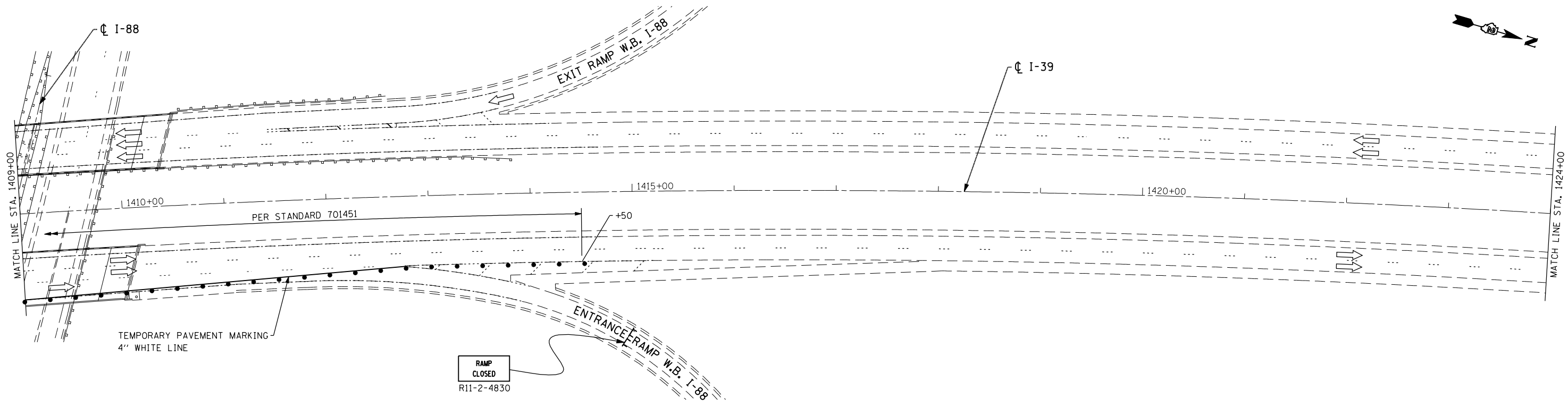

- LEGEND**
- TRAFFIC FLOW ARROW
 - DRUMS SPACED AT INTERVALS AS NOTED
 - TEMPORARY SIGN WITH MESSAGE
 - TYPE III BARRICADES
 - PAVEMENT MARKING REMOVAL

FILE NAME = sht-stagel.02 I-39.dgn
 PLOT DATE = 9/6/2012
 PLOT SCALE = 100.0000' / IN.

CHRISTIAN-ROGE & ASSOCIATES, INC.
 ENGINEERS-PLANNERS-SURVEYORS
 211 WEST WACKER DRIVE
 CHICAGO, ILLINOIS 60606
 PHONE: (312)372-2023 FAX: (312)372-8274

DESIGNED - E.M.	REVISED -
DRAWN - B.K.	REVISED -
CHECKED - G.F.L.	REVISED -
DATE - JULY 2012	REVISED -

**STATE OF ILLINOIS
 DEPARTMENT OF TRANSPORTATION**

**TRAFFIC CONTROL AND PROTECTION
 STAGE I
 I-39 OVER I-88**

SCALE: SHEET NO. OF SHEETS STA. TO STA.

F.A.I. RTE.	SECTION	COUNTY	TOTAL SHEETS	SHEET NO.
39	D2 BRIDGE PAINTING 2013-2	OGLE	26	10
				CONTRACT NO. 64J27
FED. ROAD DIST. NO. 1 ILLINOIS FED. AID PROJECT				