

F.A.P. RTE.	SECTION	COUNTY	TOTAL SHEETS	SHEET NO.
311	(1-1)R	KENDALL	514	87
STA. 831+00	TO STA. 858+00			
FED. ROAD DIST. NO.		ILLINOIS	FED. AID PROJECT	

SEE SHEET 92 FOR CONTINUATION OF MAIN ST.

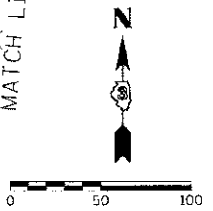

IRIS CT

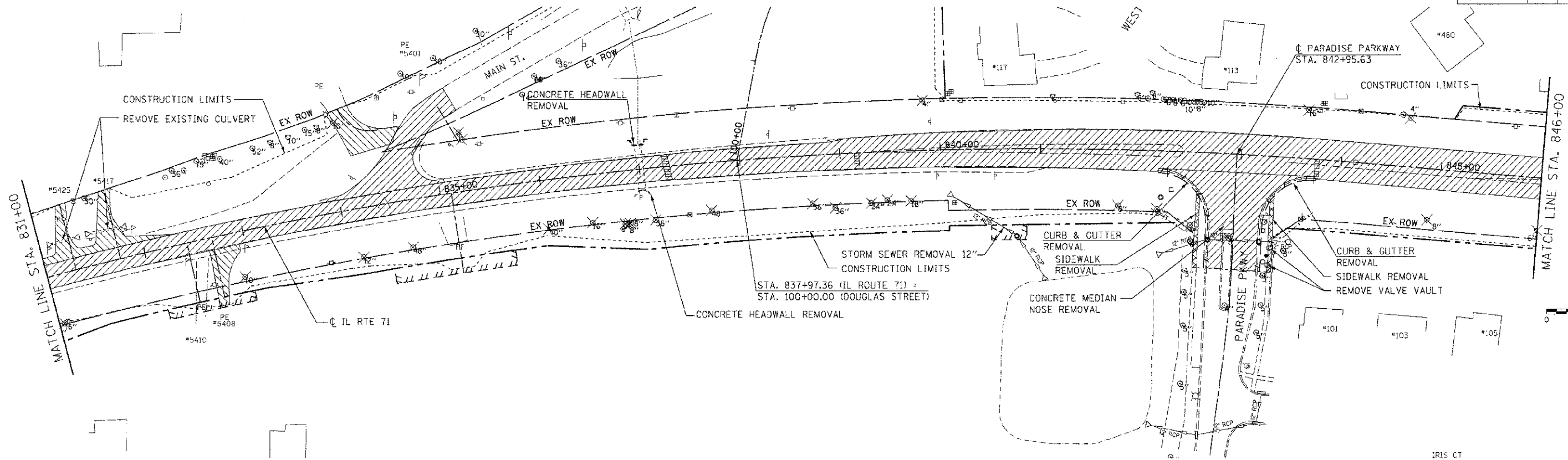
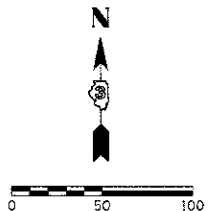
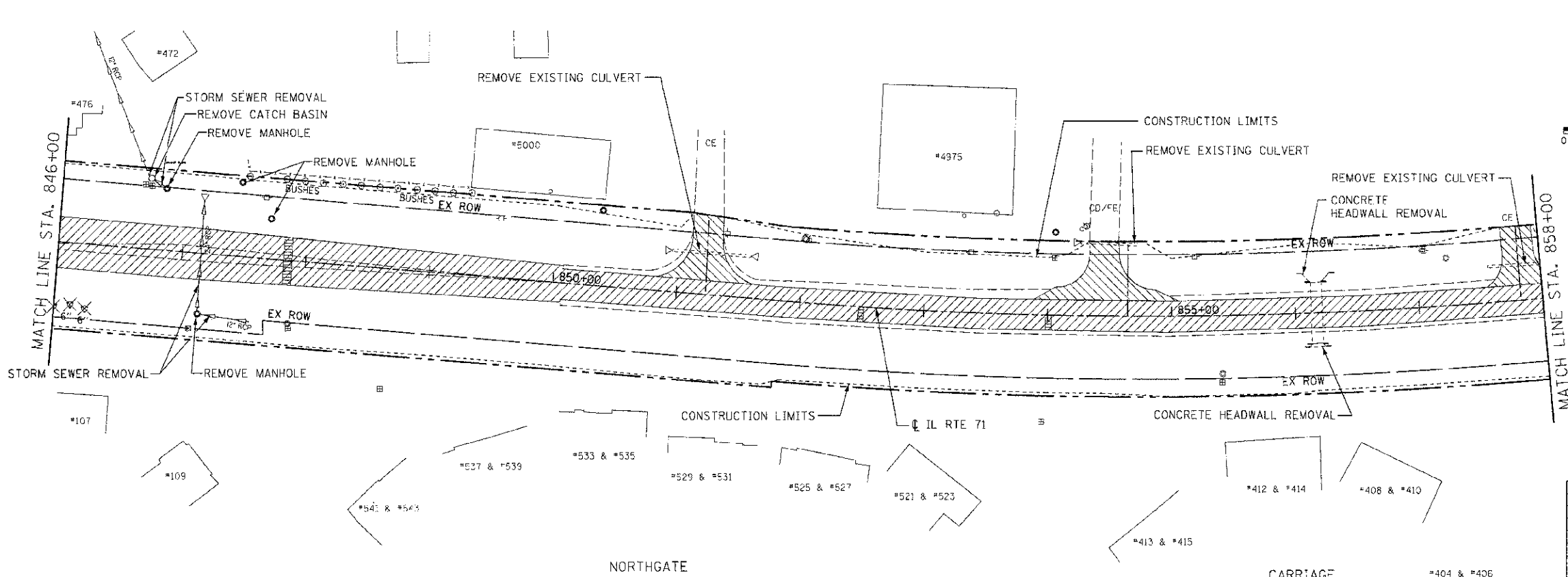

- PAVEMENT REMOVAL
- DRIVEWAY PAVEMENT REMOVAL
- CURB AND GUTTER REMOVAL
- SIDEWALK REMOVAL
- CLASS D PATCHES
- 42" TREE REMOVAL/DIAMETER

REVISIONS	
NAME	DATE

ILLINOIS DEPARTMENT OF TRANSPORTATION
REMOVAL PLAN
IL RTE 71
STA. 831+00 TO STA. 858+00
 SCALE: VERT. 1"=50'
 HORIZ. 1"=50'
 DATE 7/5/2012
 DRAWN BY TRC
 CHECKED BY MED

TUG PROJ: 13085914
 PLOT DATE: 7/5/2012
 FILE NAME: J:\N\1111\1061.dwg