

F.A.P. NO.	SECTION	COUNTY	TOTAL SHEETS	SHEET NO.
3:1	11-D R	KENDALL	514	126
STA.	TO STA.			
FED. ROAD DIST. NO.	ILLINOIS FED. AID PROJECT			

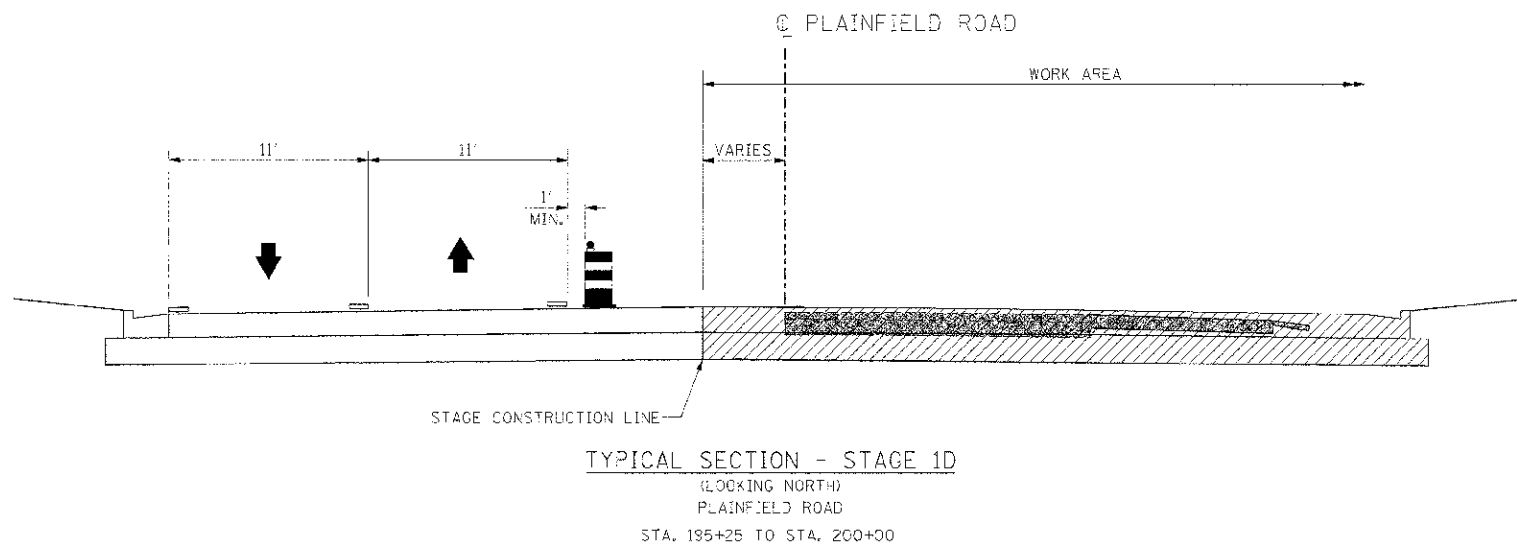
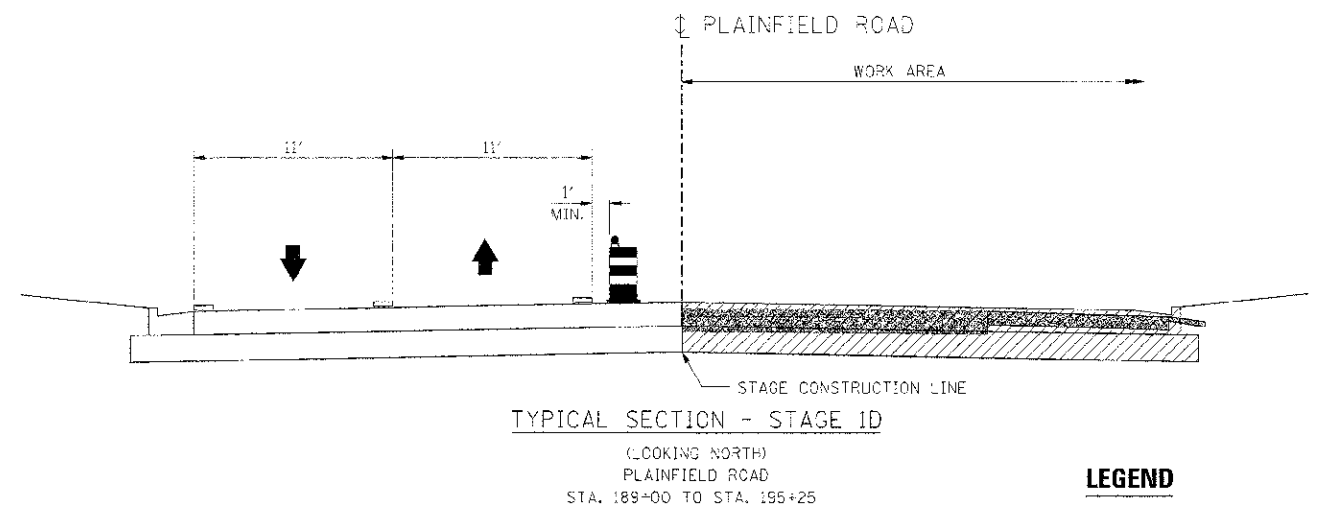
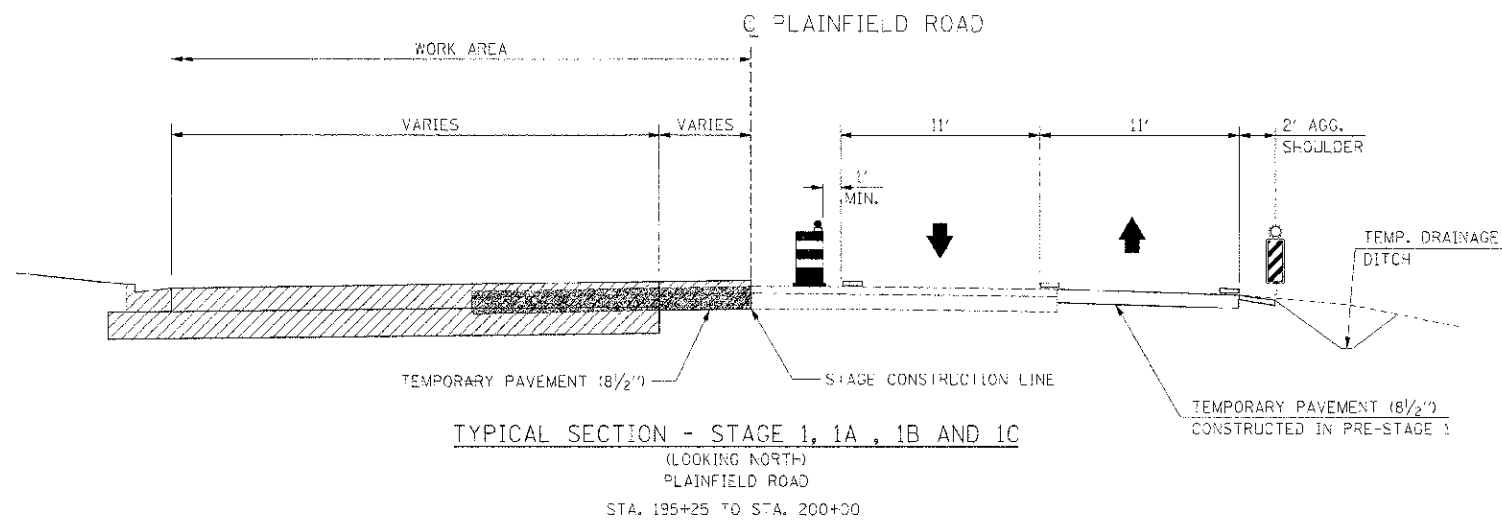
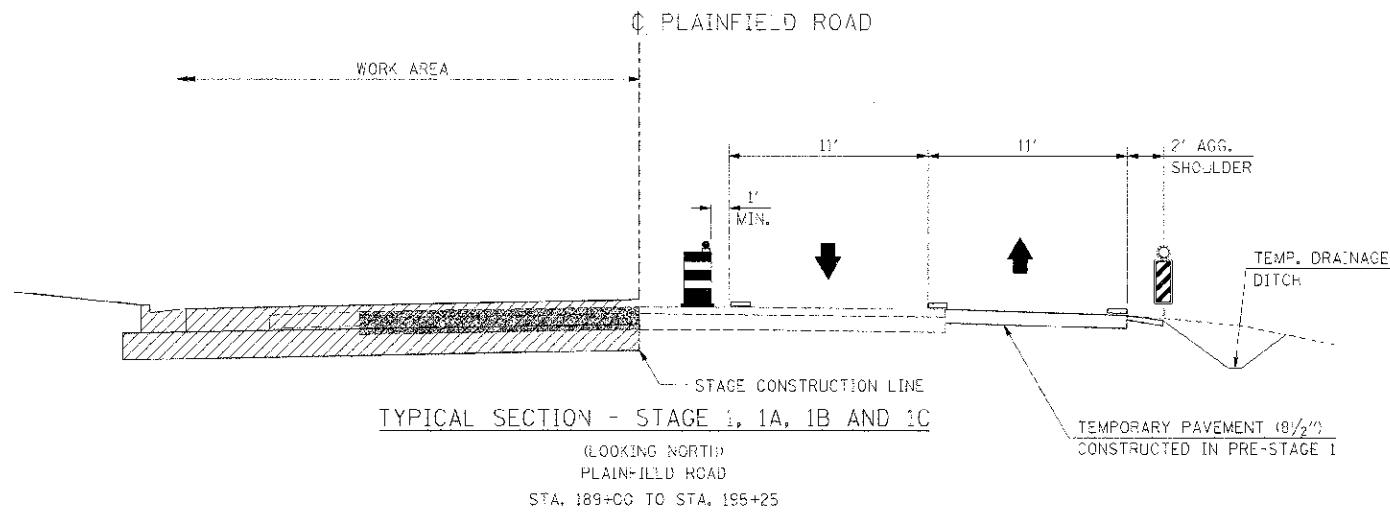

LEGEND

- VERTICAL PANEL
- DRUM WITH STEADY FLASHING LIGHT
- TRAFFIC FLOW
- PREVIOUS STAGE CONSTRUCTION
- CURRENT STAGE CONSTRUCTION
- PAVEMENT REMOVAL
- TEMPORARY PAVEMENT MARKING

REVISIONS	
NAME	DATE

ILLINOIS DEPARTMENT OF TRANSPORTATION
MAINTENANCE OF TRAFFIC
STAGE 1 & SUB-STAGES
TYPICAL SECTIONS - SIDEROADS

SCALE: NONE
 DATE: 7/3/2012
 DRAWN BY: AAD
 CHECKED BY: RG

IE PROJ: 506025
 PLOT DATE: 7/3/2012
 FILE NAME: G:\506025\CAD\171\DOT_TS_124.DWG