

F.A.P. RTE.	SECTION	COUNTY	TOTAL SHEETS	SHEET NO.
511	(1-1) P	KENDALL	514	131
STA.		TO STA.		
FED. ROAD DIST. NO.	ILLINOIS	FED. AID PROJECT		

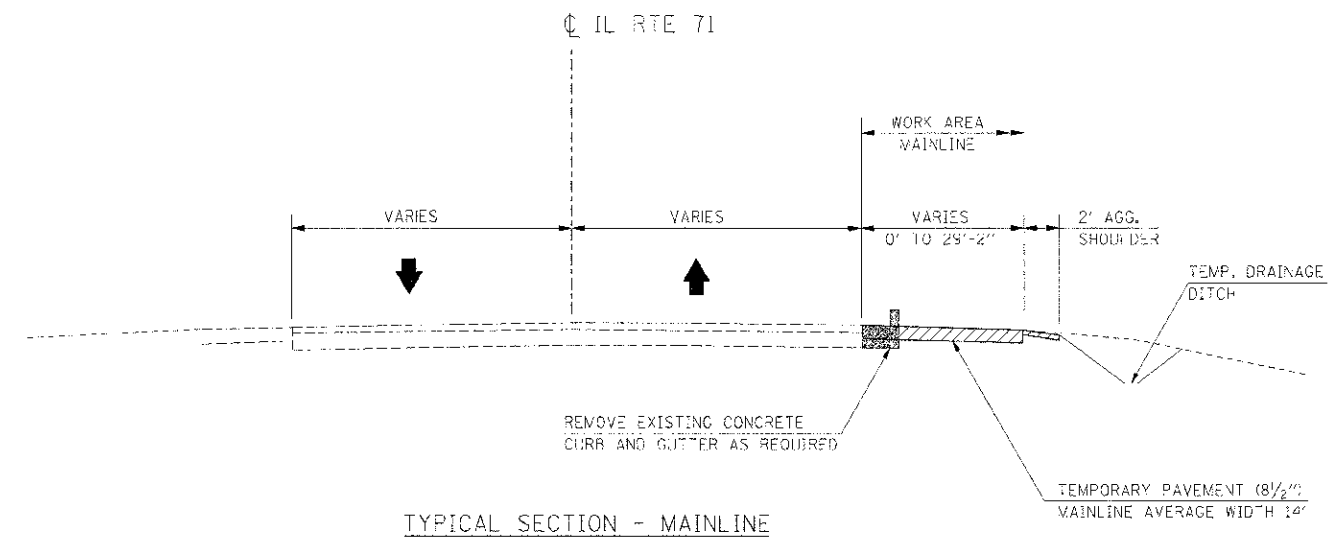

**TYPICAL SECTION - MAINLINE**  
 (LOOKING EAST)  
 ILLINOIS ROUTE 71  
 STA. 774+45 TO STA. 805+00

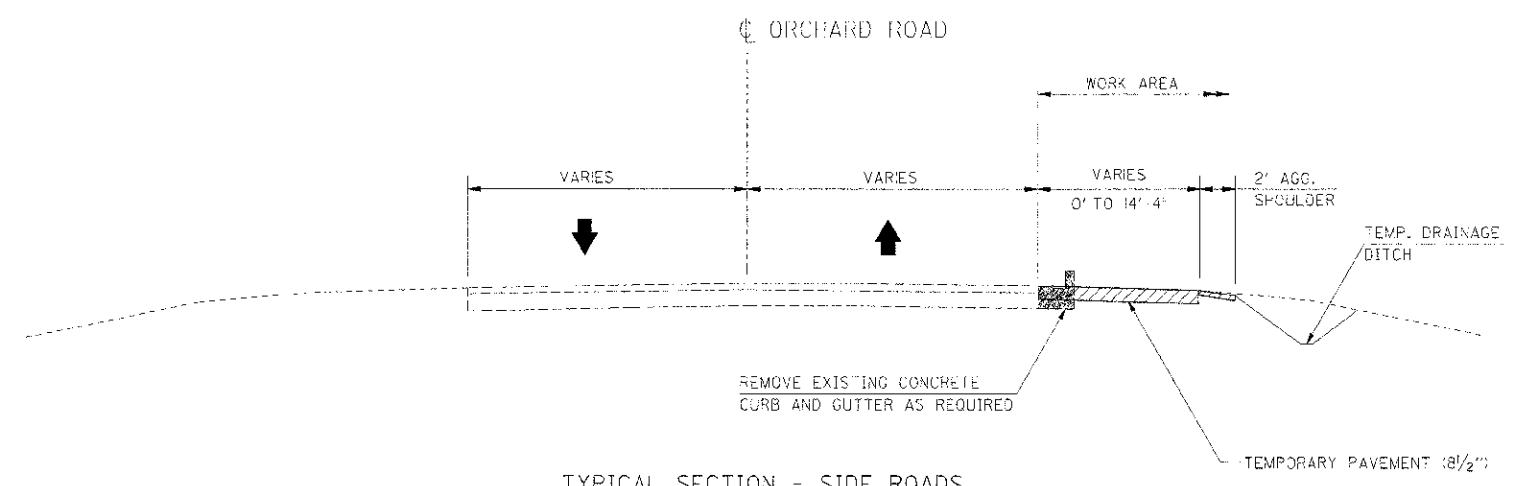



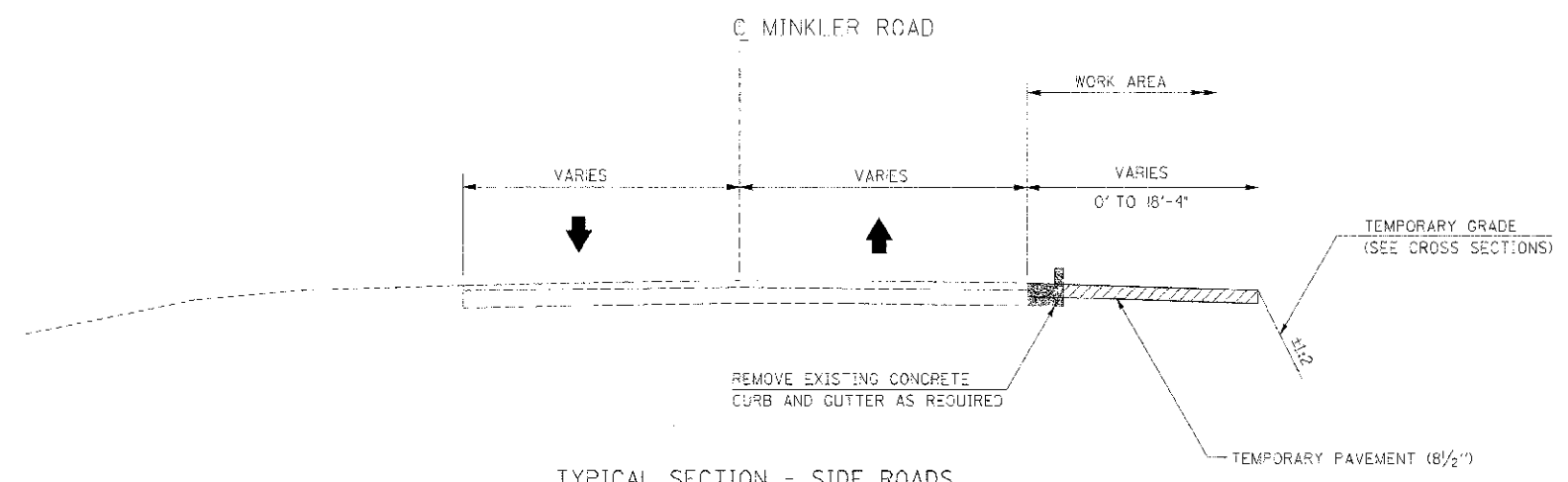



**TYPICAL SECTION - SIDE ROADS**  
 (LOOKING NORTH)  
 ORCHARD ROAD



**TYPICAL SECTION - SIDE ROADS**  
 (LOOKING NORTH)  
 MINKLER ROAD

**LEGEND**

-  VERTICAL PANEL
-  DRUM WITH STEADY BURNING LIGHT
-  TRAFFIC FLOW
-  PREVIOUS STAGE CONSTRUCTION
-  CURRENT STAGE CONSTRUCTION
-  PAVEMENT REMOVAL
-  TEMPORARY PAVEMENT MARKING

REVISIONS	
NAME	DATE

ILLINOIS DEPARTMENT OF TRANSPORTATION  
**MAINTENANCE OF TRAFFIC**  
**PRE-STAGE 4**  
**TYPICAL SECTIONS**

SCALE: NONE  
 DATE: 7/3/2012

DRAWN BY: AAD  
 CHECKED BY: RG

IC PROJ. #190625  
 PLOT DATE: 7/3/2012  
 FILE NAME: G:\SBR025\CAD\171\MOT-TS-PRF-A01.DWG