

F.A.P. RTE.	SECTION	COUNTY	TOTAL SHEET
311	G-D R	KENDALL	514
STA. TO STA.		SHEETS NO.	
		136	
FED. ROAD DIST. NO.		ILLINOIS FED. AID PROJECT	

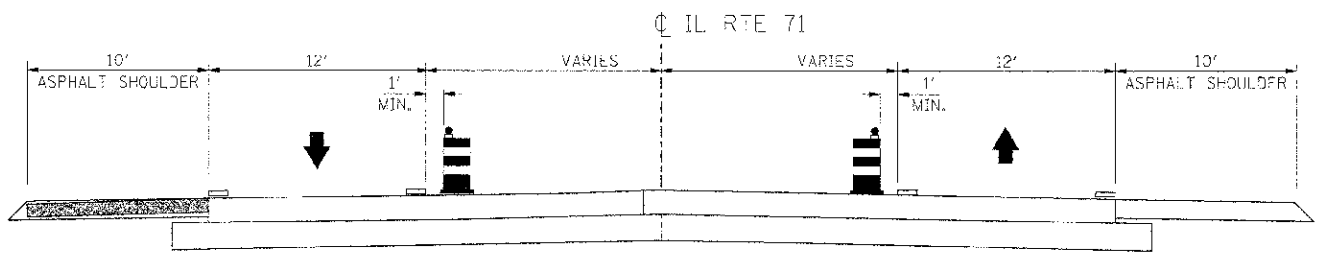

TYPICAL SECTION

(LOOKING EAST)
STA. 780+45 TO STA. 785+67

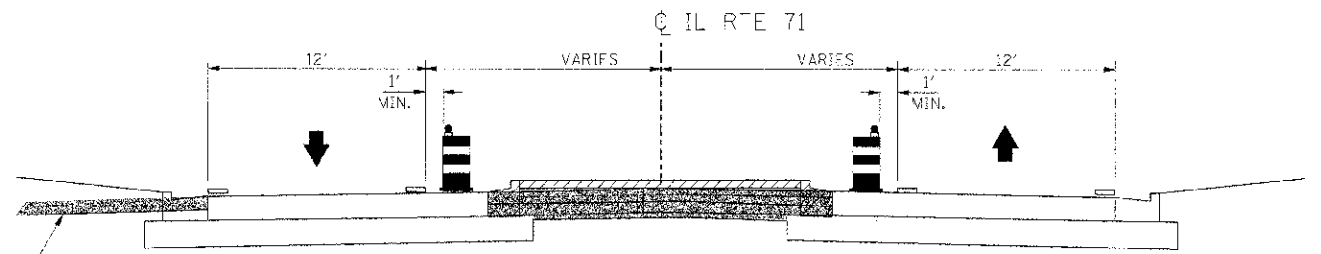

TYPICAL SECTION

(LOOKING EAST)
STA. 785+67 TO STA. 792+00

REMOVE TEMPORARY PAVEMENT
STA. 785+67 TO STA. 788+50

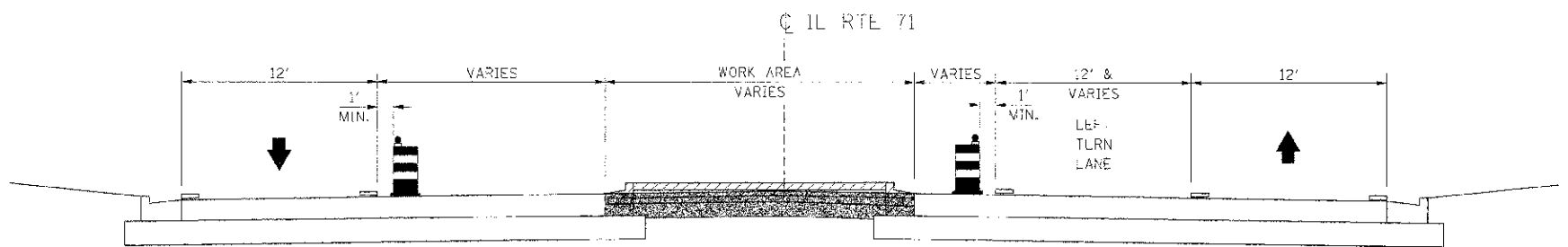

TYPICAL SECTION

(LOOKING EAST)
STA. 792+00 TO STA. 798+20.85

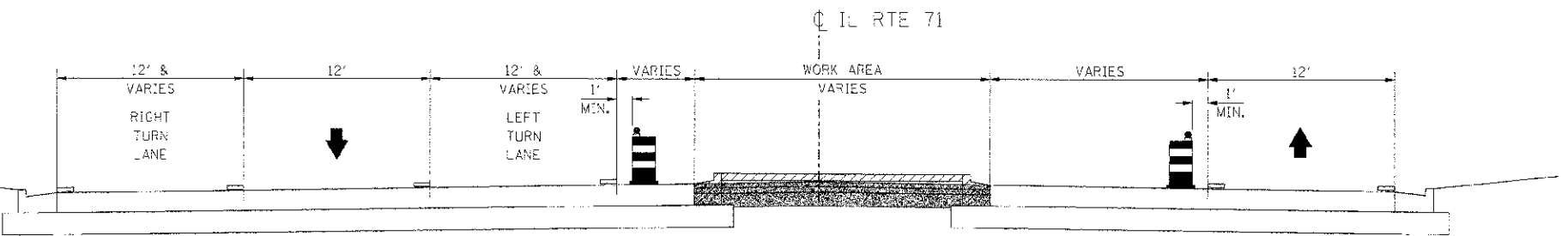

TYPICAL SECTION

(LOOKING EAST)
STA. 798+20.85 TO STA. 805+00

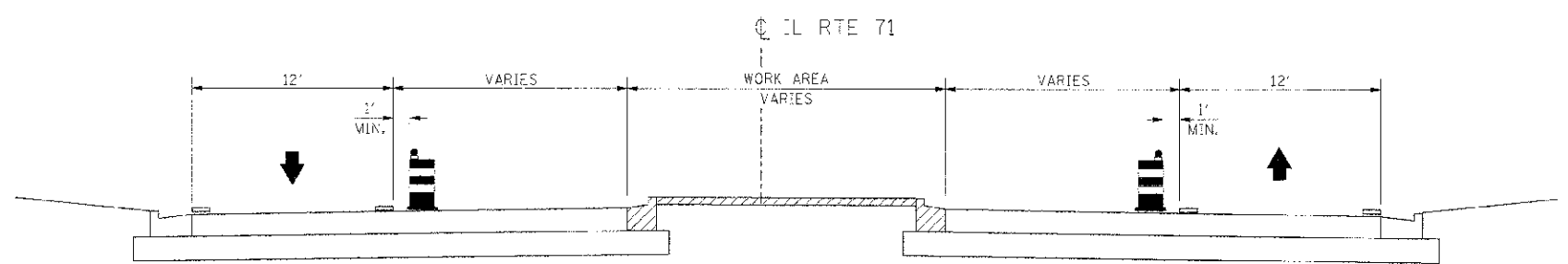

TYPICAL SECTION

(LOOKING EAST)
STA. 805+00 TO STA. 812+50

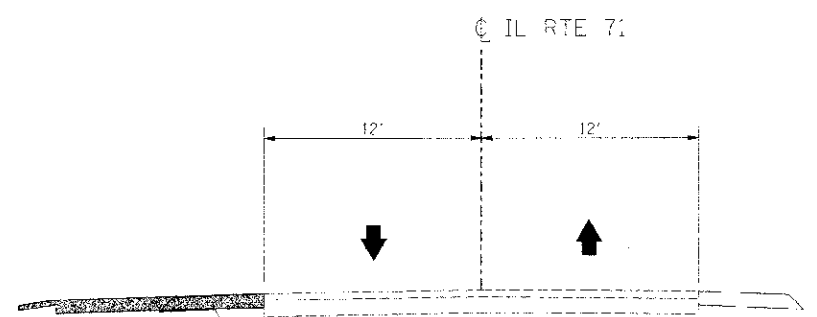





TYPICAL SECTION

(LOOKING EAST)
STA. 774+45 TO STA. 780+45

NOTE:

SEE "MAINTENANCE OF TRAFFIC" SHEETS FOR LIMITS OF TEMPORARY PAVEMENT TO BE REMOVED.

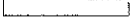
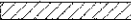
LEGEND

-  VERTICAL PANEL
-  DRUM WITH STEADY BURNING LIGHT
-  TRAFFIC FLOW
-  PREVIOUS STAGE CONSTRUCTION
-  CURRENT STAGE CONSTRUCTION
-  PAVEMENT REMOVAL
-  TEMPORARY PAVEMENT MARKING

REVISIONS	
NAME	DATE

ILLINOIS DEPARTMENT OF TRANSPORTATION
MAINTENANCE OF TRAFFIC
STAGE 6
TYPICAL SECTIONS - MAINLINE

SCALE: NONE
DATE 7/3/2012

DRAWN BY AAD
CHECKED BY RG

IF PROD. *5883925
 PLOT DATE = 7/3/2012
 FILE NAME = G:\30825\CONV\7L\MOT-15.601.SHT