

F.A.P. RTE:	SECTION	COUNTY	TOTAL SHEETS	SHEET NO.
311	(1-1) R	KEOKUK	534	152
STA. 831+00	TO STA. 846+00			
FED. ROAD DIST. NO.	ILLINOIS FED. AID PROJECT			

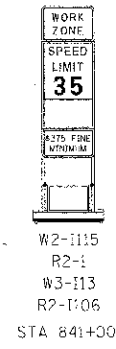
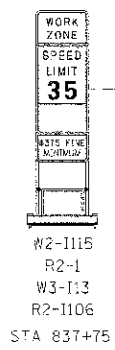
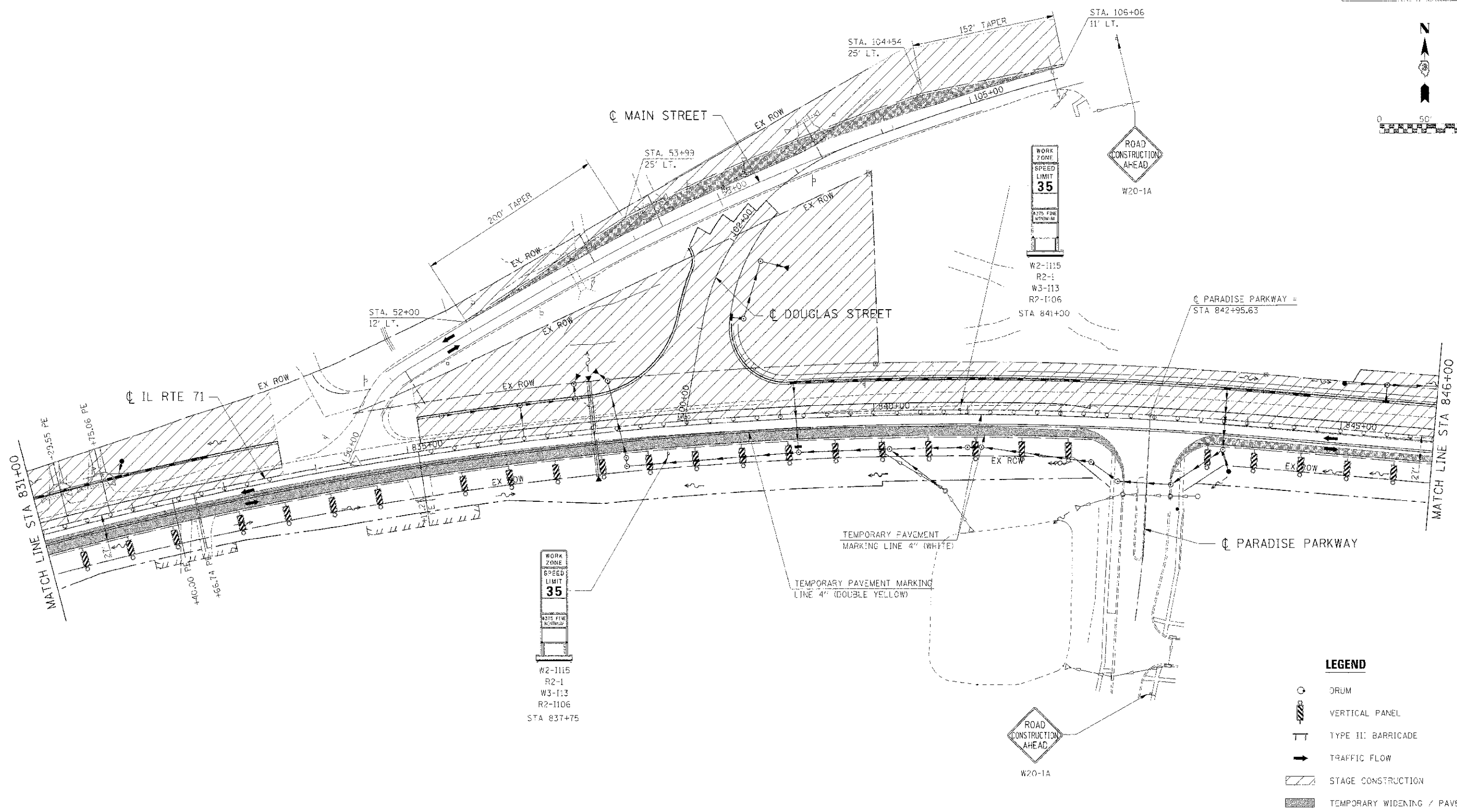
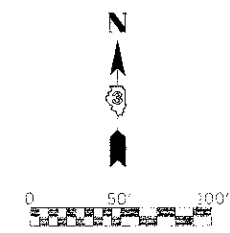

- LEGEND**
- DRUM
 - VERTICAL PANEL
 - TYPE II: BARRICADE
 - TRAFFIC FLOW
 - STAGE CONSTRUCTION
 - TEMPORARY WIDENING / PAVEMENT

NOTE:
CONTRACTOR SHALL MAINTAIN ACCESS TO ENTRANCES AND SIDE ROADS AT ALL TIMES EXCEPT AS NOTED TO BE CLOSED.

REVISIONS	
NAME	DATE

ILLINOIS DEPARTMENT OF TRANSPORTATION
MAINTENANCE OF TRAFFIC
STAGE 1 (IL RTE 71)
STA 831+00 TO STA 846+00

SCALE: 1"=50'
DATE: 7/3/2012

DRAWN BY: _____
CHECKED BY: RG

IE PROJ: 66420
 PLOT DATE: 7/3/2012
 FILE NAME: G:\ASSETS\66420\71.MT.L1.05.SHT