

F.A.P. SITE	SECTION	COUNTY	TOTAL SHEETS	SHEET NO.
511	11-13 R	KENDALL	514	162
STA. 831+00		TO STA. 846+00		
FED. ROAD DIST. NO.	ILLINOIS	FED. AID PROJECT		

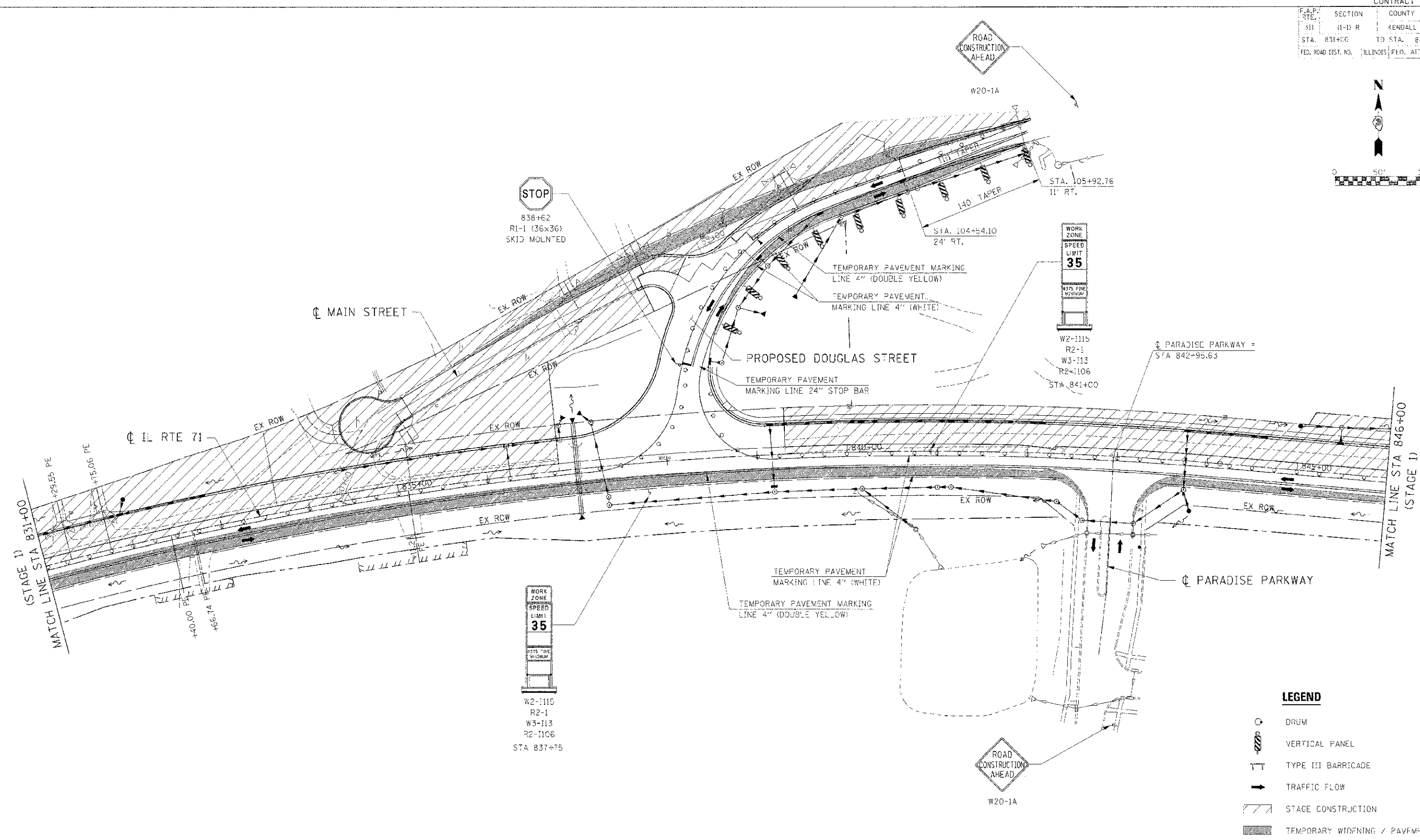
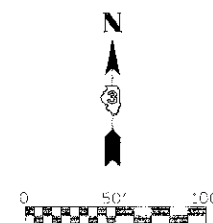

**LEGEND**

- DRUM
- VERTICAL PANEL
- TYPE III BARRICADE
- TRAFFIC FLOW
- STAGE CONSTRUCTION
- TEMPORARY WIDENING / PAVEMENT

**NOTE:**  
 CONTRACTOR SHALL MAINTAIN ACCESS TO ENTRANCES AND SIDE ROADS AT ALL TIMES EXCEPT AS NOTED TO BE CLOSED.

REVISIONS	
NAME	DATE

ILLINOIS DEPARTMENT OF TRANSPORTATION  
**MAINTENANCE OF TRAFFIC**  
**STAGE 1B (IL RTE 71)**  
**STA 831+00 TO STA 846+00**  
 SCALE: 1"=50'  
 DATE: 7/3/2012  
 DRAWN BY: \_\_\_\_\_  
 CHECKED BY: RG

IE PROJ: 66420  
 PRJ DATE: 7/3/2012  
 FILE NAME: G:\66420\CAD\17\_401\_1B\_05.dwg