

F.A.P. RTE.	SECTION	COUNTY	TOTAL SHEETS	SHEET NO.
311	(1-1) R	KENDALL	514	185
STA. 918+00		TO STA.		921+00
FED. ROAD DIST. NO.	ILLINOIS	FED. AID PROJECT		

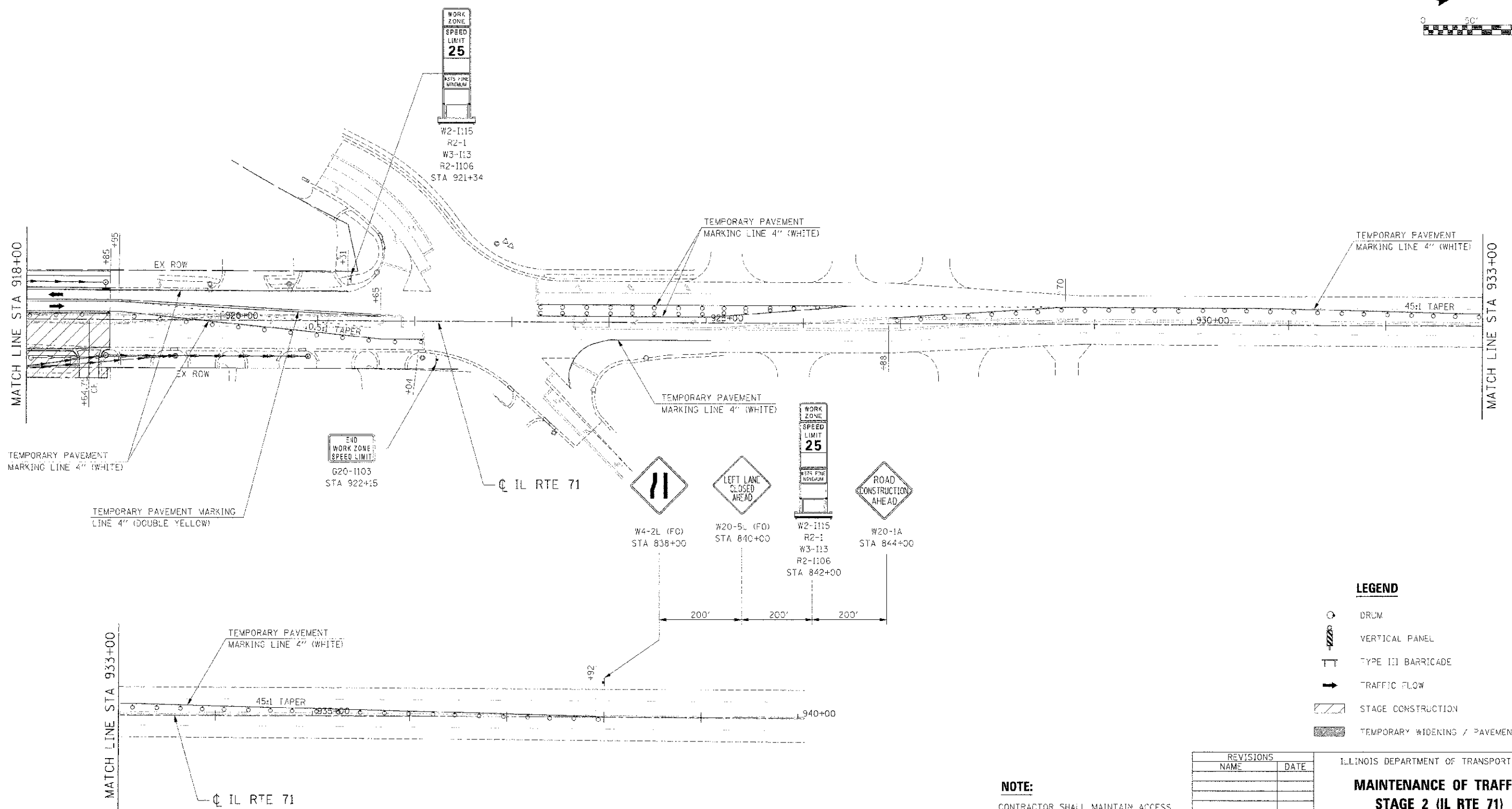
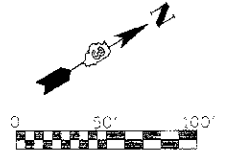

TEMPORARY PAVEMENT MARKING LINE 4" (WHITE)

TEMPORARY PAVEMENT MARKING LINE 4" (DOUBLE YELLOW)

END WORK ZONE SPEED LIMIT
G20-1103
STA 922+15

W4-2L (FO)
STA 838+00

W20-5L (FO)
STA 840+00

WORK ZONE SPEED LIMIT 25

W2-1115
R2-1
W3-1113
R2-1106
STA 842+00

W20-1A
STA 844+00

LEGEND

- DRUM
- VERTICAL PANEL
- TYPE III BARRICADE
- TRAFFIC FLOW
- STAGE CONSTRUCTION
- TEMPORARY WIDENING / PAVEMENT

REVISIONS	
NAME	DATE

ILLINOIS DEPARTMENT OF TRANSPORTATION
**MAINTENANCE OF TRAFFIC
STAGE 2 (IL RTE 71)
STA 918 + 00 TO STA 921 + 00**

SCALE: 1"=50'
DATE 7/3/2012
DRAWN BY AAD
CHECKED BY RG

NOTE:
CONTRACTOR SHALL MAINTAIN ACCESS TO ENTRANCES AND SIDE ROADS AT ALL TIMES EXCEPT AS NOTED TO BE CLOSED.

IE PROJ: 6642C
 PLOT DATE: 7/3/2012
 FILE NAME: G:\G6625\CA\IL RTE 71.MBT_2.DWG