

F.A.P. RTE.	SECTION	COUNTY	TOTAL SHEETS	SHEET NO.
313	(1-1) R	KENDALL	514	211
STA. 787+00	TO STA. 801+00			
FED. ROAD DIST. NO.	ILLINOIS	FED. AID PROJECT		

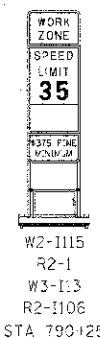

W2-1115
R2-1
W3-113
R2-1106
STA 790+25

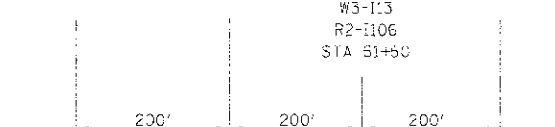
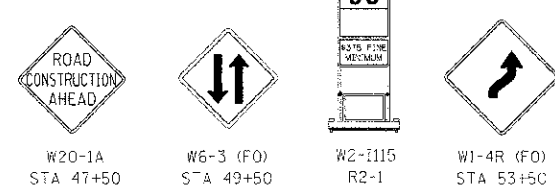
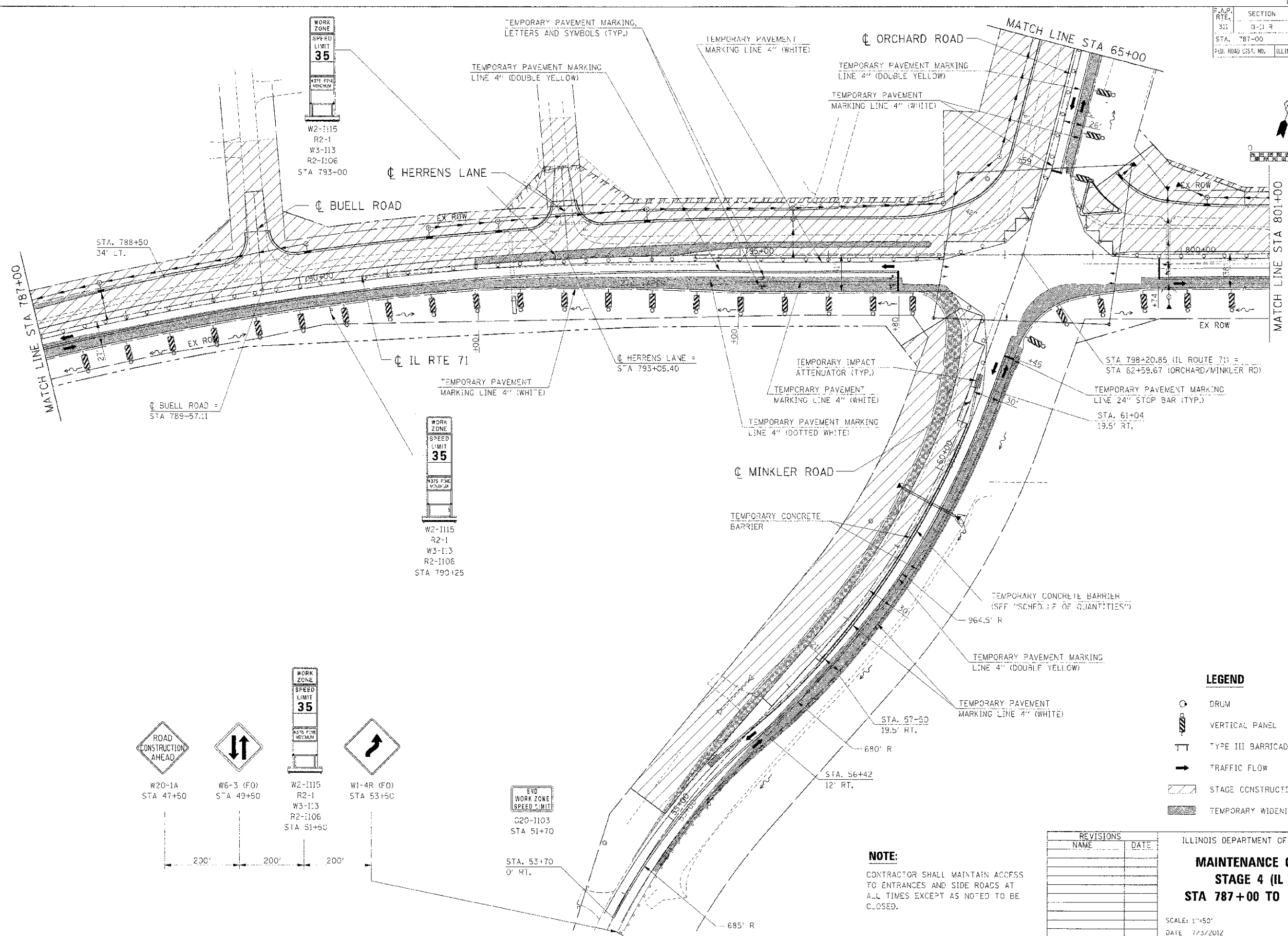
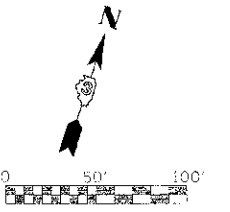
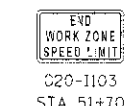

EVO
WORK ZONE
SPEED LIMIT
C20-1103
STA 51+70

LEGEND

- DRUM
- VERTICAL PANEL
- TYPE III BARRICADE
- TRAFFIC FLOW
- STAGE CONSTRUCTION
- TEMPORARY WIDENING / PAVEMENT

REVISIONS	
NAME	DATE

ILLINOIS DEPARTMENT OF TRANSPORTATION
MAINTENANCE OF TRAFFIC
STAGE 4 (IL RTE 71)
STA 787+00 TO STA 801+00
 SCALE: 1"=50'
 DATE: 7/3/2012
 DRAWN BY: AAD
 CHECKED BY: RG

NOTE:
 CONTRACTOR SHALL MAINTAIN ACCESS TO ENTRANCES AND SIDE ROADS AT ALL TIMES EXCEPT AS NOTED TO BE CLOSED.

IE PROJ: 905025
 PLOT DATE: 7/3/2012
 FILE NAME: G:\105025\CH01\71 MIT 4.DWG