

F.A.P. RTE.	SECTION	COUNTY	TOTAL SHEETS	SHEET NO.
311	(1-1)R	KENDALL	514	243
STA. 780+44.91		TO STA. 918+65.88		
FED. ROAD DIST. NO. ILLINOIS FED. AID PROJECT				

PRE-STAGE 1 TEMPORARY SEEDING:  
STA 188+00 RT TO STA 198+50 RT  
TEMP EROS CONTR SEED - 18.1 LBS  
MULCH, METHOD 2 - 0.181 ACRE

STAGE 1 TEMPORARY SEEDING:  
STA 188+00 LT TO STA 198+50 LT  
TEMP EROS CONTR SEED - 27.1 LBS  
MULCH, METHOD 2 - 0.271 ACRE

STAGE 1 SODDING:  
STA 188+00 LT TO STA 198+50 LT  
SODDING, SALT TOLERANT - 1309.7 SQ YD  
TOP SOIL F & P 4 - 1309.7 SQ YD  
NITROGEN FERT NUTR - 16.2 LBS  
PHOSPHORUS FERT NUTR - 16.2 LBS  
POTASSIUM FERT NUTR - 16.2 LBS

STAGE 1D SODDING:  
STA 188+00 RT TO STA 198+50 RT  
SODDING, SALT TOLERANT - 875.3 SQ YD  
TOP SOIL F & P 4 - 875.3 SQ YD  
NITROGEN FERT NUTR - 10.9 LBS  
PHOSPHORUS FERT NUTR - 10.9 LBS  
POTASSIUM FERT NUTR - 10.9 LBS

STAGE 1D TEMPORARY SEEDING:  
STA 188+00 RT TO STA 198+50 RT  
TEMP EROS CONTR SEED - 18.1 LBS  
MULCH, METHOD 2 - 0.181 ACRE

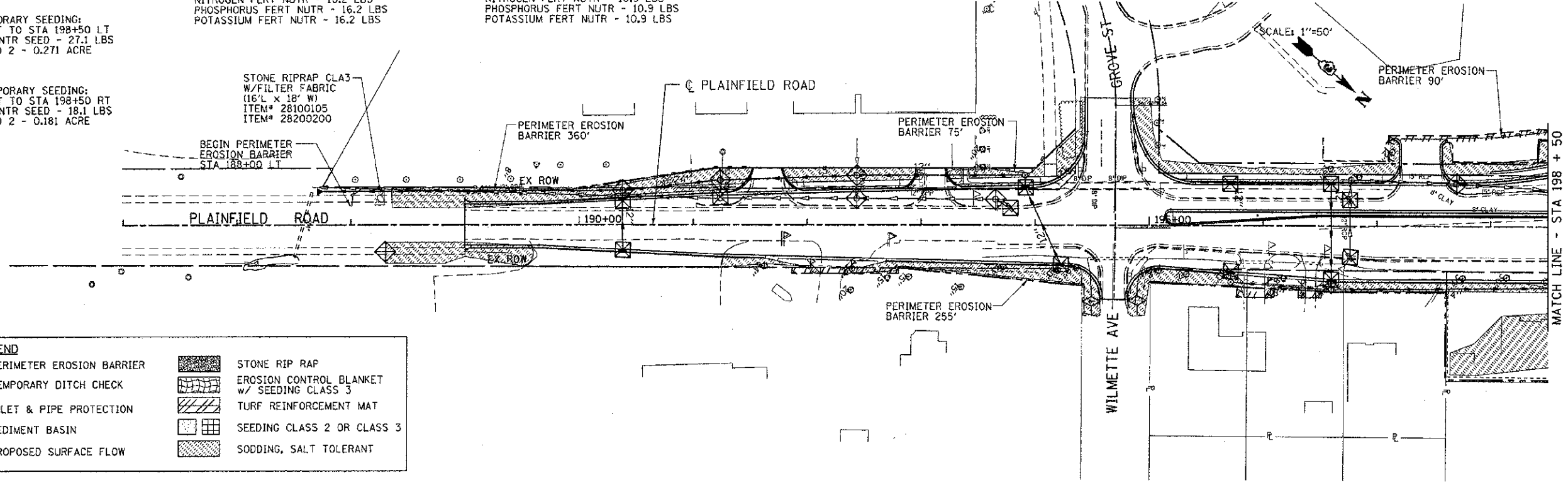

	PERIMETER EROSION BARRIER		STONE RIP RAP
	TEMPORARY DITCH CHECK		EROSION CONTROL BLANKET w/ SEEDING CLASS 3
	INLET & PIPE PROTECTION		TURF REINFORCEMENT MAT
	SEDIMENT BASIN		SEEDING CLASS 2 OR CLASS 3
	PROPOSED SURFACE FLOW		SODDING, SALT TOLERANT

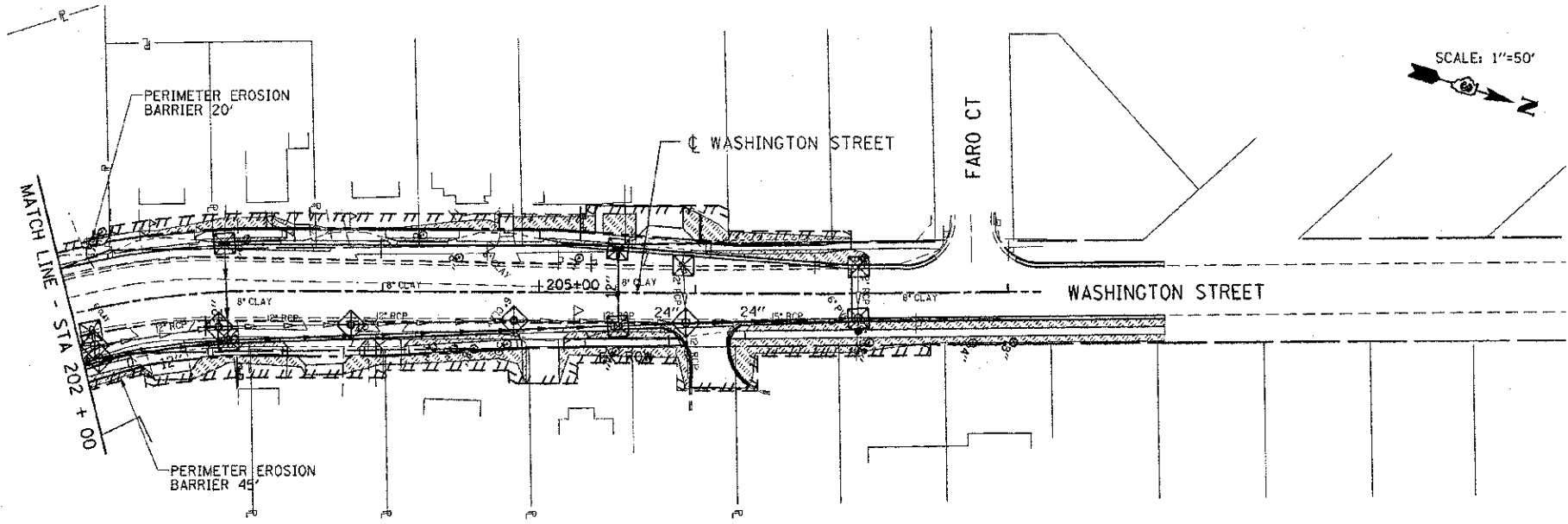

PRE-STAGE 1 TEMPORARY SEEDING:  
STA 202+00 RT TO STA 207+35 RT  
TEMP EROS CONTR SEED - 11.7 ACRE  
MULCH, METHOD 2 - 0.117 ACRE

STAGE 1 TEMPORARY SEEDING:  
STA 202+00 LT TO STA 207+35 LT  
TEMP EROS CONTR SEED - 7.8 ACRE  
MULCH, METHOD 2 - 0.078 ACRE

STAGE 1D TEMPORARY SEEDING:  
STA 202+00 RT TO STA 207+35 RT  
TEMP EROS CONTR SEED - 11.7 ACRE  
MULCH, METHOD 2 - 0.117 ACRE

STAGE 1 SODDING:  
STA 202+00 LT TO STA 207+35 LT  
SODDING, SALT TOLERANT - 378.8 SQ YD  
TOP SOIL F & P 4 - 378.8 SQ YD  
NITROGEN FERT NUTR - 4.7 LBS  
PHOSPHORUS FERT NUTR - 4.7 LBS  
POTASSIUM FERT NUTR - 4.7 LBS

STAGE 1D SODDING:  
STA 202+00 RT TO STA 207+35 RT  
SODDING, SALT TOLERANT - 565.1 SQ YD  
TOP SOIL F & P 4 - 565.1 SQ YD  
NITROGEN FERT NUTR - 7.0 LBS  
PHOSPHORUS FERT NUTR - 7.0 LBS  
POTASSIUM FERT NUTR - 7.0 LBS

**INTENDED EROSION AND LANDSCAPE SEQUENCE**

- 1) PLACE PERIMETER EROSION CONTROL BARRIER PRIOR TO COMMENCEMENT OF ANY WORK (SEE ARTICLE 280).
- 2) INSTALL TEMPORARY INLET PROTECTION AT ALL EXISTING AND PROPOSED STRUCTURES AND PIPE INLET AND OUTLETS WITHIN THE PROJECT LIMITS, AND IN ACCORDANCE WITH ARTICLE 280 OF THE IDOT STANDARD SPECIFICATION, (280001 INLET AND PIPE PROTECTION EACH).
- 3) CONSTRUCT EARTHWORK, DITCHES FIRST (MAXIMUM 10 ACRES DISTURBED AT ONE TIME PRIOR TO SEEDING - SEE ARTICLE 202 & 280).
- 4) INSTALL ALL DITCH EROSION ITEMS TO THE NEW DITCH CENTERLINES FROM OFFSETS IN SECTIONS (SEE CROSS SECTIONS)
- 5) PLACE AND MAINTAIN TEMPORARY AND PERMANENT EROSION CONTROL ITEMS FOLLOWING THE STAGED CONSTRUCTION PROCEDURE SHOWN IN THESE PLANS. SEED EVERY 7 DAYS (SEE ARTICLE 280 FOR TEMPORARY EROSION ITEMS AND ARTICLE 250 & 251 FOR PERMANENT SEEDING).
- 6) FINAL SHAPE, GRADE AND PAVE ROADWAY BY STAGING SHOWN IN PLANS.
- 7) PLACE REMAINING PERMANENT EROSION CONTROLS AND LANDSCAPE ITEMS PRIOR TO THE COMPLETION OF EACH STAGE.

NAME	DATE
BDD	8-8-12

ILLINOIS DEPARTMENT OF TRANSPORTATION

**EROSION CONTROL PLAN  
LANDSCAPING**

STA 188+00 TO STA 207+45

SCALE: VERT. 1"=10'  
HORIZ. 1"=50'  
DATE 07/06/2012  
DRAWN BY KDD  
CHECKED BY MO/MED

PLOT DATE = 8/14/2012  
 PLOT SCALE = 800000  
 PLOT USER = dmmrdbd

