

F.A.P. RTE.	SECTION	COUNTY	TOTAL SHEETS	SHEET NO.
311	0-BR	KENDALL	514	257
STA. 858+00		TO STA. 873+00		
FED. ROAD DIST. NO.		ILLINOIS		FED. AID PROJECT

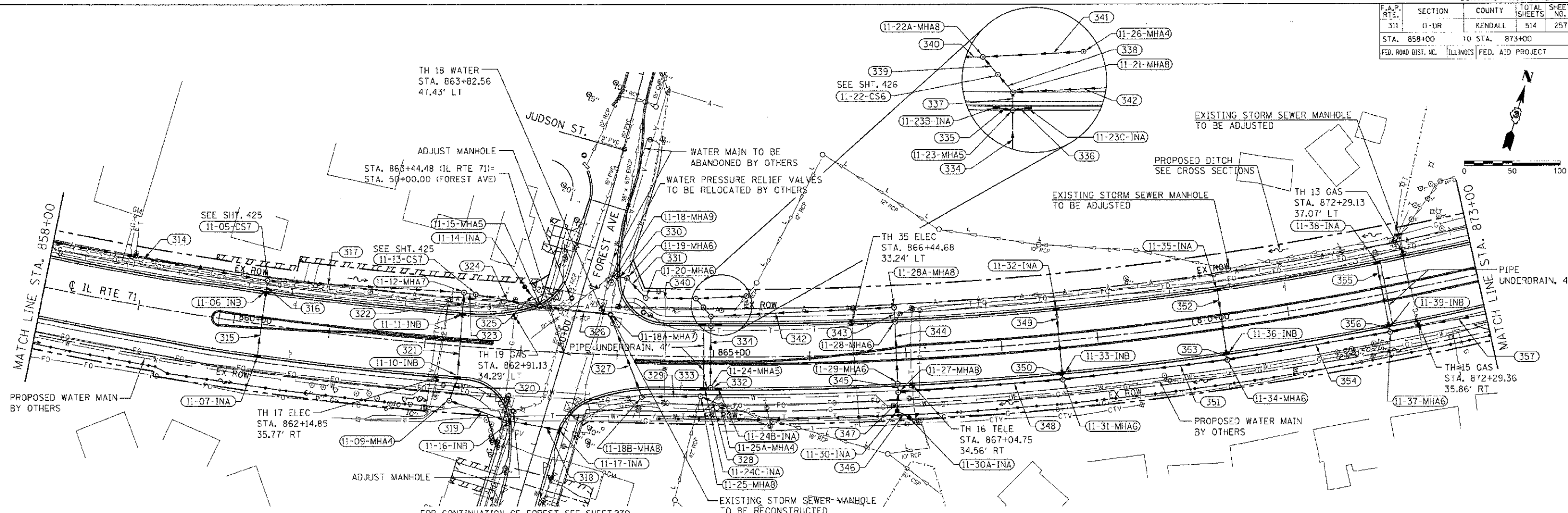

DRAINAGE STRUCTURE SCHEDULE

STRUCTURE NUMBER	STATION	OFFSET	ROUTE	STRUCTURE TYPE	CASTING	RIM ELEVATION	NORTH INVERT	SOUTH INVERT	EAST INVERT	WEST INVERT	COMMENTS
11-05-CS7	860+29.02	45.92' LT.		CONTROL STRUCTURE, 7' DIAMETER	TYPE 1 FRAME, CLOSED LID	648.60		644.74	636.67	640.41	
11-06-INB	860+29.10	32.00' LT.		INLET, TYPE B	TYPE 24 FRAME AND GRATE	649.14	644.81	644.91			
11-07-INA	860+29.10	32.00' RT.		INLET, TYPE A	TYPE 24 FRAME AND GRATE	649.14	645.14				
11-09-MHA	862+29.94	57.24' RT.		MANHOLE, TYPE A, 4' DIAMETER	TYPE 8 GRATE	643.10	638.24	638.34			
11-10-INB	862+36.47	32.00' RT.		INLET, TYPE B	TYPE 24 FRAME AND GRATE	644.08	638.05	638.15			
11-11-INB	862+36.47	32.00' LT.		INLET, TYPE B	TYPE 24 FRAME AND GRATE	644.08	637.81	637.91			
11-12-MHA	862+36.45	55.57' LT.		MANHOLE, TYPE A, 7' DIAMETER	TYPE 1 FRAME, CLOSED LID	641.87	637.70	635.35	635.35		
11-13-CS7	862+48.91	54.55' LT.		CONTROL STRUCTURE, 7' DIAMETER	TYPE 1 FRAME, CLOSED LID	643.22		635.28	635.29		
11-14-INA	863+00.00	65.48' LT.		INLET, TYPE A	TYPE 8 GRATE	639.57		637.50			
11-15-MHA	863+17.17	46.36' LT.		MANHOLE, TYPE A, 5' DIAMETER	TYPE 24 FRAME AND GRATE	641.61	637.40	633.99	633.99		
11-16-INB	862+94.15	73.85' RT.		INLET, TYPE B	TYPE 24 FRAME AND GRATE	642.08		638.59	638.59		
11-17-INA	863+42.87	80.45' RT.		INLET, TYPE A	TYPE 24 FRAME AND GRATE	641.50		638.59	638.78		
11-18-MHA	863+37.95	81.64' LT.		MANHOLE, TYPE A, 9' DIAMETER	TYPE 24 FRAME AND GRATE	639.58		632.50			
11-18A-MHA7	863+91.73	41.62' LT.		RECONSTRUCT MANHOLE	TYPE 1 FRAME, CLOSED LID	640.95	632.50	632.58		633.88	
11-18B-MHA8	864+26.98	42.71' RT.		MANHOLE, TYPE A, 8' DIAMETER	TYPE 1 FRAME, CLOSED LID	641.44	632.65		632.65		
11-19-MHA	864+07.81	79.90' LT.		MANHOLE, TYPE A, 6' DIAMETER	TYPE 1 FRAME, CLOSED LID	640.00		632.58	632.54		
11-20-MHA	864+28.30	60.11' LT.		MANHOLE, TYPE A, 6' DIAMETER	TYPE 1 FRAME, CLOSED LID	640.12		632.66	632.62		
11-21-MHA	864+97.27	42.17' LT.		MANHOLE, TYPE A, 8' DIAMETER	TYPE 1 FRAME, CLOSED LID	641.29	632.97	633.07	632.97		
11-22-CS6	864+89.32	51.25' LT.		CONTROL STRUCTURE, 8' DIAMETER	TYPE 1 FRAME, CLOSED LID	639.55	632.94	632.94			
11-22A-MHA	864+81.32	60.32' LT.		MANHOLE, TYPE A, 8' DIAMETER	TYPE 1 FRAME, CLOSED LID	638.66		632.90	632.80		
11-23-MHA	864+97.26	32.00' LT.		MANHOLE, TYPE A, 8' DIAMETER	TYPE 24 FRAME AND GRATE	640.65	633.08	633.18	634.65	634.65	
11-23B-INA	864+88.65	32.00' LT.		INLET, TYPE A	TYPE 24 FRAME AND GRATE	640.66		634.75			
11-23C-INA	865+05.09	32.00' LT.		INLET, TYPE A	TYPE 24 FRAME AND GRATE	640.65		634.75		634.75	
11-24-MHA	864+97.28	32.00' RT.		MANHOLE, TYPE A, 5' DIAMETER	TYPE 24 FRAME AND GRATE	640.65	633.49		634.65	634.65	
11-24B-INA	865+05.04	32.00' RT.		INLET, TYPE A	TYPE 24 FRAME AND GRATE	640.65		634.65		634.75	
11-24C-INA	864+90.14	32.00' RT.		INLET, TYPE A	TYPE 24 FRAME AND GRATE	640.65		634.75		634.75	
11-25-MHA	864+87.13	40.82' RT.		MANHOLE, TYPE A, 8' DIAMETER	TYPE 1 FRAME, CLOSED LID	641.18		633.75	633.75	632.72	
11-25A-MHA	865+08.24	50.00' RT.		MANHOLE, TYPE A, 4' DIAMETER	TYPE 1 FRAME, CLOSED LID	640.80			XXX	633.65	EAST INVERT TO BE OBTAINED BY CONTRACTOR
11-26-MHA	865+34.59	63.21' LT.		MANHOLE, TYPE A, 4' DIAMETER	TYPE 1 FRAME, CLOSED LID	641.31	XXX			633.18	NORTH INVERT TO BE OBTAINED BY CONTRACTOR
11-27-MHA	866+90.05	40.82' RT.		MANHOLE, TYPE A, 8' DIAMETER	TYPE 1 FRAME, CLOSED LID	642.57	634.31	637.71	634.31		
11-28-MHA	866+90.14	32.00' LT.		MANHOLE, TYPE A, 8' DIAMETER	TYPE 24 FRAME AND GRATE	642.17	633.99	633.99			
11-28A-MHA	866+90.19	47.20' LT.		MANHOLE, TYPE A, 8' DIAMETER	TYPE 1 FRAME, CLOSED LID	642.80		633.95		633.95	
11-29-MHA	866+90.03	32.00' RT.		MANHOLE, TYPE A, 8' DIAMETER	TYPE 24 FRAME AND GRATE	642.17	634.30	634.30			
11-30-INA	868+88.11	60.00' RT.		INLET, TYPE A	TYPE 8 GRATE	639.99	637.82		638.00		
11-30A-INA	867+00.00	67.50' RT.		INLET, TYPE A	TYPE 8 GRATE	640.50			638.20	638.20	
11-31-MHA	868+59.87	39.83' RT.		MANHOLE, TYPE A, 6' DIAMETER	TYPE 1 FRAME, CLOSED LID	644.44	640.11		635.18	635.18	
11-32-INA	868+59.85	32.00' LT.		INLET, TYPE A	TYPE 24 FRAME AND GRATE	644.04		640.54			
11-33-INB	868+59.85	32.00' RT.		INLET, TYPE B	TYPE 24 FRAME AND GRATE	644.04	640.23	640.13			
11-34-MHA	870+30.23	39.83' RT.		MANHOLE, TYPE A, 6' DIAMETER	TYPE 1 FRAME, CLOSED LID	646.31	641.68		636.04	636.04	
11-35-INA	870+30.21	32.00' LT.		INLET, TYPE A	TYPE 24 FRAME AND GRATE	645.91		642.41			
11-36-INB	870+30.21	32.00' RT.		INLET, TYPE B	TYPE 24 FRAME AND GRATE	645.91	642.10	642.00			
11-37-MHA	871+99.99	39.83' RT.		MANHOLE, TYPE A, 6' DIAMETER	TYPE 1 FRAME, CLOSED LID	648.18	643.85		636.90	636.90	
11-38-INA	871+99.99	32.00' LT.		INLET, TYPE A	TYPE 24 FRAME AND GRATE	647.78		644.28			
11-39-INB	871+99.96	32.00' RT.		INLET, TYPE B	TYPE 24 FRAME AND GRATE	647.78	643.97	643.87			

STORM SEWER SCHEDULE

SEGMENT	SIZE	LENGTH	GRADE
314	54" SS X	287.8' @	0.35 %
315	12" SS X	64.0' @	0.36 %
316	12" SS X	6.4' @	1.09 %
317	54" SS X	197.7' @	0.62 %
318	12" SS X	50.1' @	0.38 %
319	12" SS X	61.6' @	0.41 %
320	12" SS X	20.1' @	0.45 %
321	12" SS X	64.0' @	0.22 %
322	12" SS X	18.1' @	0.61 %
323	54" SS X	5.3' @	1.13 %
324	24" SS X	61.2' @	2.12 %
325	12" SS X	19.8' @	0.51 %
326	24" SS X	69.2' @	0.16 %
327	42" SS X	84.0' @	0.08 %
328	18" SS X	17.3' @	0.58 %
329	42" SS X	52.9' @	0.13 %
330	42" SS X	3.4' @	1.18 %
331	42" SS X	22.2' @	0.18 %
332	12" SS X	4.3' @	2.33 %
333	12" SS X	3.7' @	2.70 %
334	42" SS X	84.0' @	0.48 %
335	12" SS X	5.1' @	1.96 %
336	12" SS X	5.1' @	1.96 %
337	42" SS X	3.5' @	0.29 %

STORM SEWER SCHEDULE

SEGMENT	SIZE	LENGTH	GRADE
338	42" SS X	6.9' @	0.43 %
339	42" SS X	6.4' @	0.63 %
340	42" SS X	43.4' @	0.32 %
341	12" SS X	48.2' @	0.58 %
342	42" SS X	182.7' @	0.54 %
343	42" SS X	8.2' @	0.49 %
344	42" SS X	57.9' @	0.54 %
345	42" SS X	3.0' @	0.33 %
346	12" SS X	11.7' @	1.71 %
347	12" SS X	13.8' @	0.80 %
348	42" SS X	164.7' @	0.53 %
349	12" SS X	65.0' @	0.48 %
350	12" SS X	3.0' @	0.67 %
351	42" SS X	166.2' @	0.52 %
352	12" SS X	64.0' @	0.48 %
353	12" SS X	3.0' @	0.67 %
354	42" SS X	165.6' @	0.52 %
355	12" SS X	64.0' @	0.48 %
356	12" SS X	3.0' @	0.67 %
357	42" SS X	166.2' @	0.52 %

REVISIONS	
NAME	DATE

ILLINOIS DEPARTMENT OF TRANSPORTATION

DRAINAGE PLAN

STA. 858 + 00 TO STA. 873 + 00

SCALE: VERT. 1"=50'
HORIZ. 1"=50'

DATE: 7/3/2012

DRAWN BY: RLH
CHECKED BY: MED

TUG PROJ. 1318504
PLOT DATE: 7/3/2012
FILE NAME: I:\1318504\1318504.dwg