

| | | | | |
|---------------------|---------|---------------------------|--------------|-----------|
| CONTRACT NO. 66420 | | | | |
| F.A.P. RTE. | SECTION | COUNTY | TOTAL SHEETS | SHEET NO. |
| 311 | (1-1)R | KENDALL | 514 | 261 |
| STA. 888+00 | | TO STA. 903+00 | | |
| FED. ROAD DIST. NO. | | ILLINOIS FED. AID PROJECT | | |

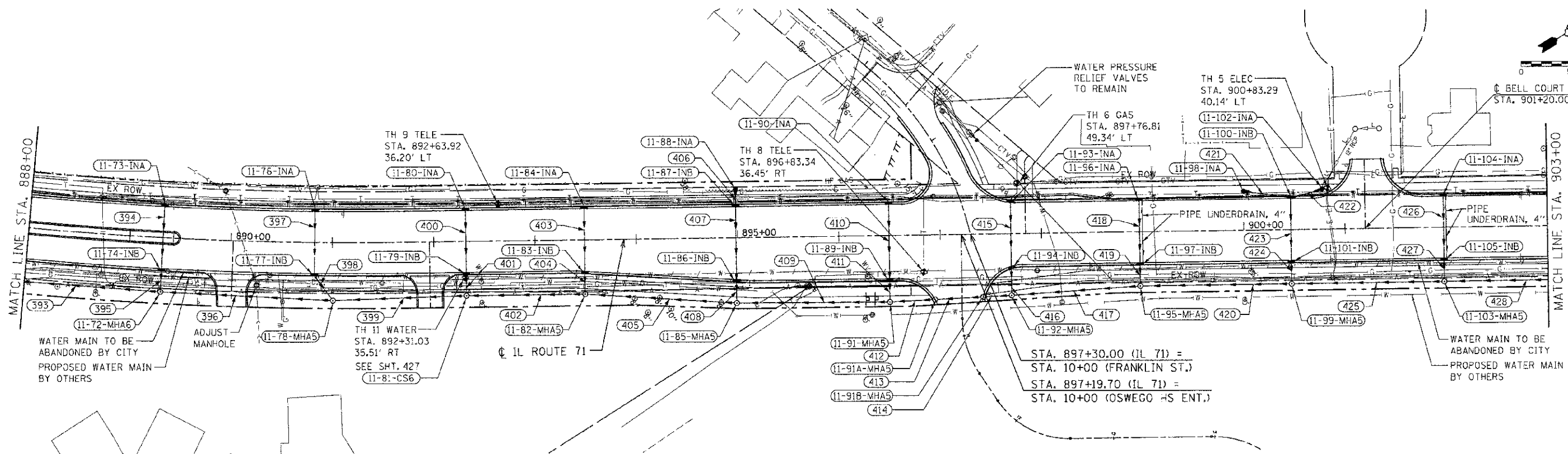

DRAINAGE STRUCTURE SCHEDULE

| STRUCTURE NUMBER | STATION | OFFSET | ROUTE | STRUCTURE TYPE | CASTING | RIM ELEVATION | NORTH INVERT | SOUTH INVERT | EAST INVERT | WEST INVERT | COMMENTS |
|------------------|-----------|------------|-------|--------------------------------|--------------------------|---------------|--------------|--------------|-------------|-------------|--|
| 11-72-MH A | 889+32.71 | 53.44' RT. | | MANHOLE, TYPE A, 6' DIAMETER | TYPE 1 FRAME, CLOSED LID | 661.40 | 656.82 | | | | |
| 11-73-IN A | 889+32.79 | 30.50' LT. | | INLET, TYPE A | TYPE 24 FRAME AND GRATE | 661.24 | | 657.24 | | | |
| 11-74-IN B | 889+32.79 | 30.50' RT. | | INLET, TYPE B | TYPE 24 FRAME AND GRATE | 661.24 | 657.01 | 656.91 | | | |
| 11-76-IN A | 890+82.58 | 30.50' LT. | | INLET, TYPE A | TYPE 24 FRAME AND GRATE | 661.99 | | 658.00 | | | |
| 11-77-IN B | 890+82.58 | 30.50' RT. | | INLET, TYPE B | TYPE 24 FRAME AND GRATE | 661.99 | 657.77 | 657.67 | | | |
| 11-78-MH A | 891+00.86 | 57.16' RT. | | MANHOLE, TYPE A, 5' DIAMETER | TYPE 8 GRATE | 660.80 | 657.55 | | 648.92 | 648.92 | SEE TEMPORARY DRAINAGE SPECIAL PROVISION |
| 11-79-IN B | 892+31.79 | 30.50' RT. | | INLET, TYPE B | TYPE 24 FRAME AND GRATE | 662.74 | | 658.42 | | | |
| 11-80-IN A | 892+31.79 | 30.50' LT. | | INLET, TYPE A | TYPE 24 FRAME AND GRATE | 662.74 | | 658.74 | | | |
| 11-81-CS6 | 892+31.83 | 53.47' RT. | | CONTROL STRUCTURE, 6' DIAMETER | TYPE 1 FRAME, CLOSED LID | 662.43 | 658.34 | | 653.52 | 649.45 | |
| 11-82-MH A | 893+48.91 | 53.50' RT. | | MANHOLE, TYPE A, 5' DIAMETER | TYPE 1 FRAME, CLOSED LID | 663.30 | 658.91 | | 653.89 | 653.89 | SEE TEMPORARY DRAINAGE SPECIAL PROVISION |
| 11-83-IN B | 893+48.91 | 31.08' RT. | | INLET, TYPE B | TYPE 24 FRAME AND GRATE | 663.31 | 659.10 | 659.00 | | | |
| 11-84-IN A | 893+48.91 | 30.50' LT. | | INLET, TYPE A | TYPE 24 FRAME AND GRATE | 663.32 | | 659.33 | | | |
| 11-85-MH A | 894+98.44 | 64.37' RT. | | MANHOLE, TYPE A, 5' DIAMETER | TYPE 1 FRAME, CLOSED LID | 663.30 | 659.49 | | 654.58 | 654.58 | |
| 11-86-IN B | 894+98.44 | 41.32' RT. | | INLET, TYPE B | TYPE 24 FRAME AND GRATE | 663.80 | 659.66 | 659.56 | | | |
| 11-87-IN B | 894+98.44 | 30.50' LT. | | INLET, TYPE B | TYPE 24 FRAME AND GRATE | 664.07 | 660.00 | 659.98 | | | |
| 11-88-IN A | 894+98.55 | 47.45' LT. | | INLET, TYPE A | TYPE 8 GRATE | 662.80 | | 660.08 | | | |
| 11-89-IN B | 896+49.52 | 42.50' RT. | | INLET, TYPE B | TYPE 24 FRAME AND GRATE | 664.53 | 660.51 | 660.41 | | | |
| 11-90-IN A | 896+49.52 | 30.50' LT. | | INLET, TYPE A | TYPE 24 FRAME AND GRATE | 664.83 | | 660.83 | | | |
| 11-91-MH A | 896+49.52 | 65.50' RT. | | MANHOLE, TYPE A, 5' DIAMETER | TYPE 1 FRAME, CLOSED LID | 664.47 | 660.33 | | 655.18 | 655.18 | |
| 11-91A-MH A | 896+84.04 | 63.78' RT. | | MANHOLE, TYPE A, 5' DIAMETER | TYPE 24 FRAME AND GRATE | 664.09 | | 655.36 | 655.36 | | |
| 11-91B-MH A | 897+41.62 | 61.94' RT. | | MANHOLE, TYPE A, 5' DIAMETER | TYPE 24 FRAME AND GRATE | 664.16 | | 655.58 | 655.58 | | |
| 11-92-MH A | 897+69.78 | 60.85' RT. | | MANHOLE, TYPE A, 5' DIAMETER | TYPE 1 FRAME, CLOSED LID | 665.40 | 659.93 | | 655.67 | 655.67 | SEE TEMPORARY DRAINAGE SPECIAL PROVISION |
| 11-93-IN A | 897+69.78 | 30.50' LT. | | INLET, TYPE A | TYPE 24 FRAME AND GRATE | 665.43 | | 661.35 | | | |
| 11-94-IN B | 897+69.78 | 32.02' RT. | | INLET, TYPE B | TYPE 24 FRAME AND GRATE | 665.40 | 661.07 | 660.97 | | | |
| 11-95-MH A | 898+97.05 | 53.50' RT. | | MANHOLE, TYPE A, 5' DIAMETER | TYPE 1 FRAME, CLOSED LID | 666.70 | 660.64 | | 656.17 | 656.17 | |
| 11-96-IN A | 898+97.05 | 30.50' LT. | | INLET, TYPE A | TYPE 24 FRAME AND GRATE | 666.06 | | 662.06 | | | |
| 11-97-IN B | 898+97.05 | 30.50' RT. | | INLET, TYPE B | TYPE 24 FRAME AND GRATE | 666.06 | 661.83 | 661.73 | | | |
| 11-98-IN A | 900+00.45 | 38.32' LT. | | INLET, TYPE A | TYPE 8 GRATE | 666.80 | | 662.99 | | | |
| 11-99-MH A | 900+46.54 | 53.50' RT. | | MANHOLE, TYPE A, 5' DIAMETER | TYPE 1 FRAME, CLOSED LID | 667.50 | 662.30 | | 656.78 | 656.78 | |
| 11-100-IN B | 900+46.54 | 30.50' LT. | | INLET, TYPE B | TYPE 24 FRAME AND GRATE | 666.81 | | 662.72 | 662.82 | 662.82 | |
| 11-101-IN B | 900+46.54 | 30.50' RT. | | INLET, TYPE B | TYPE 24 FRAME AND GRATE | 666.81 | 662.49 | 662.39 | | | |
| 11-102-IN A | 900+77.81 | 39.31' LT. | | INLET, TYPE A | TYPE 8 GRATE | 667.24 | | | | 662.93 | |
| 11-103-MH A | 901+97.46 | 53.50' RT. | | MANHOLE, TYPE A, 5' DIAMETER | TYPE 1 FRAME, CLOSED LID | 668.60 | 663.18 | | 657.38 | 657.38 | |
| 11-104-IN A | 901+97.46 | 30.50' LT. | | INLET, TYPE A | TYPE 24 FRAME AND GRATE | 667.57 | | 663.60 | | | |
| 11-105-IN B | 901+97.46 | 30.50' RT. | | INLET, TYPE B | TYPE 24 FRAME AND GRATE | 667.57 | 663.37 | 663.27 | | | |

STORM SEWER SCHEDULE

| SEGMENT | SIZE | LENGTH | GRADE |
|---------|----------|--------|---------|
| 393 | 42" SS X | 146.3' | @ 0.41% |
| 394 | 12" SS X | 61.0' | @ 0.38% |
| 395 | 12" SS X | 16.0' | @ 0.58% |
| 396 | 36" SS X | 165.2' | @ 0.41% |
| 397 | 12" SS X | 61.0' | @ 0.38% |
| 398 | 12" SS X | 26.0' | @ 0.46% |
| 399 | 36" SS X | 126.6' | @ 0.42% |
| 400 | 12" SS X | 61.0' | @ 0.36% |
| 401 | 12" SS X | 10.0' | @ 0.50% |
| 402 | 36" SS X | 111.6' | @ 0.33% |
| 403 | 12" SS X | 61.6' | @ 0.37% |
| 404 | 12" SS X | 15.9' | @ 0.57% |
| 405 | 36" SS X | 144.9' | @ 0.48% |
| 406 | 12" SS X | 11.9' | @ 0.67% |
| 407 | 12" SS X | 71.8' | @ 0.45% |
| 408 | 12" SS X | 16.5' | @ 0.42% |
| 409 | 36" SS X | 146.1' | @ 0.41% |
| 410 | 12" SS X | 73.0' | @ 0.44% |
| 411 | 12" SS X | 16.5' | @ 0.48% |

STORM SEWER SCHEDULE

| SEGMENT | SIZE | LENGTH | GRADE |
|---------|----------|--------|---------|
| 412 | 36" SS X | 39.5' | @ 0.43% |
| 413 | 36" SS X | 42.6' | @ 0.42% |
| 414 | 36" SS X | 23.2' | @ 0.43% |
| 415 | 12" SS X | 62.6' | @ 0.45% |
| 416 | 12" SS X | 22.3' | @ 4.39% |
| 417 | 36" SS X | 122.5' | @ 0.41% |
| 418 | 12" SS X | 61.0' | @ 0.38% |
| 419 | 12" SS X | 16.5' | @ 6.61% |
| 420 | 36" SS X | 144.5' | @ 0.42% |
| 421 | 12" SS X | 43.7' | @ 0.39% |
| 422 | 12" SS X | 29.5' | @ 0.37% |
| 423 | 12" SS X | 61.0' | @ 0.38% |
| 424 | 12" SS X | 16.5' | @ 0.55% |
| 425 | 36" SS X | 145.9' | @ 0.41% |
| 426 | 12" SS X | 61.0' | @ 0.38% |
| 427 | 12" SS X | 16.5' | @ 0.55% |

| REVISIONS | |
|-----------|------|
| NAME | DATE |
| | |
| | |
| | |
| | |
| | |
| | |
| | |
| | |
| | |

ILLINOIS DEPARTMENT OF TRANSPORTATION
DRAINAGE PLAN
STA. 888 + 00 TO STA. 903 + 00
 SCALE: VERT. 1"=50'
 HORIZ. 1"=50'
 DATE 7/5/2012
 DRAWN BY RLH
 CHECKED BY MED

TUC PROJ. #108914
 DATE 7/5/2012
 FILE NAME I:\proj\11_08_11\11-08-11-001-001\11-08-11-001-001.dwg