

F.A.P. RTE.	SECTION	COUNTY	TOTAL SHEETS	SHEET NO.
311	11-11R	KENDALL	514	311
STA. 862+00		TO STA. 868+00		
FED. ROAD DIST. NO.		ILLINOIS FED. AID PROJECT		

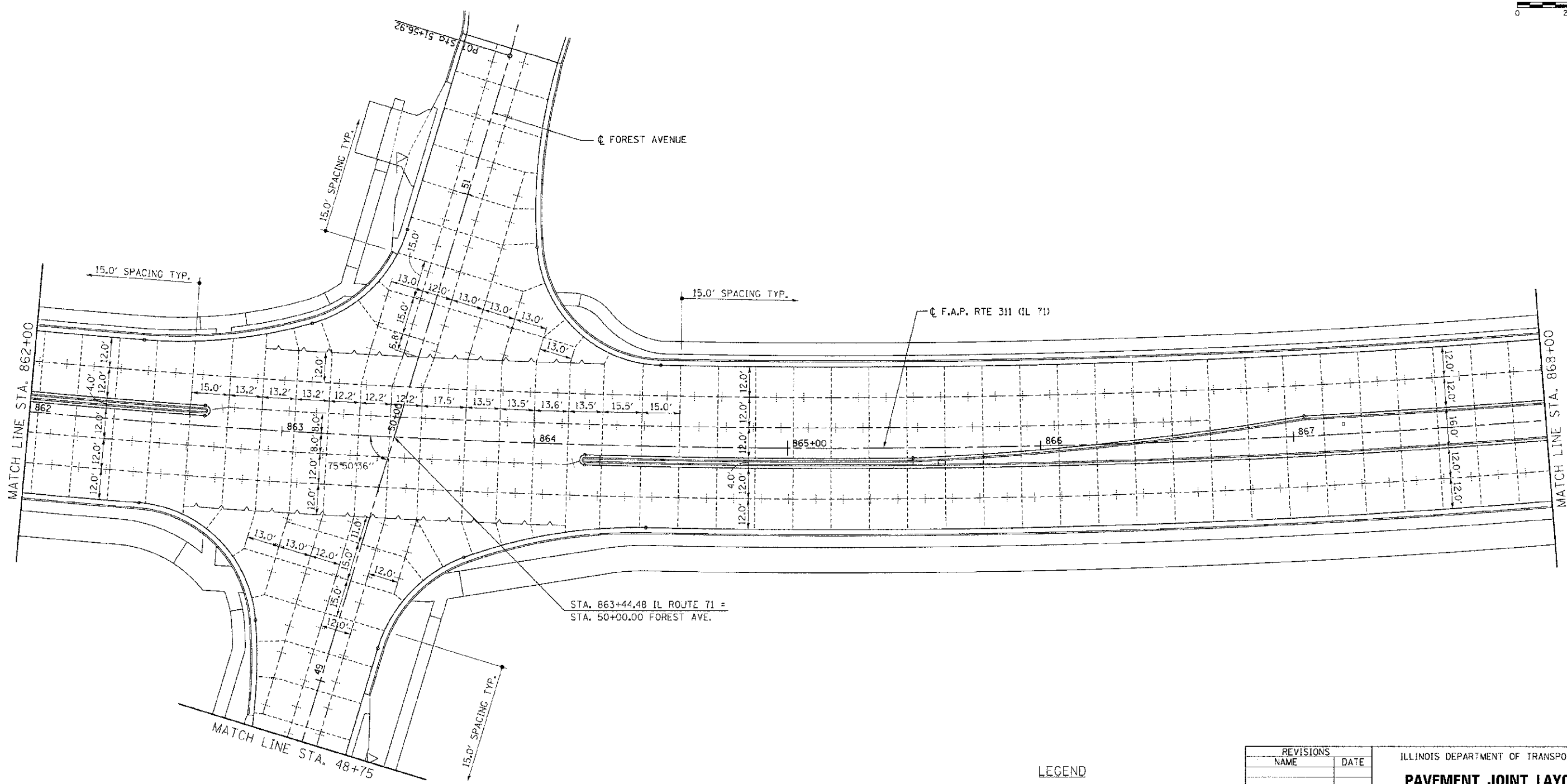
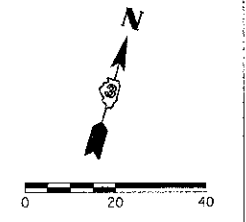

- LEGEND**
- KEYED CONSTRUCTION JOINT
 - SAWED LONGITUDINAL JOINT OR LONGITUDINAL CONSTRUCTION JOINT
 - TRANSVERSE SAWED CONTRACTION JOINT

REVISIONS	
NAME	DATE

ILLINOIS DEPARTMENT OF TRANSPORTATION
PAVEMENT JOINT LAYOUT
IL RTE 71
STA 862+00 TO STA 868+00

SCALE: VERT. 1"=20'
 HORIZ. 1"=20'
 DATE 7/5/2012

DRAWN BY SAE
 CHECKED BY MED

TUG PREL. 430584
 PLOT DATE 7/5/2012
 FILE NAME: p:\projects\11-11r\11-11r.dwg