

CONTRACT NO. 66420				
F.A.P. RTE:	SECTION	COUNTY	TOTAL SHEETS	SHEET NO.
311	41-1R	KENDALL	514	315
STA. 896+00		TO STA. 908+00		
FED. ROAD DIST. NO.		ILLINOIS FED. AID PROJECT		

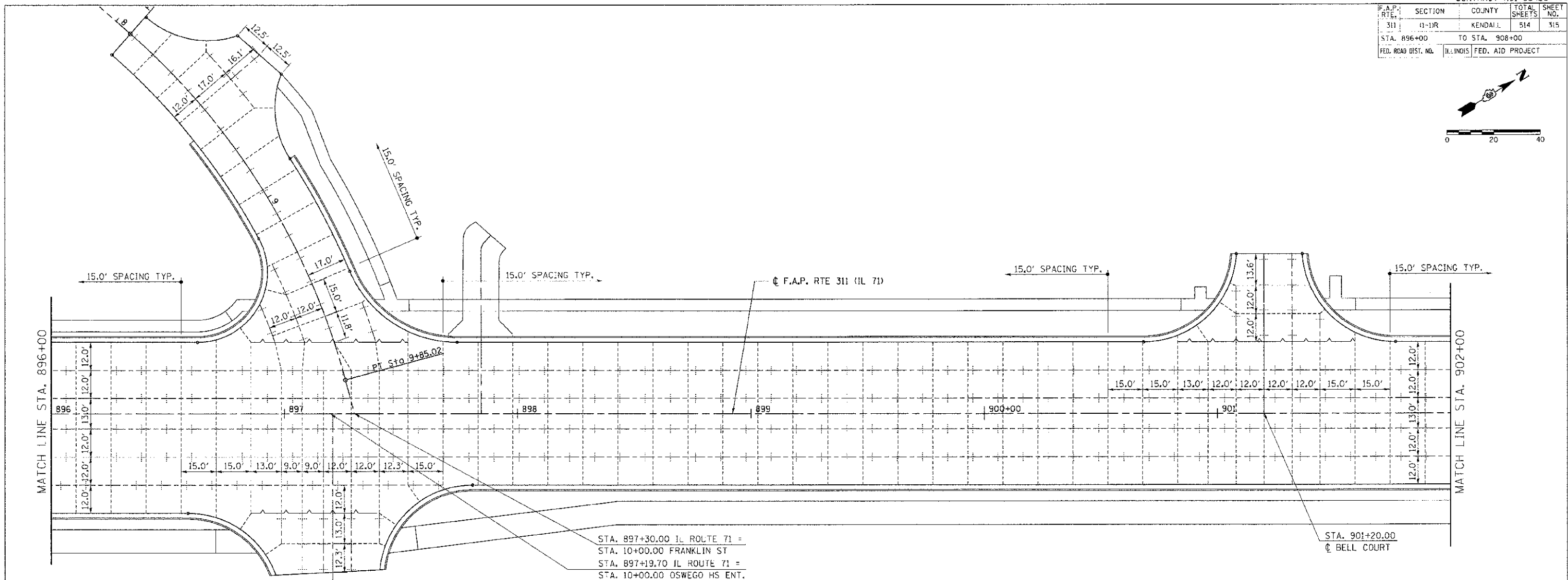

STA. 897+30.00 IL ROUTE 71 =  
 STA. 10+00.00 FRANKLIN ST  
 STA. 897+19.70 IL ROUTE 71 =  
 STA. 10+00.00 OSWEGO HS ENT.

STA. 901+20.00  
 BELL COURT

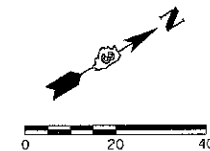
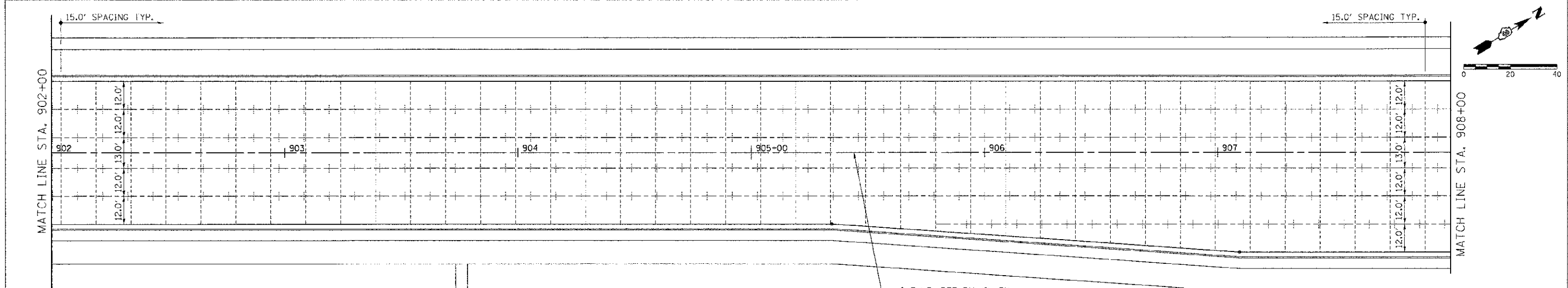

F.A.P. RTE 311 (IL 71)

**LEGEND**

- KEYED CONSTRUCTION JOINT
- SAWED LONGITUDINAL JOINT OR LONGITUDINAL CONSTRUCTION JOINT
- TRANSVERSE SAWED CONTRACTION JOINT

REVISIONS	
NAME	DATE

ILLINOIS DEPARTMENT OF TRANSPORTATION  
**PAVEMENT JOINT LAYOUT**  
**IL RTE 71**  
**STA 896+00 TO STA 908+00**  
 SCALE: VERT. 1"=20'  
 HORIZ. 1"=20'  
 DATE 7/5/2012  
 DRAWN BY SAF  
 CHECKED BY MED

TUG PROJ. #310584  
 PLOT DATE = 7/5/2012  
 FILE NAME = p:\civil\1\dot.dwg\oswego\phase 1\Plan-Js-12.dgn