

F.A.P. RTE.	SECTION	COUNTY	TOTAL SHEETS	SHEET NO.
311	(1-1)R	KENDALL	514	323
STA. 795+00		TO STA. 801+00		
FED. ROAD DIST. NO.		ILLINOIS FED. AID PROJECT		

800+75.81
803.00' LT
RAD. PT.

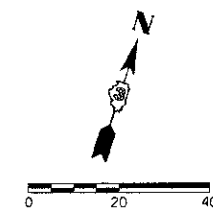

806+53.18
52.09' LT
RAD. PT.

750' - 85' - 750' RAD.
O/S = 5'

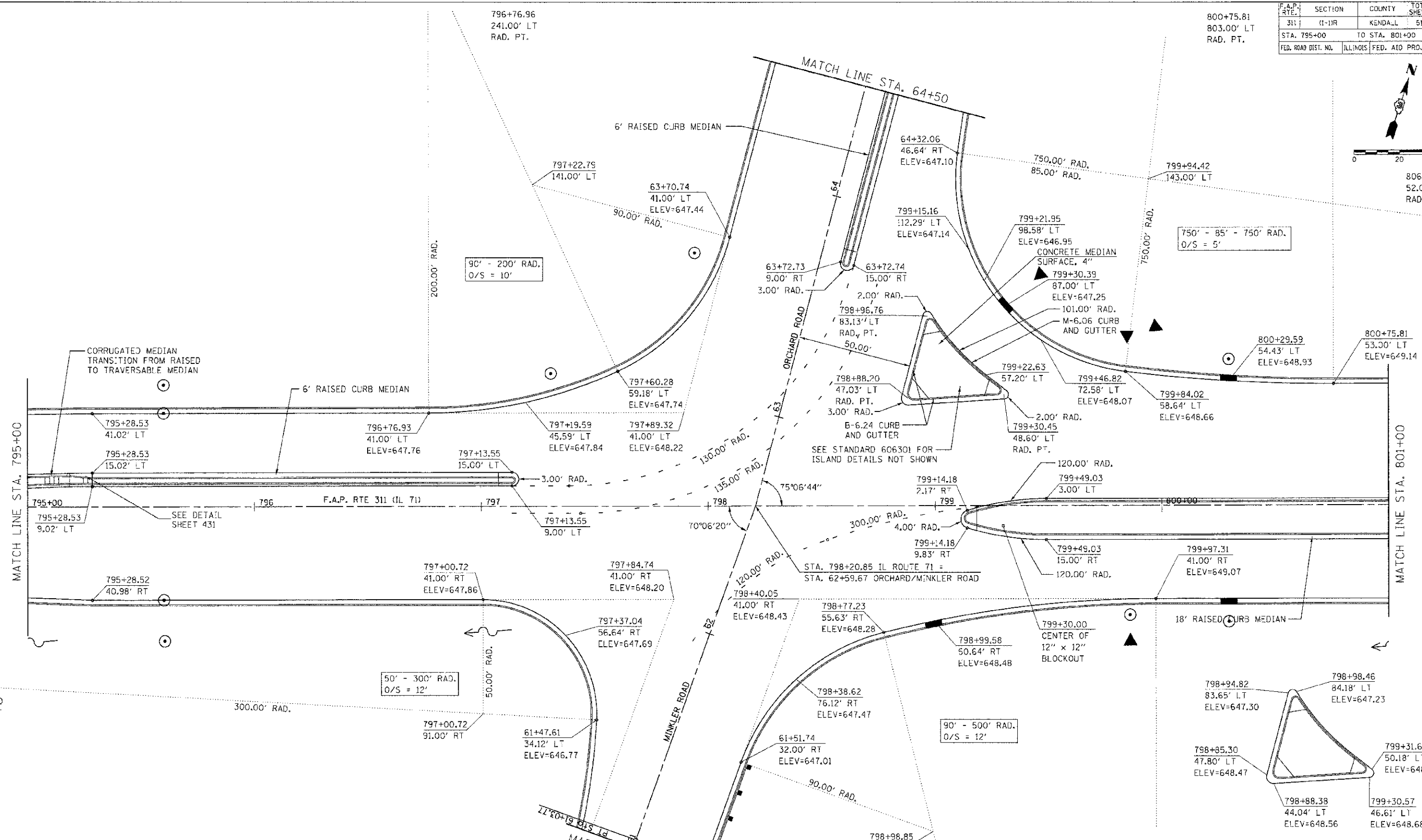

NOTES:

- FOR ADDITIONAL DETAILS, SEE JOINTING PLANS, SIGNING AND STRIPING PLANS, AND TRAFFIC SIGNAL PLANS.

REVISIONS	
NAME	DATE

ILLINOIS DEPARTMENT OF TRANSPORTATION
INTERSECTION DETAIL
ORCHARD / MINKLER
STA. 795 + 00 TO STA. 801 + 00

SCALE: VERT. 1"=20'
HORIZ. 1"=20'
DATE 7/5/2012
DRAWN BY SAE
CHECKED BY MED

TUG PROJ. #3102314
PLOT DATE # 7/5/2012
FILE NAME # p:\work\11...dbt.dwg\3102314\ortho\ortho.dwg