

F.A.P. RTE.	SECTION	COUNTY	TOTAL SHEETS	SHEET NO.
311	(1-1)R	KENDALL	514	326
STA. 816+00 TO STA. 822+50			ILLINOIS FED. AID PROJECT	

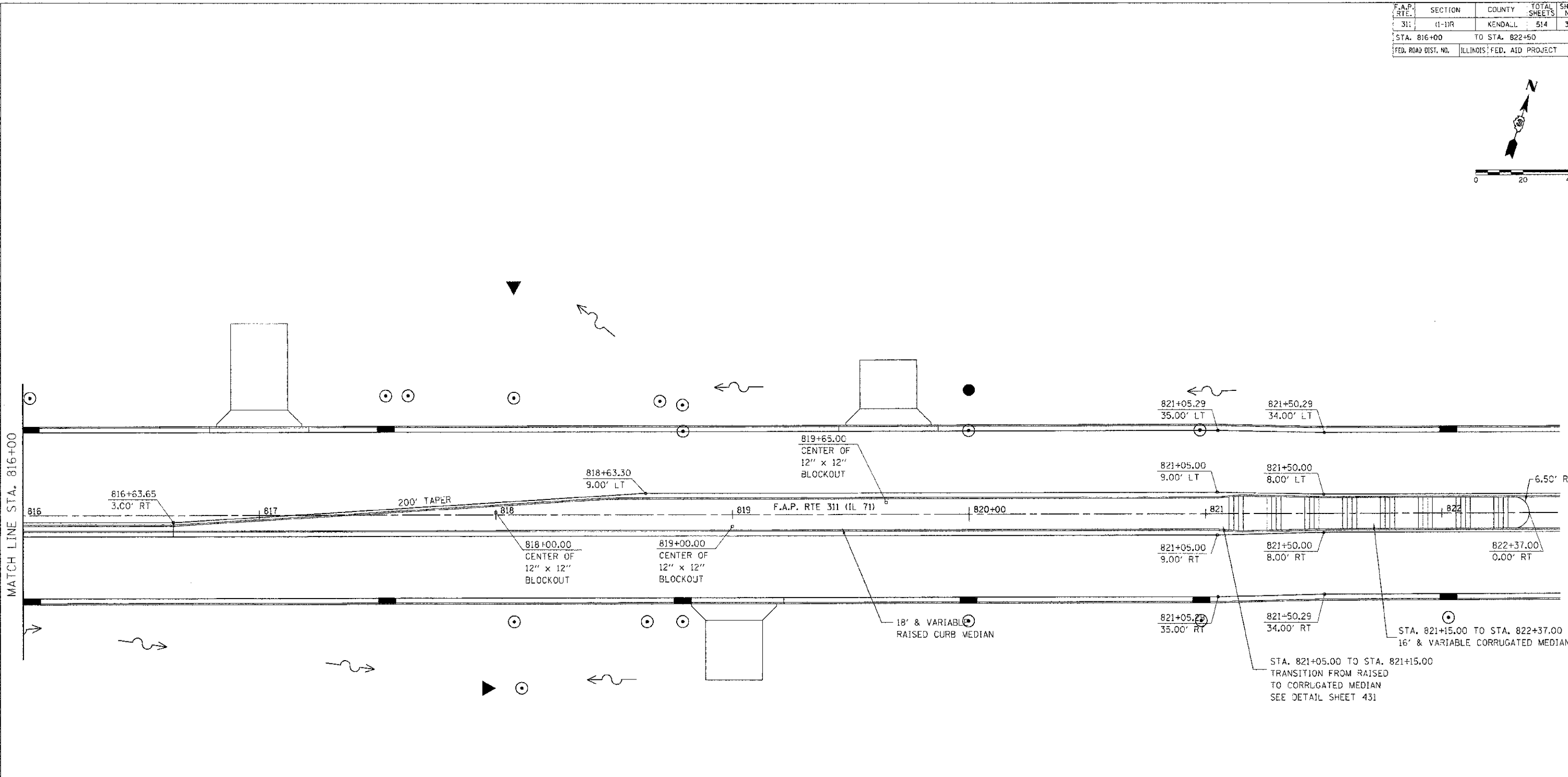
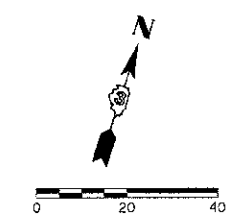

NOTES:

- FOR ADDITIONAL DETAILS, SEE JOINTING PLANS, SIGNING AND STRIPING PLANS, AND TRAFFIC SIGNAL PLANS.

REVISIONS	
NAME	DATE

ILLINOIS DEPARTMENT OF TRANSPORTATION
INTERSECTION DETAIL
COMMERCIAL ENTRANCE
STA. 816 + 00 TO STA. 822 + 50

SCALE: VERT. 1"=20'
 HORIZ. 1"=20'
 DATE 7/5/2012
 DRAWN BY SAE
 CHECKED BY MED

TUG PROJ: 13105814
 PLOT DATE: 7/5/2012
 FILE NAME: p:\nover\1\...doc.dwg