

F.A.P. RTE.	SECTION	COUNTY	TOTAL SHEETS	SHEET NO.
311	01-11R	KENDALL	514	343
STA. 893+00		TO STA. 899+00		
FED. ROAD DIST. NO. ILLINOIS FED. AID PROJECT				

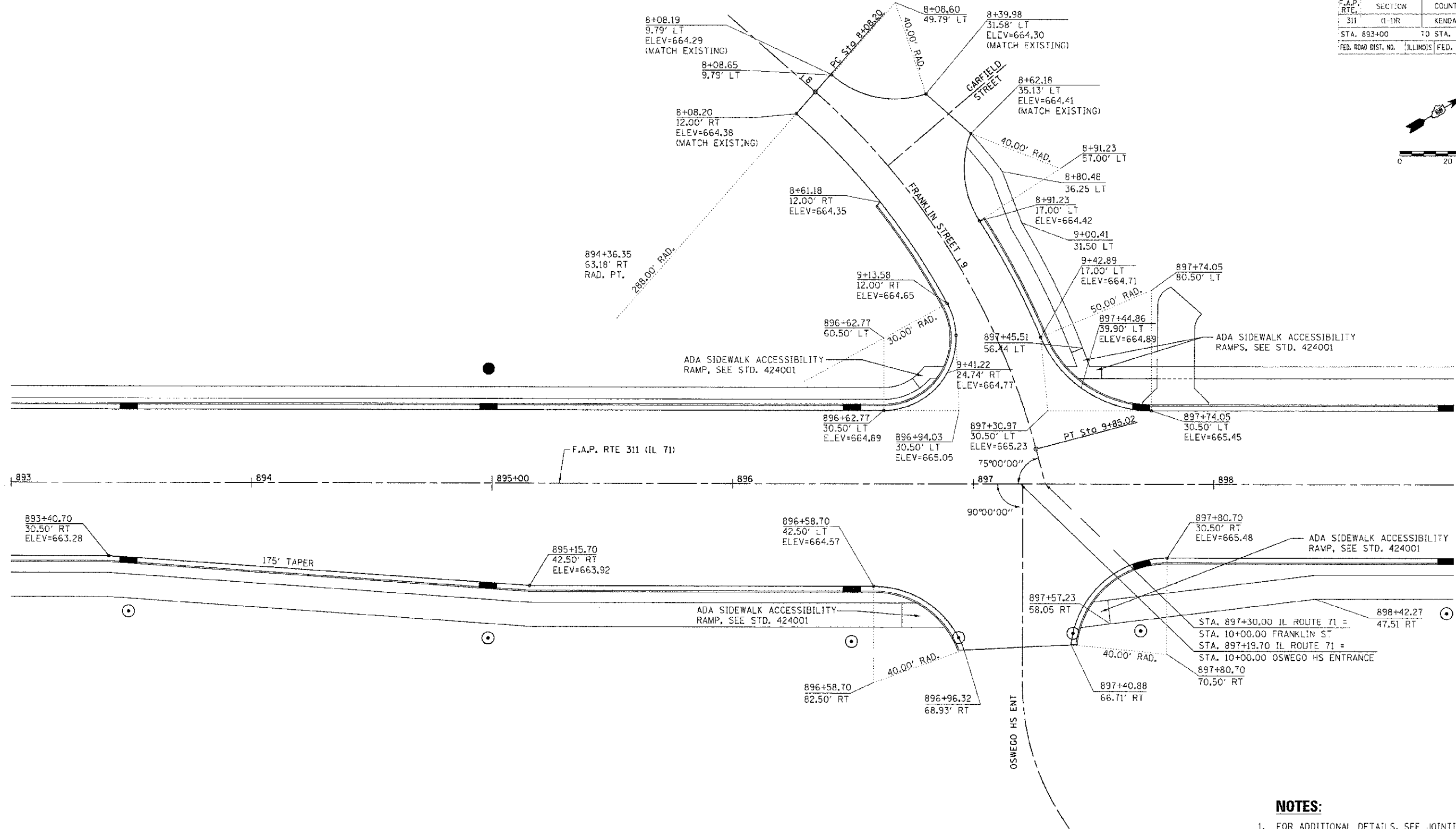
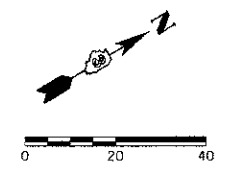

NOTES:

- FOR ADDITIONAL DETAILS, SEE JOINTING PLANS, SIGNING AND STRIPING PLANS, AND TRAFFIC SIGNAL PLANS.
- ADJUST PAVEMENT GRADES THROUGH CROSS WALKS TO A MAXIMUM OF 2% CROSS SLOPE.

REVISIONS	
NAME	DATE

ILLINOIS DEPARTMENT OF TRANSPORTATION
INTERSECTION DETAIL
FRANKLIN ST / OSWEGO HS ENT
STA. 893+00 TO STA. 899+00

SCALE: VERT. 1"=20'
 HORIZ. 1"=20'
 DATE 7/5/2012

DRAWN BY SAE
 CHECKED BY MED

TUG PROJ. #1009014
 DATE = 7/5/2012
 FILE NAME = p:\work\1009014\1009014.dwg