

F.A.P. NO.	SECTION	COUNTY	TOTAL SHEET NO.
311	(1-1)R	KENDALL	514 / 380
STA.	10 STA.		
FED. ROAD DIST. NO.	ILLINOIS FED. AID PROJECT		

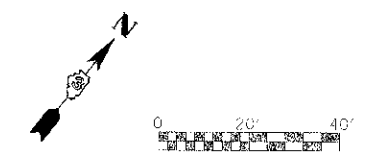

TEMPORARY TRAFFIC SIGNAL LEGEND

- TEMPORARY TRAFFIC SIGNAL CONTROLLER
- TEMPORARY SERVICE INSTALLATION
- TEMPORARY SIGNAL HEAD
- TEMPORARY SIGNAL HEAD, PEDESTRIAN, BRACKET MOUNTED
- TEMPORARY WOOD POLE (CLASS 5 OR BETTER) 45 FOOT MINIMUM
- TEMPORARY SPAN WIRE, TETHER WIRE AND CABLE
- TEMPORARY PEDESTRIAN PUSHBUTTON DETECTOR
- TEMPORARY VIDEO DETECTION CAMERA

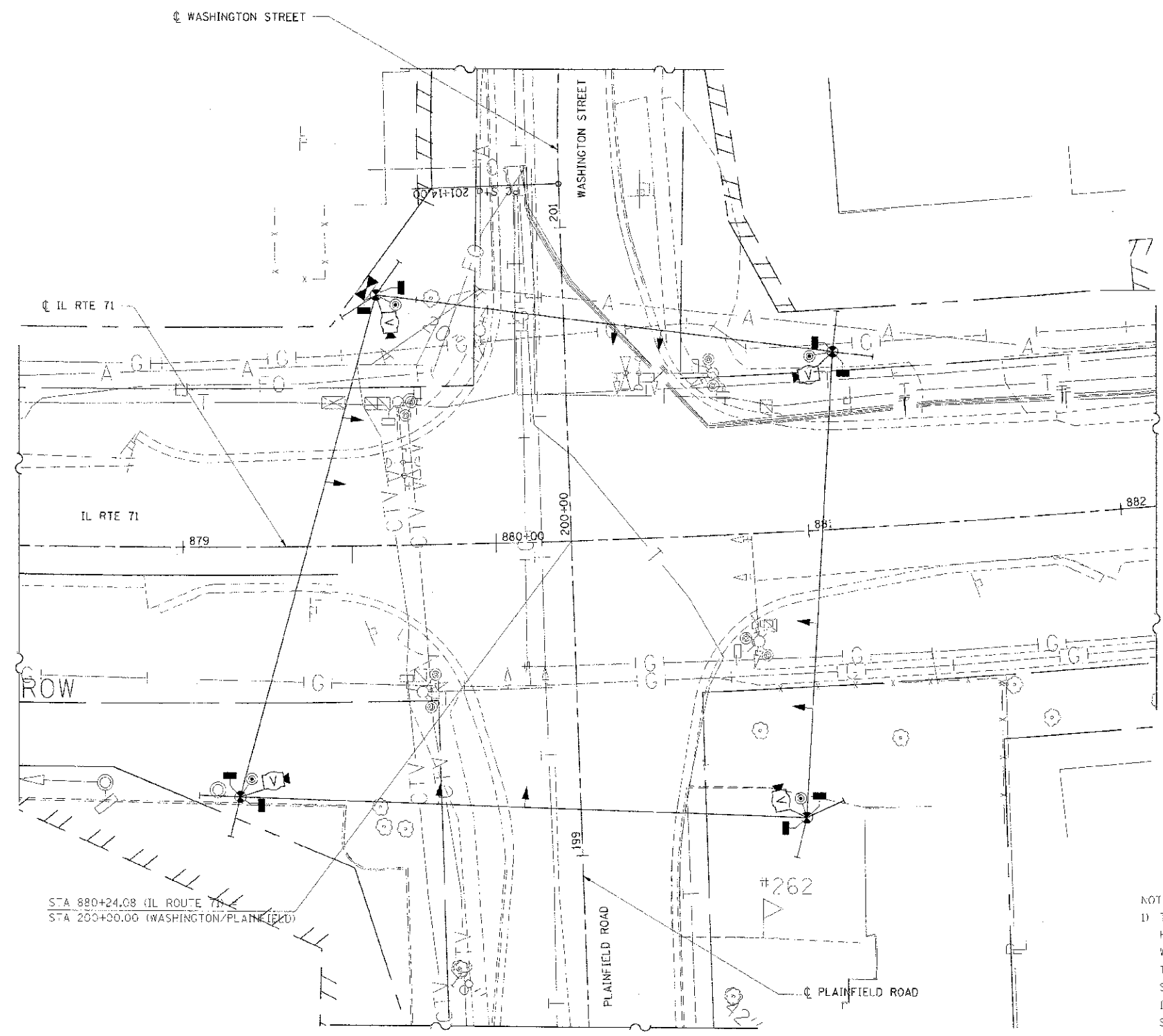

TRAFFIC SIGNAL REMOVAL NOTES

THE FOLLOWING EQUIPMENT SHALL BE REMOVED BY THE CONTRACTOR AND SHALL REMAIN THE PROPERTY OF THE STATE:

- 1 EACH - CONTROLLER CABINET (COMPLETE)
- 2 EACH - LIGHT DETECTORS (WITH CONFIRMATION BEACONS)
- 1 EACH - LIGHT DETECTOR AMPLIFIER
- 4 EACH - HANDHOLE COVERS

THE FOLLOWING EQUIPMENT SHALL BE STOCKPILED IN A SECURE LOCATION BY THE CONTRACTOR FOR PICKUP BY THE VILLAGE:

- 4 EACH - SIGNAL HEAD, 1-FACE 3-SECTION
- 10 EACH - SIGNAL HEAD, 1-FACE 5-SECTION
- 14 EACH - TRAFFIC SIGNAL BACKPLATE
- 8 EACH - PEDESTRIAN SIGNAL HEAD, 1-FACE, 2 SECTION
- 8 EACH - PEDESTRIAN PUSHBUTTON

THE FOLLOWING EQUIPMENT SHALL BE REMOVED BY THE CONTRACTOR AND SHALL BE DISPOSED OF BY THEM OUTSIDE THE RIGHT-OF-WAY AT THEIR EXPENSE.

- 4 EACH - STEEL MAST ARM AND POLE
- 1 EACH - SIGNAL POST
- 4 EACH - HANDHOLE
- 6 EACH - CONCRETE FOUNDATION
- 1 EACH - SERVICE INSTALLATION

NOTE:
 1) THE LOCATION OF THE SIGNAL HEADS ON THE SPAN WIRE ARE SHOWN HERE FOR REFERENCE ONLY. THE LOCATION OF THE TEMPORARY SIGNALS WILL CHANGE DURING DIFFERENT MAINTENANCE OF TRAFFIC PHASES. THE SHIFTING OF THESE SIGNAL HEADS SHALL NOT BE PAID FOR SEPARATELY, BUT SHALL BE CONSIDERED INCIDENTAL TO THE PAY ITEM "TEMPORARY TRAFFIC SIGNAL INSTALLATION". THE CONTRACTOR SHALL ALIGN THE SIGNAL HEADS WITH THE CENTER OF EACH TEMPORARY LANE DETAILED IN THE MAINTENANCE OF TRAFFIC PLANS.

REVISIONS	
NAME	DATE
BDD	8-6-12

ILLINOIS DEPARTMENT OF TRANSPORTATION
TEMPORARY TRAFFIC SIGNAL PLAN
IL RTE 71
WASHINGTON ST./ PLAINFIELD RD

SCALE: 1"=20'
 DATE: 7/9/2012
 DRAWN BY: NMR
 CHECKED BY: DJL

EXISTING EQUIPMENT TO BE REMOVED LEGEND

- EXISTING TRAFFIC SIGNAL CONTROLLER AND FOUNDATION
- EXISTING SERVICE INSTALLATION
- EXISTING SIGNAL HEAD WITH BACKPLATE
- EXISTING SIGNAL HEAD, PEDESTRIAN
- EXISTING SIGNAL POST
- EXISTING MAST ARM ASSEMBLY AND POLE, STEEL
- EXISTING MAST ARM ASSEMBLY AND POLE, STEEL WITH LUMINAIRE
- EXISTING HANDHOLE
- EXISTING HEAVY DUTY HANDHOLE
- EXISTING DOUBLE HANDHOLE
- EXISTING PEDESTRIAN PUSHBUTTON DETECTOR
- EXISTING WOOD POLE
- EXISTING LUMINAIRE
- EXISTING LIGHTING CONTROLLER
- EXISTING EMERGENCY VEHICLE LIGHT DETECTOR
- EXISTING LIGHTING CONTROLLER

STA 880+24.08 (IL ROUTE 71)
 STA 200+00.00 (WASHINGTON/PLAINFIELD)

PLOT DATE: 8/7/2012
 FILE NAME: c:\pwworkspace\pwworkspace\11111111\11111111.dwg
 PLOT SCALE: 1"=20'