

F.A.P. RTE.	SECTION	COUNTY	TOTAL SHEETS	SHEET NO.
311	(1-1)R	KENDALL	514	398
STA.		TO STA.		
FED. ROAD DIST. NO.		ILLINOIS FED. AID PROJECT		

**INTERCONNECT PLAN LEGEND**

- |          |          |                           |
|----------|----------|---------------------------|
| EXISTING | PROPOSED |                           |
|          |          | CONTROLLER CABINET        |
|          |          | CONDUIT                   |
|          |          | HANDHOLE                  |
|          |          | DOUBLE HANDHOLE           |
|          |          | DETECTOR LOOP             |
|          |          | TRAFFIC SIGNAL FOUNDATION |

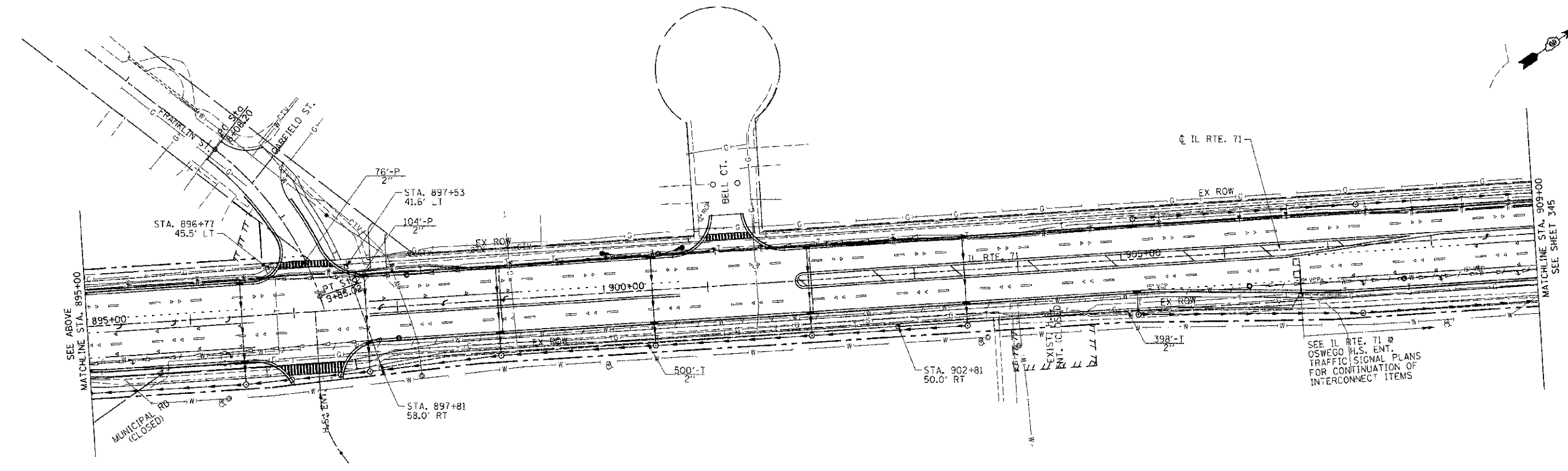
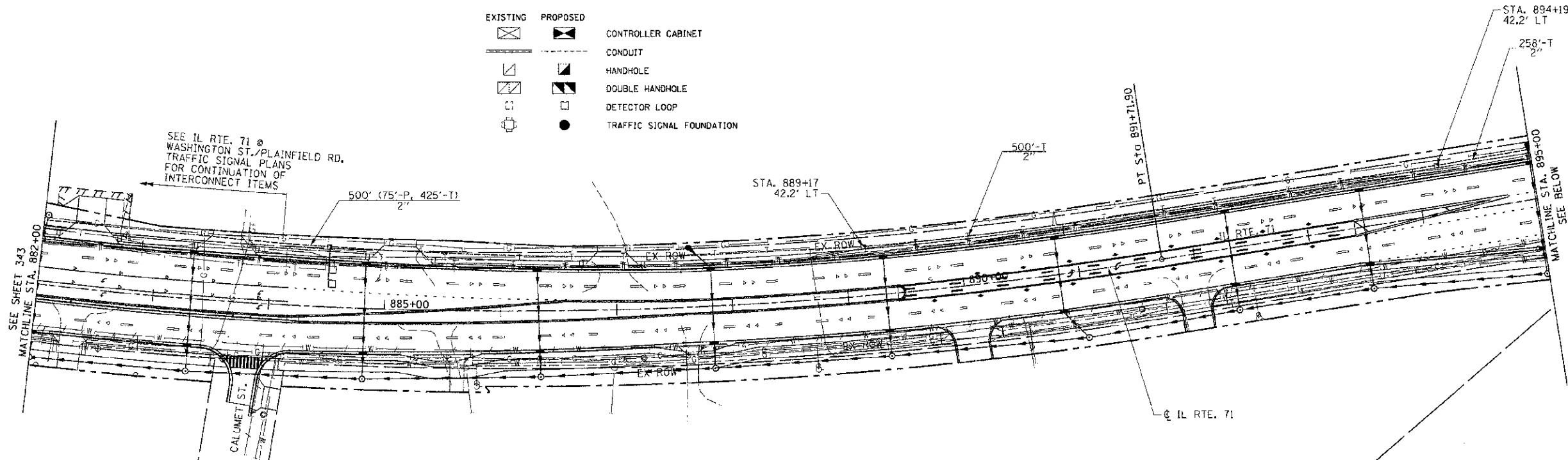

REVISIONS	
NAME	DATE

ILLINOIS DEPARTMENT OF TRANSPORTATION

**IL ROUTE 71  
INTERCONNECT PLAN  
SHEET 4 OF 5**

SCALE: 1"=50'  
DATE: 7/9/2012

DRAWN BY NMR  
CHECKED BY DJL

PLOT DATE = 7/9/2012  
FILE NAME = p:\envi1\...  
PLOT SCALE = 1"=50'