

DATE: 7/6/2012
 SURVEYED: []
 PLOTTED: []
 NOTE BOOK: []
 AREAS CORRECTED: []

DATE: 7/6/2012
 SURVEYED: []
 PLOTTED: []
 NOTE BOOK: []
 AREAS CORRECTED: []

DATE: 7/6/2012
 SURVEYED: []
 PLOTTED: []
 NOTE BOOK: []
 AREAS CORRECTED: []

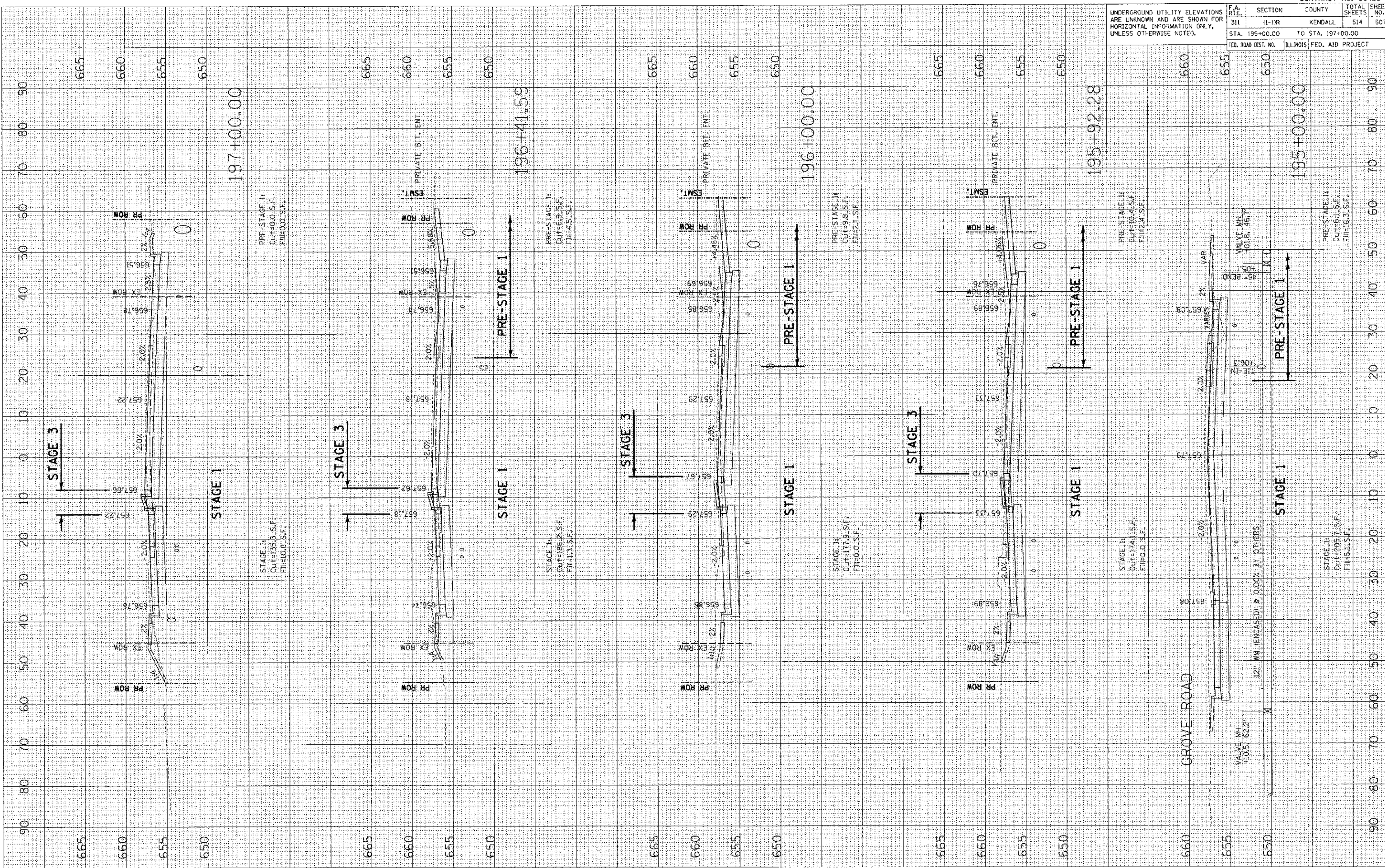

CONTRACT NO. 66420	
F.A. R.T.E.	SECTION
311	(I-1)R
COUNTY	
KENDALL	
TOTAL SHEETS	
514	
507	
STA. 195+00.00 TO STA. 197+00.00	
FED. ROAD DIST. NO.	ILLINOIS FED. AID PROJECT

UNDERGROUND UTILITY ELEVATIONS ARE UNKNOWN AND ARE SHOWN FOR HORIZONTAL INFORMATION ONLY, UNLESS OTHERWISE NOTED.

STAGE 1: Cut=0.0 S.F., Fill=0.0 S.F.

STAGE 2: Cut=10.4 S.F., Fill=2.4 S.F.

STAGE 3: Cut=61.6 S.F., Fill=16.3 S.F.

PRE-STAGE 1: Cut=6.9 S.F., Fill=4.5 S.F.

PRE-STAGE 2: Cut=17.4 S.F., Fill=0.0 S.F.

PRE-STAGE 3: Cut=17.4 S.F., Fill=0.0 S.F.

PRE-STAGE 4: Cut=17.4 S.F., Fill=0.0 S.F.

PRE-STAGE 5: Cut=17.4 S.F., Fill=0.0 S.F.

PRE-STAGE 6: Cut=17.4 S.F., Fill=0.0 S.F.

PRE-STAGE 7: Cut=17.4 S.F., Fill=0.0 S.F.

PRE-STAGE 8: Cut=17.4 S.F., Fill=0.0 S.F.

PRE-STAGE 9: Cut=17.4 S.F., Fill=0.0 S.F.

PRE-STAGE 10: Cut=17.4 S.F., Fill=0.0 S.F.

PRE-STAGE 11: Cut=17.4 S.F., Fill=0.0 S.F.

PRE-STAGE 12: Cut=17.4 S.F., Fill=0.0 S.F.

PRE-STAGE 13: Cut=17.4 S.F., Fill=0.0 S.F.

PRE-STAGE 14: Cut=17.4 S.F., Fill=0.0 S.F.

PRE-STAGE 15: Cut=17.4 S.F., Fill=0.0 S.F.

PRE-STAGE 16: Cut=17.4 S.F., Fill=0.0 S.F.

PRE-STAGE 17: Cut=17.4 S.F., Fill=0.0 S.F.

PRE-STAGE 18: Cut=17.4 S.F., Fill=0.0 S.F.

PRE-STAGE 19: Cut=17.4 S.F., Fill=0.0 S.F.

PRE-STAGE 20: Cut=17.4 S.F., Fill=0.0 S.F.

PRE-STAGE 21: Cut=17.4 S.F., Fill=0.0 S.F.

PRE-STAGE 22: Cut=17.4 S.F., Fill=0.0 S.F.

PRE-STAGE 23: Cut=17.4 S.F., Fill=0.0 S.F.

PRE-STAGE 24: Cut=17.4 S.F., Fill=0.0 S.F.

PRE-STAGE 25: Cut=17.4 S.F., Fill=0.0 S.F.

PRE-STAGE 26: Cut=17.4 S.F., Fill=0.0 S.F.

PRE-STAGE 27: Cut=17.4 S.F., Fill=0.0 S.F.

PRE-STAGE 28: Cut=17.4 S.F., Fill=0.0 S.F.

PRE-STAGE 29: Cut=17.4 S.F., Fill=0.0 S.F.

PRE-STAGE 30: Cut=17.4 S.F., Fill=0.0 S.F.

PRE-STAGE 31: Cut=17.4 S.F., Fill=0.0 S.F.

PRE-STAGE 32: Cut=17.4 S.F., Fill=0.0 S.F.

PRE-STAGE 33: Cut=17.4 S.F., Fill=0.0 S.F.

PRE-STAGE 34: Cut=17.4 S.F., Fill=0.0 S.F.

PRE-STAGE 35: Cut=17.4 S.F., Fill=0.0 S.F.

PRE-STAGE 36: Cut=17.4 S.F., Fill=0.0 S.F.

PRE-STAGE 37: Cut=17.4 S.F., Fill=0.0 S.F.

PRE-STAGE 38: Cut=17.4 S.F., Fill=0.0 S.F.

PRE-STAGE 39: Cut=17.4 S.F., Fill=0.0 S.F.

PRE-STAGE 40: Cut=17.4 S.F., Fill=0.0 S.F.

PRE-STAGE 41: Cut=17.4 S.F., Fill=0.0 S.F.

PRE-STAGE 42: Cut=17.4 S.F., Fill=0.0 S.F.

PRE-STAGE 43: Cut=17.4 S.F., Fill=0.0 S.F.

PRE-STAGE 44: Cut=17.4 S.F., Fill=0.0 S.F.

PRE-STAGE 45: Cut=17.4 S.F., Fill=0.0 S.F.

PRE-STAGE 46: Cut=17.4 S.F., Fill=0.0 S.F.

PRE-STAGE 47: Cut=17.4 S.F., Fill=0.0 S.F.

PRE-STAGE 48: Cut=17.4 S.F., Fill=0.0 S.F.

PRE-STAGE 49: Cut=17.4 S.F., Fill=0.0 S.F.

PRE-STAGE 50: Cut=17.4 S.F., Fill=0.0 S.F.

PRE-STAGE 51: Cut=17.4 S.F., Fill=0.0 S.F.

PRE-STAGE 52: Cut=17.4 S.F., Fill=0.0 S.F.

PRE-STAGE 53: Cut=17.4 S.F., Fill=0.0 S.F.

PRE-STAGE 54: Cut=17.4 S.F., Fill=0.0 S.F.

PRE-STAGE 55: Cut=17.4 S.F., Fill=0.0 S.F.

PRE-STAGE 56: Cut=17.4 S.F., Fill=0.0 S.F.

PRE-STAGE 57: Cut=17.4 S.F., Fill=0.0 S.F.

PRE-STAGE 58: Cut=17.4 S.F., Fill=0.0 S.F.

PRE-STAGE 59: Cut=17.4 S.F., Fill=0.0 S.F.

PRE-STAGE 60: Cut=17.4 S.F., Fill=0.0 S.F.

PRE-STAGE 61: Cut=17.4 S.F., Fill=0.0 S.F.

PRE-STAGE 62: Cut=17.4 S.F., Fill=0.0 S.F.

PRE-STAGE 63: Cut=17.4 S.F., Fill=0.0 S.F.

PRE-STAGE 64: Cut=17.4 S.F., Fill=0.0 S.F.

PRE-STAGE 65: Cut=17.4 S.F., Fill=0.0 S.F.

PRE-STAGE 66: Cut=17.4 S.F., Fill=0.0 S.F.

PRE-STAGE 67: Cut=17.4 S.F., Fill=0.0 S.F.

PRE-STAGE 68: Cut=17.4 S.F., Fill=0.0 S.F.

PRE-STAGE 69: Cut=17.4 S.F., Fill=0.0 S.F.

PRE-STAGE 70: Cut=17.4 S.F., Fill=0.0 S.F.

PRE-STAGE 71: Cut=17.4 S.F., Fill=0.0 S.F.

PRE-STAGE 72: Cut=17.4 S.F., Fill=0.0 S.F.

PRE-STAGE 73: Cut=17.4 S.F., Fill=0.0 S.F.

PRE-STAGE 74: Cut=17.4 S.F., Fill=0.0 S.F.

PRE-STAGE 75: Cut=17.4 S.F., Fill=0.0 S.F.

PRE-STAGE 76: Cut=17.4 S.F., Fill=0.0 S.F.

PRE-STAGE 77: Cut=17.4 S.F., Fill=0.0 S.F.

PRE-STAGE 78: Cut=17.4 S.F., Fill=0.0 S.F.

PRE-STAGE 79: Cut=17.4 S.F., Fill=0.0 S.F.

PRE-STAGE 80: Cut=17.4 S.F., Fill=0.0 S.F.

PRE-STAGE 81: Cut=17.4 S.F., Fill=0.0 S.F.

PRE-STAGE 82: Cut=17.4 S.F., Fill=0.0 S.F.

PRE-STAGE 83: Cut=17.4 S.F., Fill=0.0 S.F.

PRE-STAGE 84: Cut=17.4 S.F., Fill=0.0 S.F.

PRE-STAGE 85: Cut=17.4 S.F., Fill=0.0 S.F.

PRE-STAGE 86: Cut=17.4 S.F., Fill=0.0 S.F.

PRE-STAGE 87: Cut=17.4 S.F., Fill=0.0 S.F.

PRE-STAGE 88: Cut=17.4 S.F., Fill=0.0 S.F.

PRE-STAGE 89: Cut=17.4 S.F., Fill=0.0 S.F.

PRE-STAGE 90: Cut=17.4 S.F., Fill=0.0 S.F.

PRE-STAGE 91: Cut=17.4 S.F., Fill=0.0 S.F.

PRE-STAGE 92: Cut=17.4 S.F., Fill=0.0 S.F.

PRE-STAGE 93: Cut=17.4 S.F., Fill=0.0 S.F.

PRE-STAGE 94: Cut=17.4 S.F., Fill=0.0 S.F.

PRE-STAGE 95: Cut=17.4 S.F., Fill=0.0 S.F.

PRE-STAGE 96: Cut=17.4 S.F., Fill=0.0 S.F.

PRE-STAGE 97: Cut=17.4 S.F., Fill=0.0 S.F.

PRE-STAGE 98: Cut=17.4 S.F., Fill=0.0 S.F.

PRE-STAGE 99: Cut=17.4 S.F., Fill=0.0 S.F.

PRE-STAGE 100: Cut=17.4 S.F., Fill=0.0 S.F.