

Notes:  
See sheet SA-12 of SA-15 for Sections C-C & D-D and View E-E.  
a<sub>10</sub>(E) and a<sub>11</sub>(E) bar spacings measured along  $\bar{C}$  Rdwy.

\*\*\* Cost included with Concrete Superstructure.

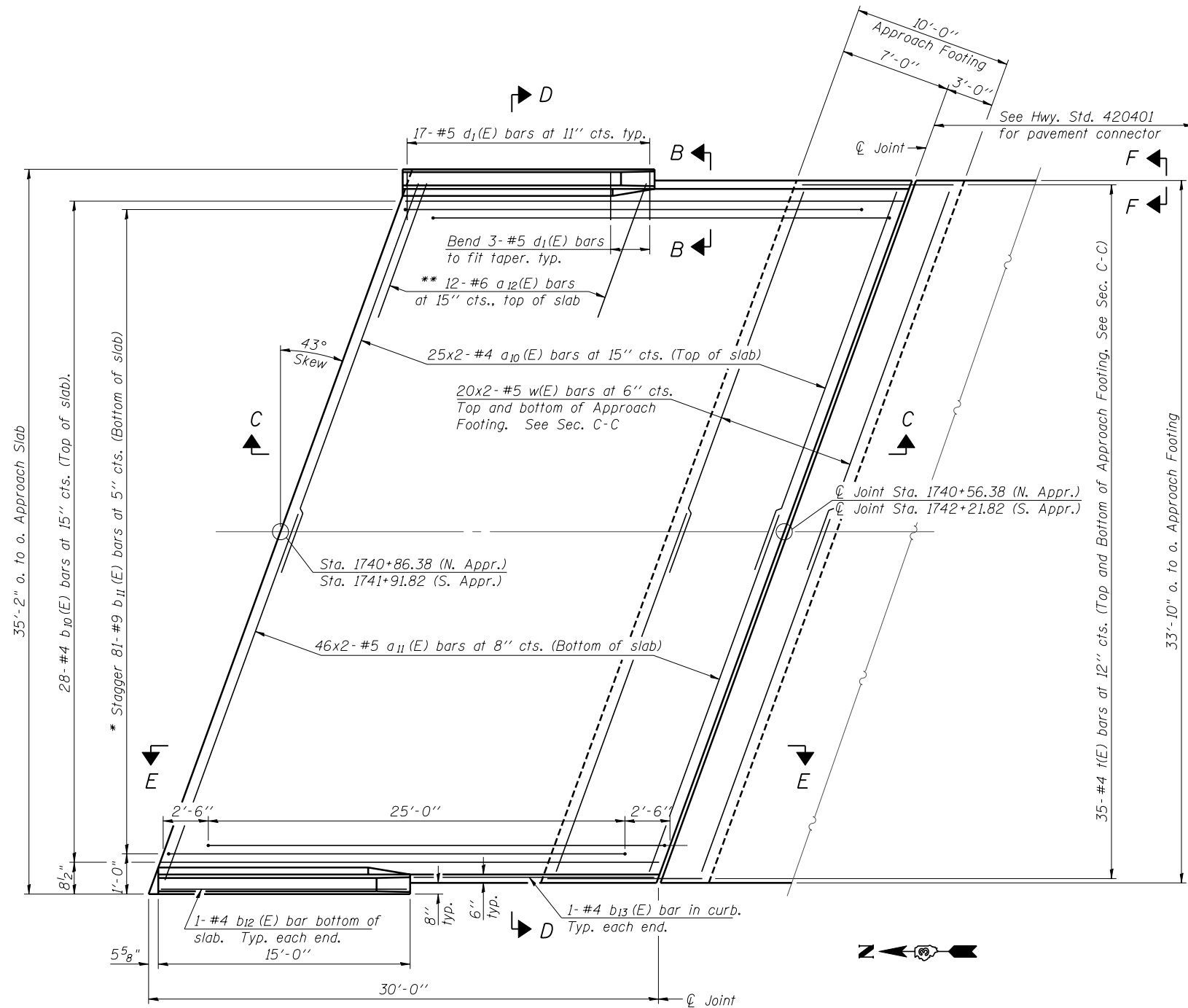

PLAN

\* Tilt #9 b<sub>11</sub>(E) bars as required to maintain clearance.  
\*\* Space between a(E) bars, typ. each parapet.

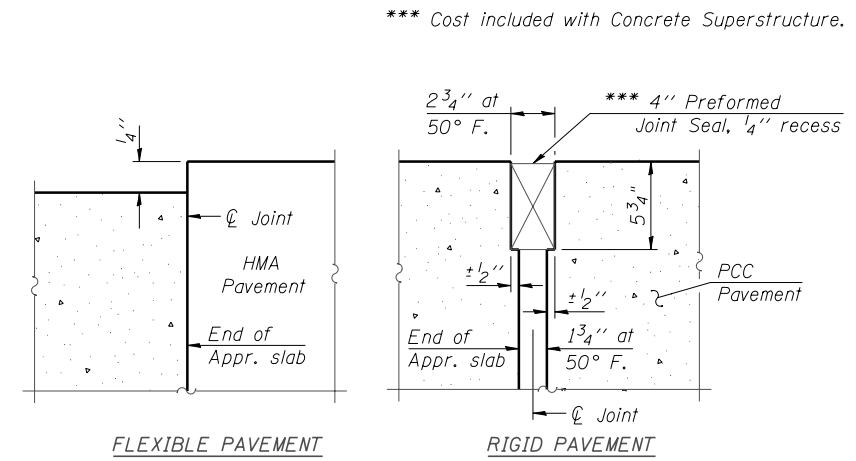

DETAIL A

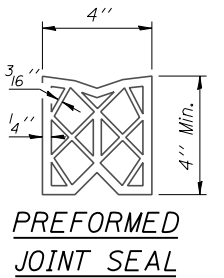

PREFORMED JOINT SEAL

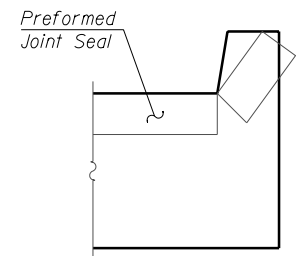

VIEW F-F

Angle Preformed Joint Seal at 45° at curbs when req'd for drainage.

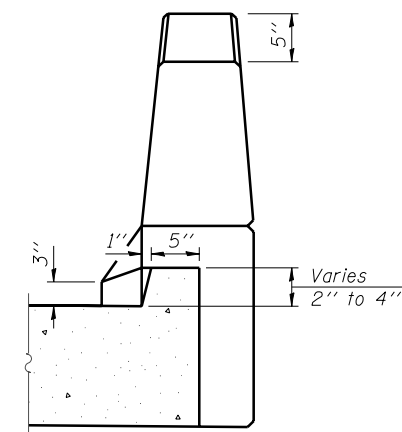

VIEW B-B

MINIMUM BAR LAP

#4 bar = 1'-10"  
#5 bar = 2'-3"

BA-L

7-1-10

(Sheet 1 of 2)



Zroka Engineering, P.C.  
4216 North Hermitage  
Chicago, IL 60613

USER NAME = SAW	DESIGNED - LAS	REVISED -
	CHECKED - DAZ	REVISED -
PLOT SCALE = 0:2.0000 '1' / IN.	DRAWN - SAW	REVISED -
PLOT DATE = 10/30/2012	CHECKED - LAS	REVISED -

STATE OF ILLINOIS  
DEPARTMENT OF TRANSPORTATION

BRIDGE APPROACH SLAB DETAILS  
S.N. 027-0072

SHEET NO. SA-11 OF SA-15 SHEETS

BRIDGE APPROACH SLAB DETAILS  
STRUCTURE NO. 027-0072

F.A.P. RTE.	SECTION	COUNTY	TOTAL SHEETS	SHEET NO.
796	(106 BR-1 & BR-4)BR	FORD	78	43
				CONTRACT NO. 66980
ILLINOIS FED. AID PROJECT				

FILE NAME = ...665980-SN0270072-011-Appr-Slab.dgn