

Benchmark: BM Chisled " on N.E. wingwall, Elev. 656.79
 Structure #027-0073
 Existing Structure: Built as SB1 Pk 115 SEC 106B in 1980.
 Single span RC thru girder on RC closed abutments. Cut to cut
 76'-0", face to face abutment 47'-6". The contractor shall
 remove the existing structure, before the proposed construction.
 Traffic shall be detoured during construction.

STATE OF ILLINOIS
 DEPARTMENT OF TRANSPORTATION

| | | | | |
|-------|-----|------|-----------|-----------|
| DATE | NO. | BY | SCALE | SHEET NO. |
| 10/26 | 1 | FORD | 3/4" = 1' | 6 |

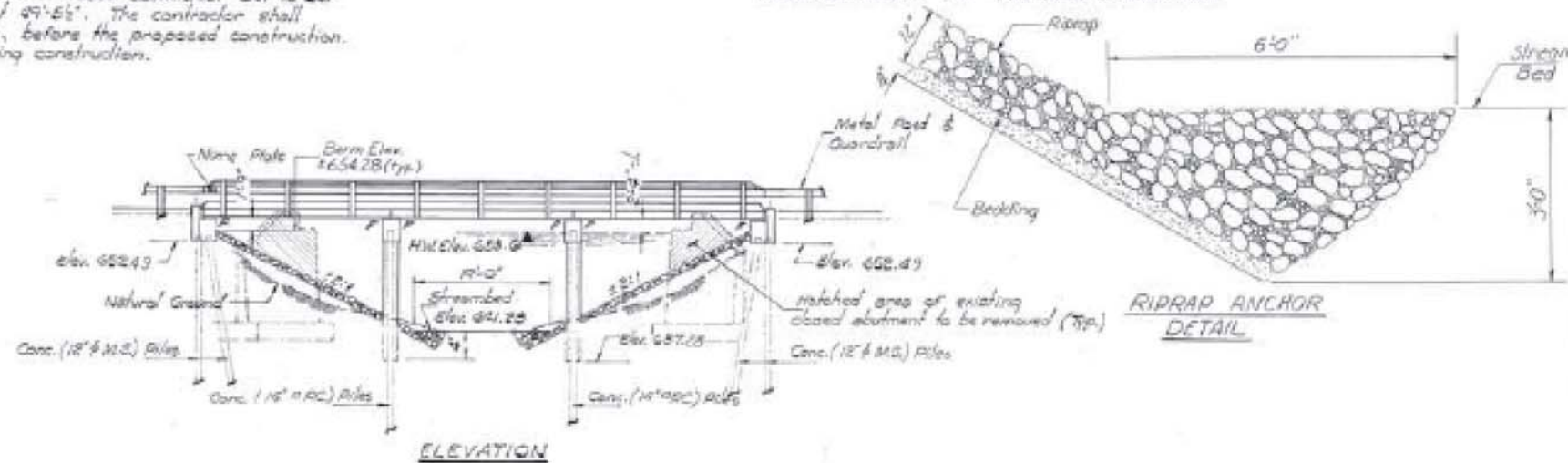

GENERAL NOTES

Reinforcement bars in the substructure shall conform to the requirements of AASHTO M31 or M53, Grade 60.
 The Contractor shall drive one precast concrete test pile (14") in a permanent location at Pier 1 and one 12" Metal Shell test pile in a permanent location of 2d Abut. as directed by the Engineer before ordering the remainder of piles.
 The top surface of the beams shall be finished in accordance with Article 905.06 of the Standard Specifications except that the surface shall not be roughened by brooming. The finished surface shall be free of depressions or high spots with sharp corners, and the top edge of keys shall be rounded or chamfered a minimum of 1/4".
 Limits of Waterproofing Membrane System shall be two feet six inches beyond backs of abutments and face to face of curbs.
 Protective Coat shall not be applied to surfaces to which Waterproofing Membrane System is applied.
 See Proposal for Boring Data.

WATERWAY INFORMATION

| Drainage Area | | 30.8 Sq. Mi. | | Low Grade Elev. | | 655.90 | | | |
|---------------|--------|-----------------|-----------|-----------------|---------------|---------------|---------------|--------|--------|
| Flood | Req. Q | Opening Sq. Ft. | Net. HWE. | Head - Ft. | Headwater El. | Headwater El. | Headwater El. | | |
| | | Exist. | Prop. | Exist. | Prop. | Exist. | Prop. | | |
| Design | 30 | 1176 | 513 | 499 | 653.60 | 0.03 | 0.03 | 653.63 | 653.63 |
| Base | 100 | 1487 | 533 | 564 | 654.60 | 0.19 | 0.06 | 654.79 | 654.66 |
| Overlapping | 1/2 | | | | | | | | |
| Max. Calc. | 500 | 1878 | 533 | 610 | 655.40 | 0.30 | 0.10 | 655.70 | 655.50 |

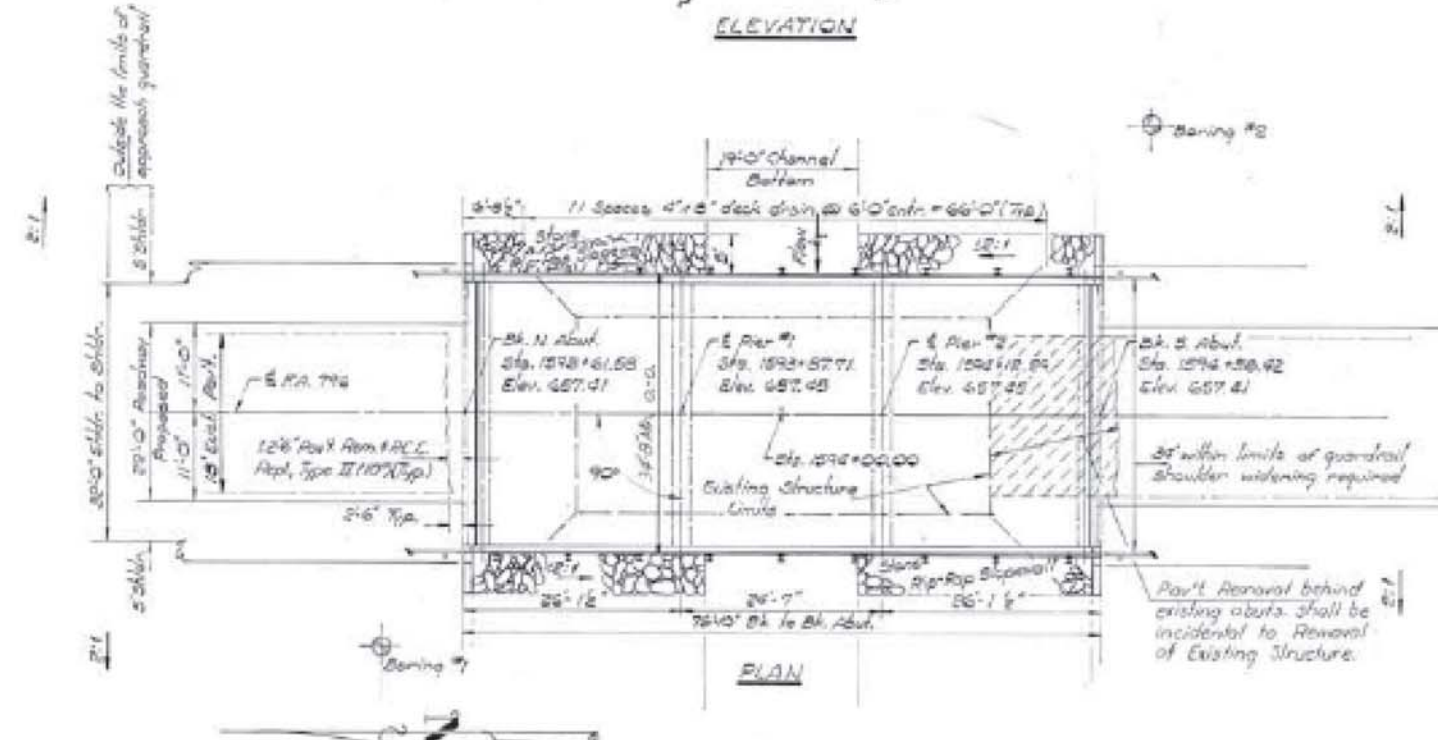

STATION 1594+00.00
 BUILT 19 BY
 STATE OF ILLINOIS
 F.A. Rte 796 SEC 106B-1
 PROJECT: BR-F-796(A)
 LOADING HS20
 STR. NO.

NAME PLATE
 (See SHL 2113)

*Structure Number to be supplied by District.

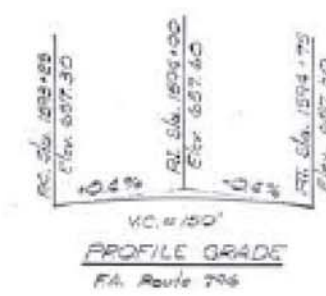

TOTAL BILL OF MATERIAL

| Item | Unit | Super | Sub | Total |
|--|----------|-------|-------|-------|
| Removal of Existing Structures No. 1 | Each | | | 1 |
| Bituminous Concrete Surface Course, Class I | Yds | 32 | | 32 |
| Stone Rip-Rap | Sq. Yd. | | 355 | 355 |
| Waterproofing Membrane System | Sq. Yd. | 297 | | 297 |
| Protective Coat | Sq. Yd. | 25 | | 25 |
| Pavement Removal & Portland Cement Concrete Replacement, Type II (10") | Sq. Yd. | 12 | | 12 |
| Precast Prestressed Concrete Deck Beams (11" Depth) Class I Concrete | Sq. Ft. | 2548 | | 2548 |
| Reinforcement Bars | Yds | 2.2 | 129.8 | 132.0 |
| Structure Excavation | Cu. Yd. | 190 | | 193 |
| Concrete Piles | Lin. Ft. | | | 344 |
| Test Piles, Concrete | Each | | | 1 |
| Steel Boring Type T-1 | Lin. Ft. | 147 | | 147 |
| Portland Cement Mortar Facing Course | Lin. Ft. | 515 | | 515 |
| Name Plates | Each | | | 1 |
| Precast Concrete Piles 14" | Lin. Ft. | | 589 | 589 |
| Test Piles, Precast Concrete | Each | | | 1 |

FOR INFORMATION ONLY

DESIGN STRESSES
 FIELD UNITS
 F_s = 3500 psi
 F_y = 60,000 psi
 PRECAST PRESTRESSED
 F_s = 5,000 psi
 F_{ci} = 4,000 psi
 F_s = 270,000 psi (1/2" strands)
 F_s = 189,000 psi (3/8" strands)

LOADING HS 20-44
 Allow 25% S.F. for future wearing surface.
 Design Specifications 1977 AASHTO, 1978, 1979
 11980 Interim Specifications.



GENERAL PLAN & ELEVATION
 F.A. Rte 796 Over Drainage Ditch
 F.A. Rte 796 SECTION 106B-1
 FORD COUNTY
 Sta. 1594+00.00

| | | | |
|----------|----------------|----------|--------------------|
| DESIGNED | Richard Brumby | DATE | September 10, 1979 |
| CHECKED | DAU KULL | PASSED | |
| DRAWN | R. Rely | APPROVED | |
| CHECKED | DK | | |

