

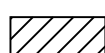

-  GRADING, DRAINAGE STRUCTURES AND PAVEMENT
-  GRADING AND DRAINAGE STRUCTURES
-  PAVING OF PREVIOUSLY GRADED SECTION
-  TEMPORARY CROSSOVER

**MAINTENANCE OF TRAFFIC STAGE 1**

SEQUENCE OF CONSTRUCTION

1. PLACE EMBANKMENT AND DRAINAGE STRUCTURES FOR FUTURE US 34 FROM STA 550+00 TO STA 591+00±.
2. PLACE EMBANKMENT, DRAINAGE STRUCTURES AND PAVE TR 94 (1400 E)
3. CONSTRUCT CUL-DE-SAC TR 102 (1475 E) NORTH OF FUTURE US 34.
4. CONSTRUCT FIELD ENTRANCE TR 102 (1475 E) SOUTH OF FUTURE US 34.

TRAFFIC PLACEMENT

1. CLOSE TR 94 (1400 E) FOR RELOCATION. NO CLOSURE OF TR 94 (1400E E) FROM AUGUST 15 THRU NOVEMBER 30. RE-OPEN AT COMPLETION WITH TEMPORARY CROSSING OF PROPOSED US 34.
2. CLOSE TR 102 (1475 E) AT COMPLETION OF CUL-DE-SAC AND NEW FIELD ENTRANCES.

TRAFFIC CONTROL STANDARDS

701001 701006 701011 701326

USE TRAFFIC CONTROL AND PROTECTION STANDARD 701326 WHERE CONSTRUCTION OPERATIONS ENCROACH ON EXISTING US 34

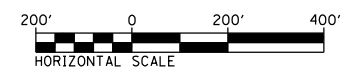
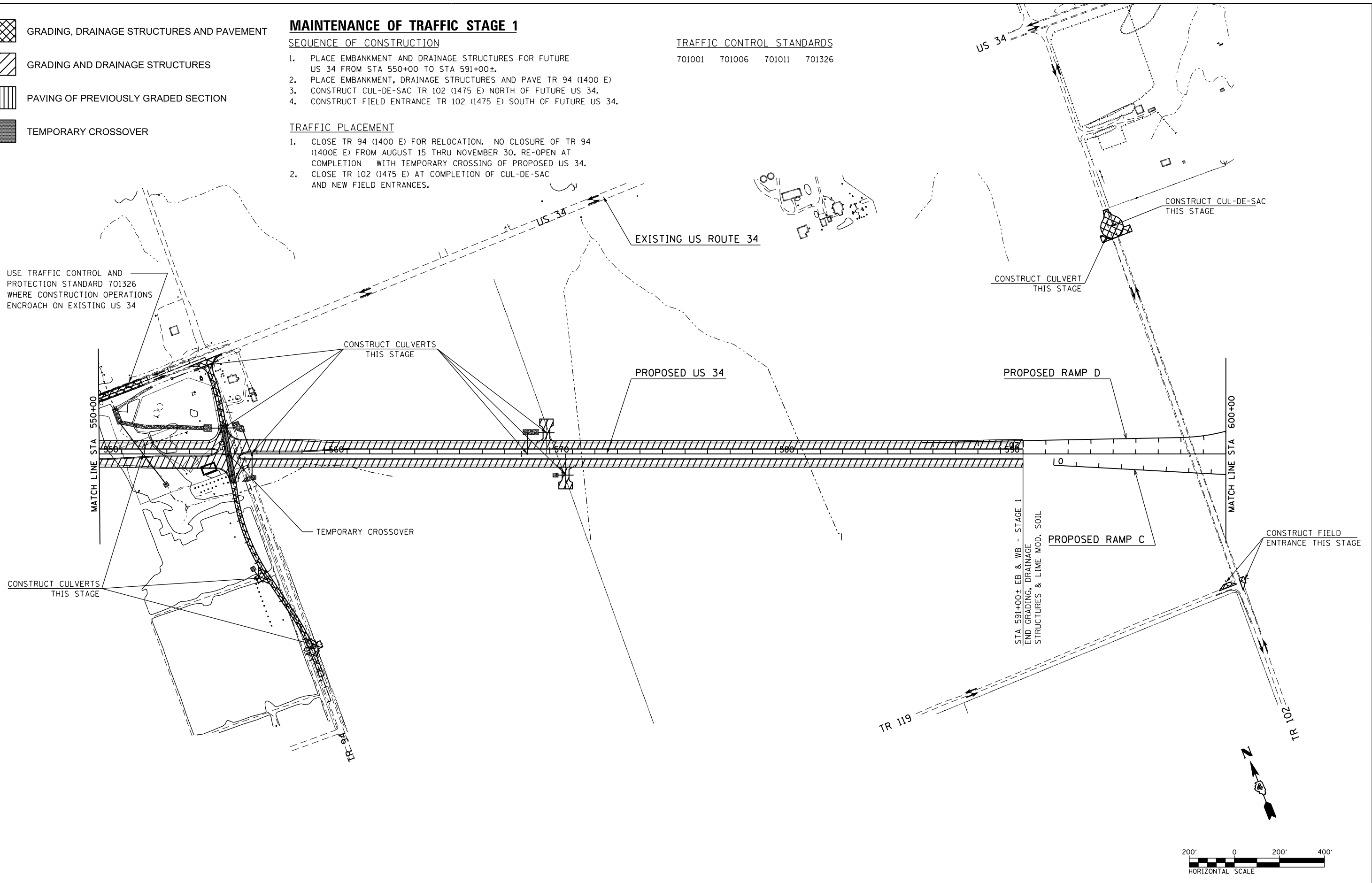

FILE NAME = D468409-SHT-STAGING.1-02.dgn	USER NAME = zach1	DESIGNED - DBS	REVISED -
		DRAWN - PSBA	REVISED -
	PLOT SCALE = 400.0000' / in.	CHECKED - CSB	REVISED -
	PLOT DATE = 10/16/2012	DATE - 10/2012	REVISED -

**STATE OF ILLINOIS  
DEPARTMENT OF TRANSPORTATION**

**CONSTRUCTION STAGING PLANS  
STAGE 1 - US ROUTE 34**

SCALE: 1" = 200'    SHEET NO. 2 OF 17 SHEETS    STA. 550+00    TO STA. 600+00

F.A.P. RTE.	SECTION	COUNTY	TOTAL SHEETS	SHEET NO.
313	7-2; 6-1	HENDERSON	976	225
CONTRACT NO. 68409				
ILLINOIS FED. AID PROJECT				