

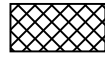
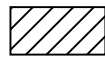

-  GRADING, DRAINAGE STRUCTURES AND PAVEMENT
-  GRADING AND DRAINAGE STRUCTURES
-  PAVING OF PREVIOUSLY GRADED SECTION
-  TEMPORARY CROSSOVER

MAINTENANCE OF TRAFFIC STAGE 1

SEQUENCE OF CONSTRUCTION

1. PLACE EMBANKMENT AND DRAINAGE STRUCTURES FOR FUTURE US 34 FROM STA 650+00 TO STA 700+00.
2. PLACE EMBANKMENT, DRAINAGE STRUCTURES AND PAVE TR 138 (1650 E).

TRAFFIC PLACEMENT

1. CLOSE TR 138 (1650 E) FOR RECONSTRUCTION. ALTERNATE ROAD CLOSURE WITH TR 150 (1700 E). RE-OPEN AT COMPLETION WITH TEMPORARY CROSSOVER OF FUTURE US 34.

TRAFFIC CONTROL STANDARDS

701001 701006 701011 701326

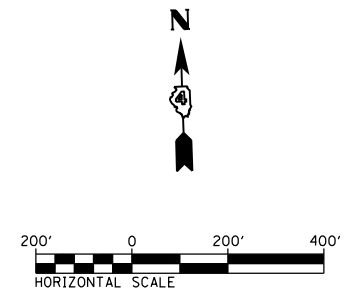
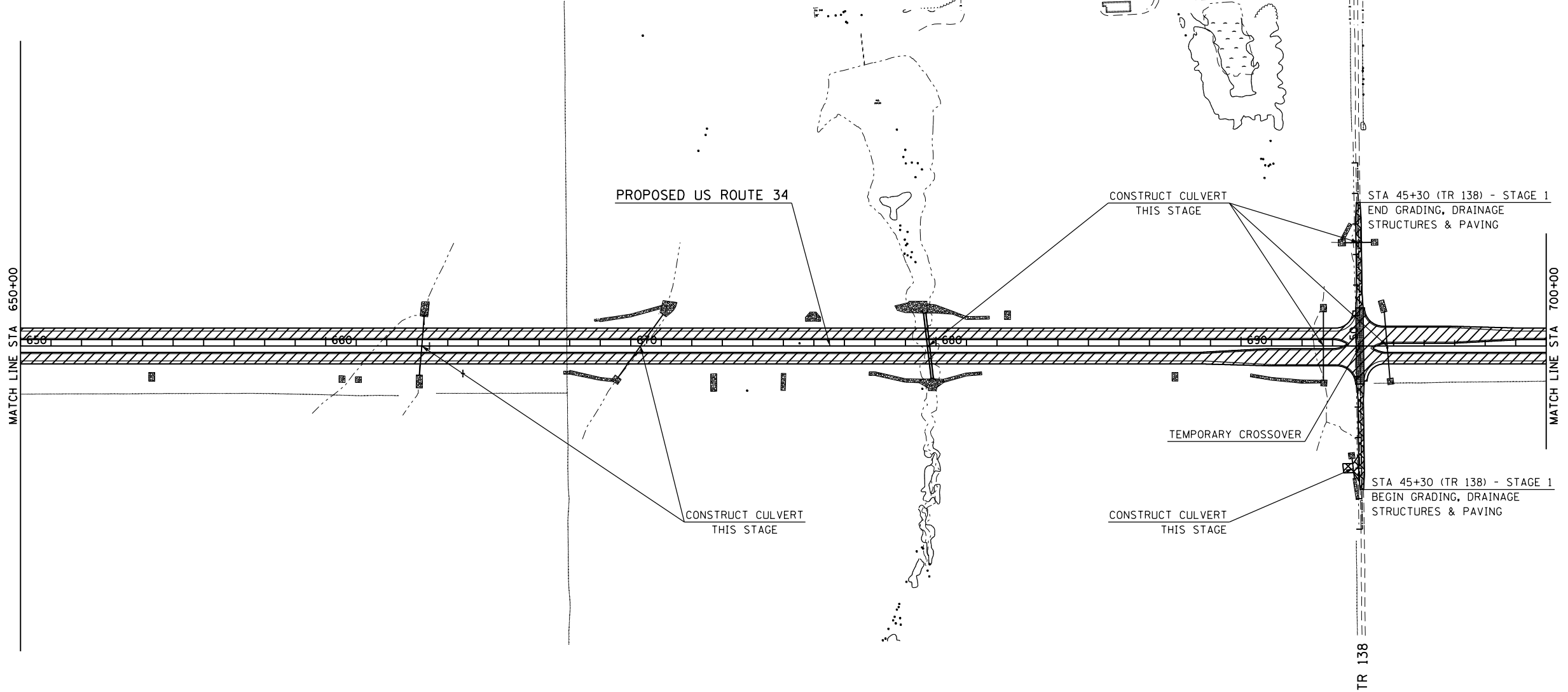

FILE NAME = D468409-SHT-STAGING.1-04.dgn	USER NAME = zach1	DESIGNED - DBS	REVISED -
		DRAWN - PSBA	REVISED -
	PLOT SCALE = 400.0000' / in.	CHECKED - CSB	REVISED -
	PLOT DATE = 10/16/2012	DATE - 10/2012	REVISED -

**STATE OF ILLINOIS
DEPARTMENT OF TRANSPORTATION**

CONSTRUCTION STAGING PLANS			
STAGE 1 - US ROUTE 34			
SCALE: 1" = 200'	SHEET NO. 4 OF 17 SHEETS	STA. 650+00	TO STA. 700+00

F.A.P. RTE.	SECTION	COUNTY	TOTAL SHEETS	SHEET NO.
313	7-2; 6-1	HENDERSON	976	227
CONTRACT NO. 68409				
ILLINOIS FED. AID PROJECT				