

**TEMPORARY EROSION CONTROL LEGEND**

- INLET AND PIPE PROTECTION
- TEMPORARY DITCH CHECK
- AGGREGATE DITCH CHECK
- EROSION CONTROL BLANKET
- HEAVY DUTY EROSION CONTROL BLANKET
- MULCH METHOD 2
- PERIMETER EROSION BARRIER
- TEMPORARY SEDIMENT BASIN

50' 0 50' 100'

SCALE: 1" = 50'

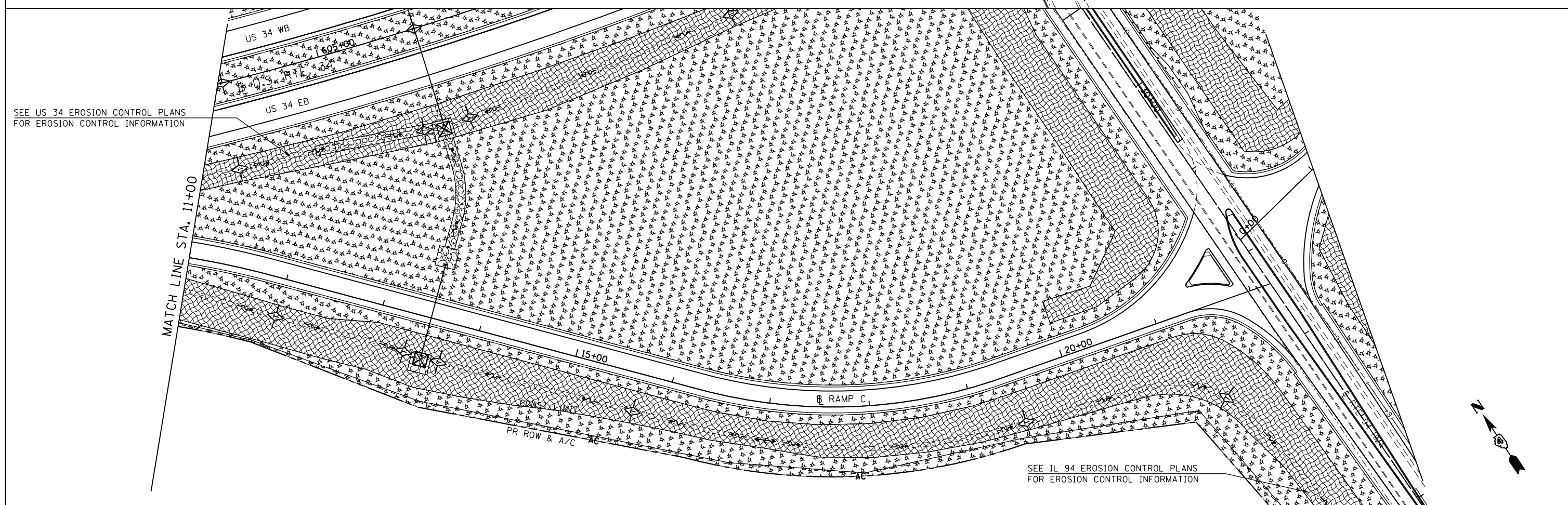

SEE IL 94 EROSION CONTROL PLANS FOR EROSION CONTROL INFORMATION

FILE NAME = D468409-SHT-19-EROS-RAMP.C.dgn	USER NAME = zach1	DESIGNED - DBS	REVISED -	<b>STATE OF ILLINOIS DEPARTMENT OF TRANSPORTATION</b>	<b>EROSION CONTROL PLANS RAMP C</b>			F.A.P. RTE. 313	SECTION 7-2 ; 6-1	COUNTY HENDERSON	TOTAL SHEETS 976	SHEET NO. 259
	PLOT SCALE = 100.0000' / 1" =	CHECKED - CSB	REVISED -		SCALE: 1" = 50'	SHEET NO. 19 OF 34 SHEETS	STA. 0+00 TO STA. 22+21	CONTRACT NO. 68409		ILLINOIS FED. AID PROJECT		
PLOT DATE = 10/16/2012	DATE = 10/2012	REVISED -	REVISED -									