

73 35' PIPE CULVERTS, CLASS D, TYPE 1, 24"  
 2 MFES 24"  
 USFL = 676.86, 65+66.87, 34.45' LT  
 DSFL = 674.86, 66+01.66, 39.11' LT

74 STA 66+40.00 (TR 150) SKEW = 13° 23' RA  
 74' PIPE CULVERTS, CLASS A, TYPE 1, 24"  
 2 PRCFES 24"  
 USFL = 673.25, 66+30.00, 40.00' LT  
 DSFL = 672.00, 66+50.00, 44.00' RT

A STONE RIPRAP  
 CLASS B4  
 L35' X W20'

B STONE RIPRAP  
 CLASS B4  
 L30' X W22'

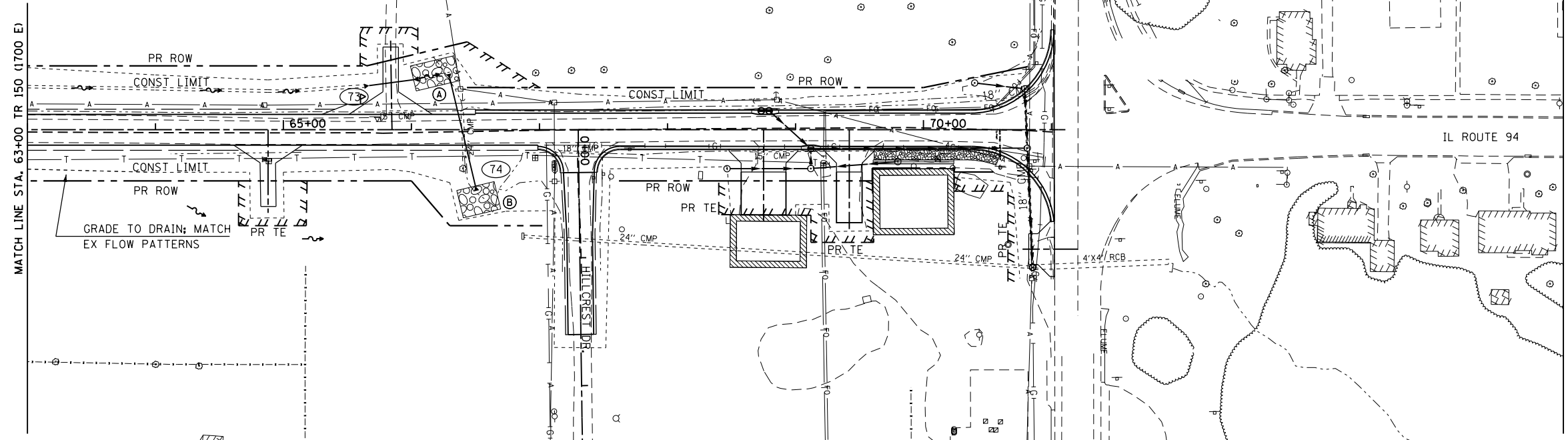

PLAN	SURVEYED	DATE
	PLOTTED	
	ALIGNED	
	CHECKED	
	FILED	
	NO.	

PROFILE	SURVEYED	DATE
	PLOTTED	
	GRADES	
	CHECKED	
	STRUCTURE	
	NOTATIONS	
	CHKD	
	NO.	

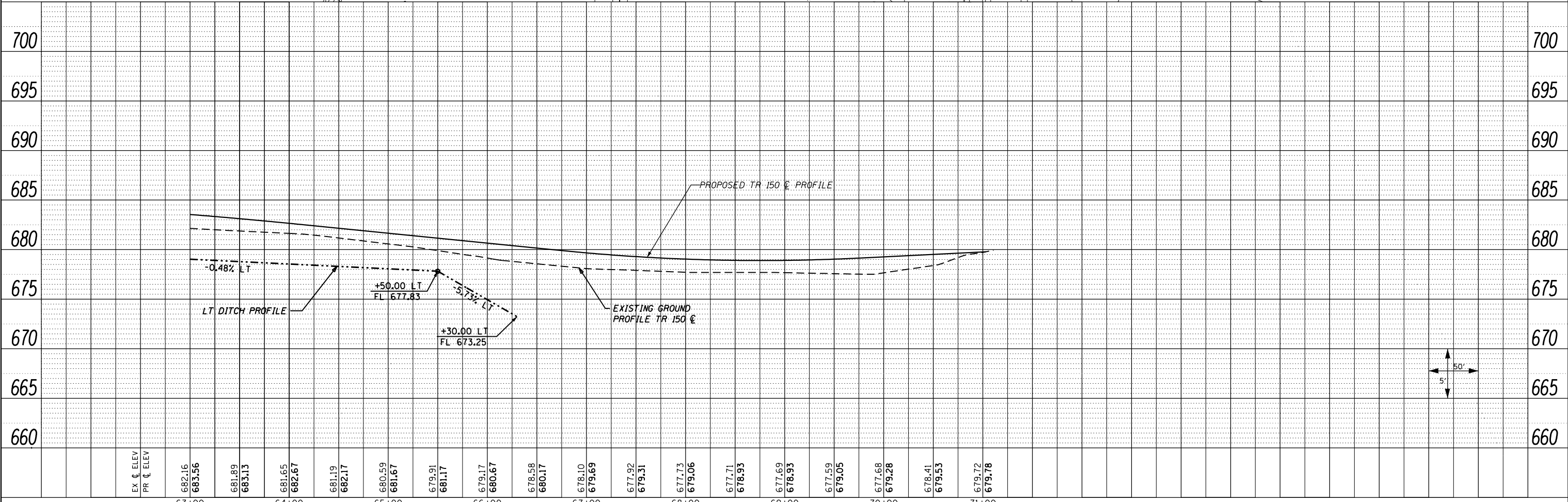

FILE NAME =	USER NAME = zech1	DESIGNED - DBS	REVISED -	<b>STATE OF ILLINOIS</b> <b>DEPARTMENT OF TRANSPORTATION</b>	<b>DRAINAGE PLAN AND PROFILE</b> <b>TR 150 (1700 E)</b>	F.A.P. RTE.	SECTION	COUNTY	TOTAL SHEETS	SHEET NO.	
D468409-SHT-47-DRAIN-TR150-03.dgn		DRAWN - PSBA	REVISED -			313	7-2 ; 6-1	HENDERSON	976	322	
PLOT SCALE = 100.0000' / 1"		CHECKED - CSB	REVISED -			CONTRACT NO. 68409					
PLOT DATE = 10/16/2012		DATE - 10/2012	REVISED -			ILLINOIS FED. AID PROJECT					

SCALE: 1" = 50' SHEET NO. 47 OF 61 SHEETS STA. 63+00 TO STA. 71+00