

BY	DATE
SURVEYED	
PLOTTED	
TEMPLATE	
NOTE BOOK	
AREAS CHECKED	
NO.	

BY	DATE
SURVEYED	
PLOTTED	
TEMPLATE	
NOTE BOOK	
AREAS CHECKED	
NO.	

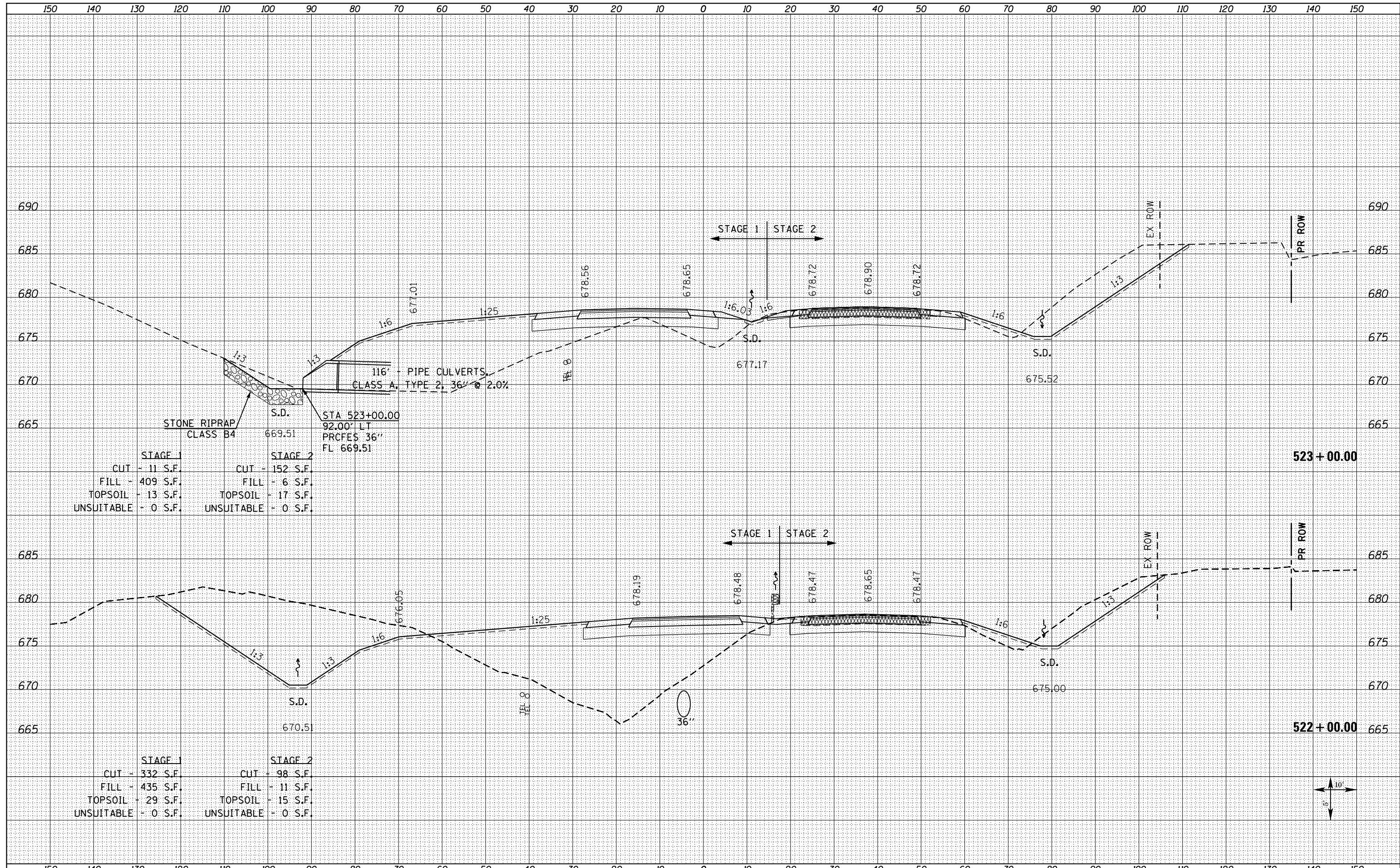

STAGE 1		STAGE 2	
CUT	- 11 S.F.	CUT	- 152 S.F.
FILL	- 409 S.F.	FILL	- 6 S.F.
TOPSOIL	- 13 S.F.	TOPSOIL	- 17 S.F.
UNSUITABLE	- 0 S.F.	UNSUITABLE	- 0 S.F.

STAGE 1		STAGE 2	
CUT	- 332 S.F.	CUT	- 98 S.F.
FILL	- 435 S.F.	FILL	- 11 S.F.
TOPSOIL	- 29 S.F.	TOPSOIL	- 15 S.F.
UNSUITABLE	- 0 S.F.	UNSUITABLE	- 0 S.F.



FILE NAME = D468409-SHT-XSHT-US34-A.dgn

USER NAME = danw
 PLOT SCALE = 20.0000' / in.
 PLOT DATE = 10/16/2012

DESIGNED -
 DRAWN -
 CHECKED -
 DATE -

REVISED -
 REVISED -
 REVISED -
 REVISED -

**STATE OF ILLINOIS
 DEPARTMENT OF TRANSPORTATION**

**CROSS SECTIONS
 US ROUTE 34**

SCALE: NOTED SHEET NO. 15 OF 209 SHEETS STA. 522+00.00 TO STA. 523+00.00

F.A.P. RTE.	SECTION	COUNTY	TOTAL SHEETS	SHEET NO.
313	7-2 ; 6-1	HENDERSON	976	590
				CONTRACT NO. 68409

ILLINOIS FED. AID PROJECT