

DATE	
BY	
SURVEYED	
PLOTTED	
TEMPLATE	
NOTE BOOK	
AREAS CHECKED	
NO.	

DATE	
BY	
SURVEYED	
PLOTTED	
TEMPLATE	
NOTE BOOK	
AREAS CHECKED	
NO.	

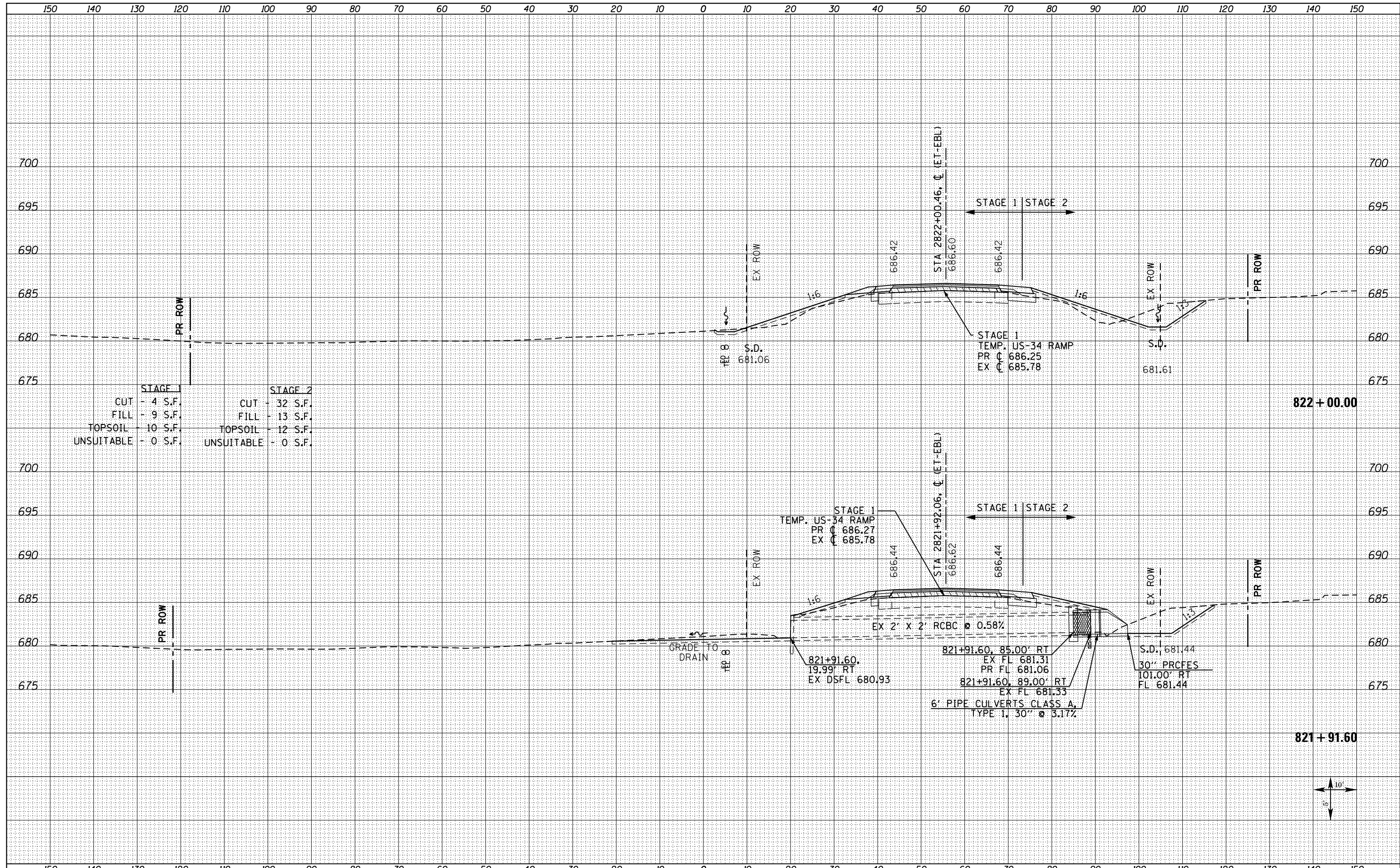

STAGE 1	STAGE 2
CUT - 4 S.F.	CUT - 32 S.F.
FILL - 9 S.F.	FILL - 13 S.F.
TOPSOIL - 10 S.F.	TOPSOIL - 12 S.F.
UNSUITABLE - 0 S.F.	UNSUITABLE - 0 S.F.

822 + 00.00

821 + 91.60



FILE NAME = D468409-SHT-XSHT-US34-C.dgn

USER NAME = zechl	DESIGNED - DBS	REVISED -
	DRAWN - PSBA	REVISED -
PLOT SCALE = 20.0000' / in.	CHECKED - CSB	REVISED -
PLOT DATE = 10/16/2012	DATE - 10/2012	REVISED -

**STATE OF ILLINOIS
DEPARTMENT OF TRANSPORTATION**

**CROSS SECTIONS
US ROUTE 34**

SCALE: NOTED SHEET NO. 206 OF 209 SHEETS STA. 821+91.60 TO STA. 822+00.00

F.A.P. RTE.	SECTION	COUNTY	TOTAL SHEETS	SHEET NO.
313	7-2 ; 6-1	HENDERSON	976	825
CONTRACT NO. 68409				
ILLINOIS FED. AID PROJECT				