

FOUND MAG NAIL & B.C.
S.E. COR. SEC. 35
STA. 2034 + 76.34, 2.29' RT

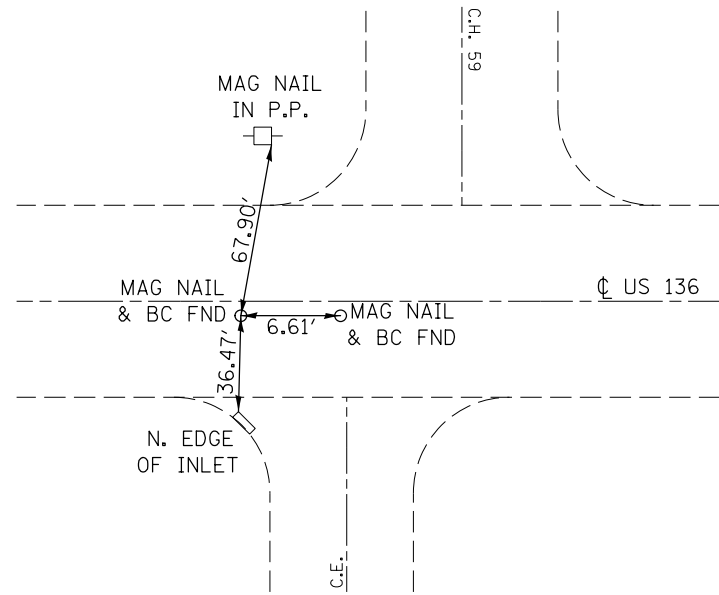

FOUND MAG NAIL & B.C.
S.E. COR. SEC. 35
STA. 2034 + 82.96, 2.24' RT

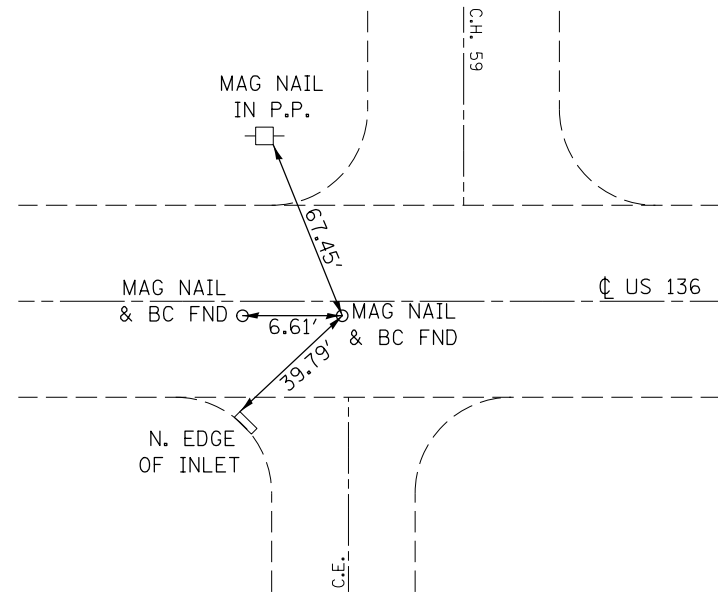

FILE NAME =	USER NAME = ogiebj	DESIGNED -	REVISED -
ci:\pwork\pwork\ogieb\j\0244982\0570783-sh1-ATB.dgn		DRAWN -	REVISED -
	PLOT SCALE = 40.0000' / in.	CHECKED -	REVISED -
	PLOT DATE = 10/9/2012	DATE -	REVISED -

STATE OF ILLINOIS
DEPARTMENT OF TRANSPORTATION

SURVEY MONUMENT TIE POINTS

SCALE: SHEET NO. OF SHEETS STA. TO STA.

F.A.P. RTE.	SECTION	COUNTY	TOTAL SHEETS	SHEET NO.
315	119RS-4, 18RS & (57-10)RS	MCLEAN	225	26
CONTRACT NO. 70783				
ILLINOIS FED. AID PROJECT				