

NORTH EDGE OF SHOULDER

Location	Station	Offset	Theoretical Grade Elevations
W. End W. Approach	91412.19	-18.00	603.81
A	91422.19	-18.00	603.73
B	91432.19	-18.00	603.67
E. End W. Approach	91442.19	-18.00	603.62

NORTH EDGE OF PAVEMENT

Location	Station	Offset	Theoretical Grade Elevations
W. End W. Approach	91408.73	-12.00	603.97
A	91418.73	-12.00	603.88
B	91428.73	-12.00	603.81
E. End W. Approach	91438.73	-12.00	603.76

CL ROADWAY & PGL

Location	Station	Offset	Theoretical Grade Elevations
W. End W. Approach	91401.80	0.00	604.23
A	91411.80	0.00	604.13
B	91421.80	0.00	604.05
E. End W. Approach	91431.80	0.00	603.98

STAGE CONSTRUCTION LINE

Location	Station	Offset	Theoretical Grade Elevations
W. End W. Approach	91400.35	2.50	604.20
A	91410.35	2.50	604.10
B	91420.35	2.50	604.02
E. End W. Approach	91430.35	2.50	603.95

SOUTH EDGE OF PAVEMENT

Location	Station	Offset	Theoretical Grade Elevations
W. End W. Approach	91394.87	12.00	604.11
A	91404.87	12.00	604.01
B	91414.87	12.00	603.92
E. End W. Approach	91424.87	12.00	603.84

SOUTH EDGE OF SHOULDER

Location	Station	Offset	Theoretical Grade Elevations
W. End W. Approach	91391.40	18.00	604.03
A	91401.40	18.00	603.92
B	91411.40	18.00	603.82
E. End W. Approach	91421.40	18.00	603.74

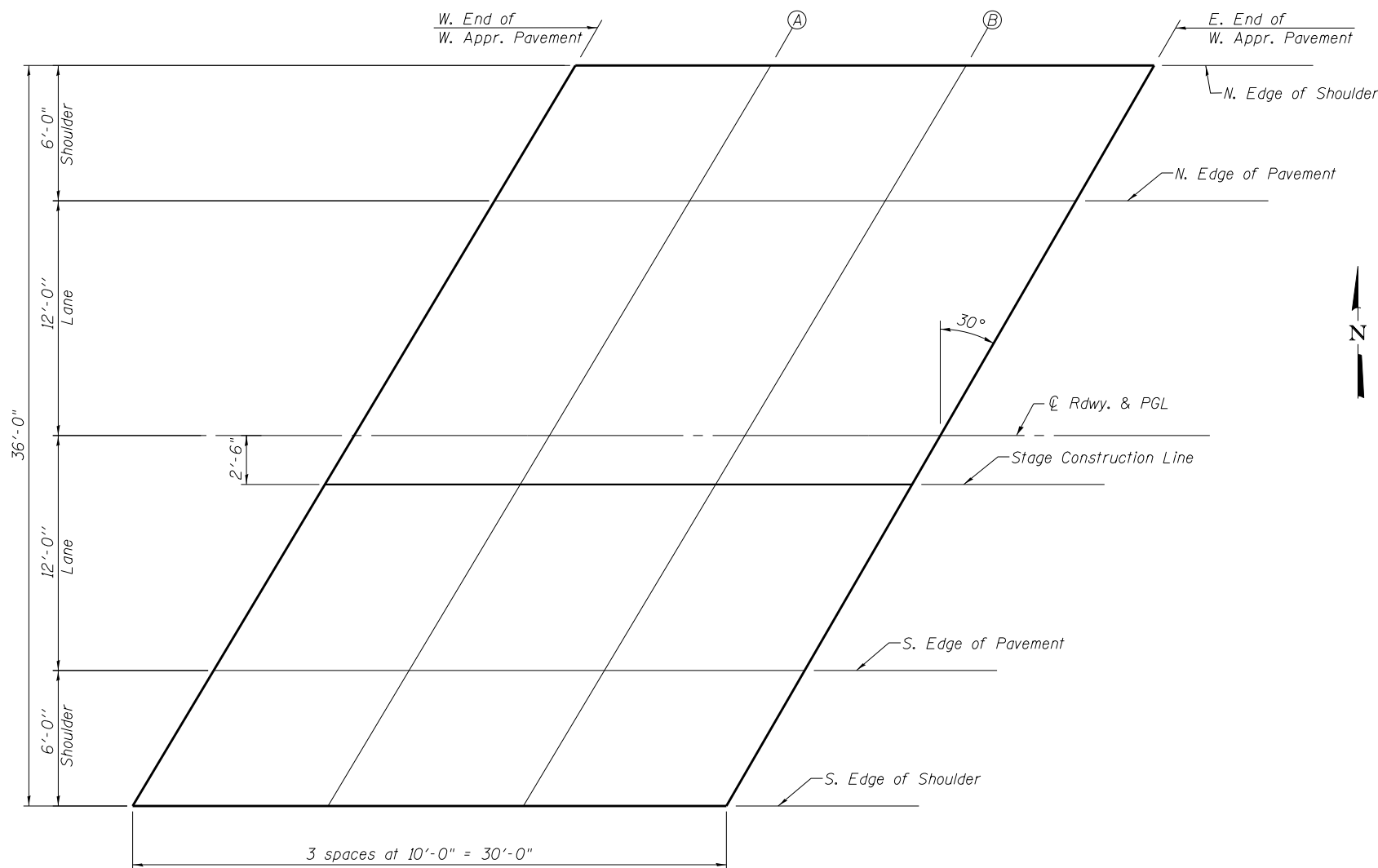

PLAN

FILE NAME = \\s:\projects\116BR\116BR-1\116BR-1.dgn
 USER = sparksgw
 PROJECT NO. 10800E-1

PA-E 7-1-10

Coombe-Bloxdorf P.C.
 - CIVIL ENGINEERS -
 - STRUCTURAL ENGINEERS -
 - LAND SURVEYORS -
 Design Firm License No. 184-002703

USER NAME = sparksgw	DESIGNED - CME	REVISED -
PLOT SCALE = 0:2.0000 '1' / in.	CHECKED - MCB	REVISED -
PLOT DATE = Oct-19-2012 02:14:40PM	DRAWN - MML	REVISED -
	CHECKED - MCB	REVISED -

**STATE OF ILLINOIS
 DEPARTMENT OF TRANSPORTATION**

**TOP OF WEST APPROACH SLAB ELEVATIONS
 STRUCTURE NO. 059-0515**

SHEET NO. 7 OF 22 SHEETS

F.A.P. RTE.	SECTION	COUNTY	TOTAL SHEETS	SHEET NO.
325	116BR-1	MACOUPIN	67	43
CONTRACT NO. 72A19				
ILLINOIS FED. AID PROJECT				