

**BENCHMARKS:**

BM-0029 - BRASS DISC IN WEST WINGWALL OF NORTH ABUTMENT.  
 BM-0029 IS FROM HANCOCK CO. GIS NETWORK. ELEVATION IS A RTK  
 HEIGHT WITH AN ACCURACY OF ±0.2 FT. USE FOR THIS PROJECT ONLY.  
 NAVD88 = 530.645

BM#500 - FOUND CHISELED SQUARE IN CENTER OF EAST CONCRETE HEADWALL @ STA. ±1024+00, LEFT SIDE OF CL.  
 NAVD88 = 551.765

BM#501 - FOUND CHISELED SQUARE ON WEST WINGWALL OF SOUTH ABUTMENT.  
 NAVD88 = 530.222

BM#502 - SET CHISELED SQUARE IN CENTER OF WEST CONCRETE HEADWALL OF BOX CULVERT @ STA. ±1038+10, RIGHT SIDE OF CL.  
 NAVD88 = 528.153

BM#503 - FOUND CHISELED SQUARE IN CENTER OF WEST CONCRETE HEADWALL OF CULVERT @ STA. ±1041+25, RIGHT SIDE OF CL.  
 NAVD88 = 527.183

EXIST. CURVE 205  
 PI STA. = 1028+35.13  
 $\Delta = 3^\circ 06' 06''$  (LT)  
 $D = 1^\circ 01' 41''$   
 $R = 5,573.44'$   
 $T = 150.89'$   
 $L = 301.71'$   
 $E = 2.04'$   
 $e = \text{-----}$   
 $T.R. = \text{-----}$   
 $S.E. RUN = \text{-----}$   
 P.C. STA. = 1026+84.24  
 P.T. STA. = 1029+85.95

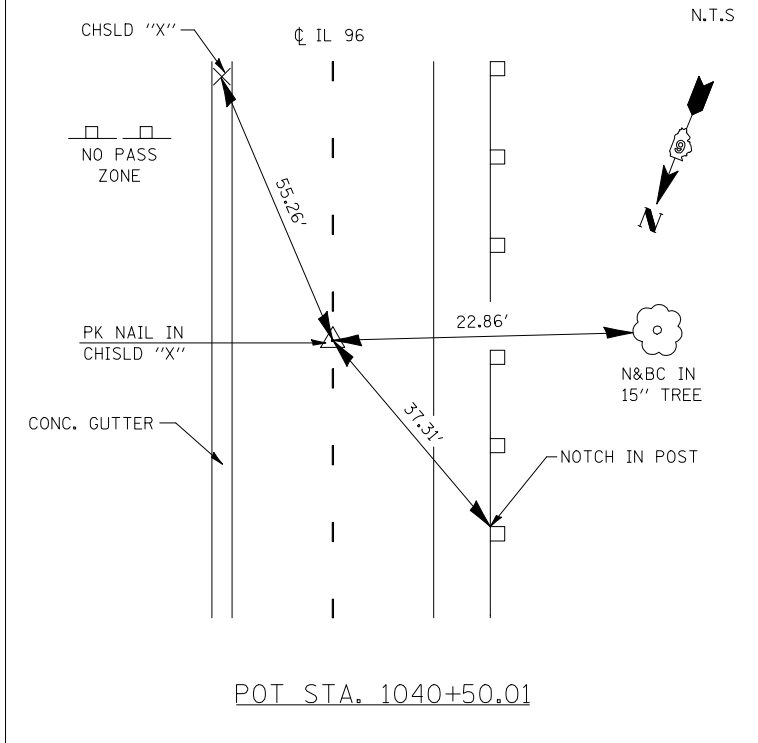
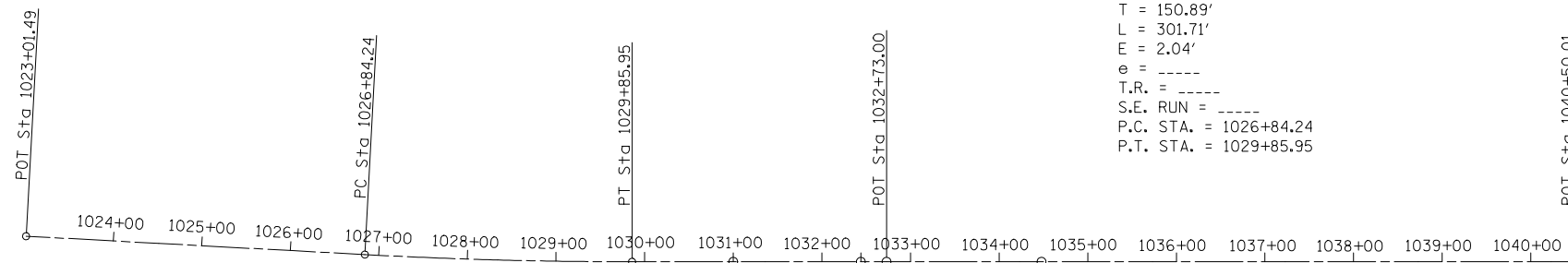

BEGIN PROJECT  
 SECTION 120B-3  
 STA. 1031+00 (IL-96)

END PROJECT  
 SECTION 120B-3  
 STA. 1034+50 (IL-96)

PR 12' X 8 TRIPLE BARREL  
 BOX CULVERT S.N. 034-2523  
 IL ROUTE 96 STA. 1032+44.00

EXISTING BRIDGE S.N. 034-0029  
 IL ROUTE 96 STA. 1032+73.00

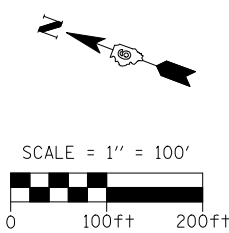

USER NAME = Plotted by Roadways7	DESIGNED - SGL	REVISED -
PLOT SCALE = 200.0000' / IN.	DRAWN - SGL	REVISED -
PLOT DATE = 10/19/2012	CHECKED - FML	REVISED -
	DATE - 9/2012	REVISED -

**STATE OF ILLINOIS  
 DEPARTMENT OF TRANSPORTATION**

**IL ROUTE 96 OVER INLET DITCH  
 BENCHMARKS, HORIZONTAL ALIGNMENT & LOCAL TIES**

SCALE: 1"=100' SHEET NO. 01 OF 01 SHEETS STA. 1023+01.49 TO STA. 1040+50.01

F.A.P. RTE.	SECTION	COUNTY	TOTAL SHEETS	SHEET NO.
510	120B-3	HANCOCK	38	14
CONTRACT NO. 72B67				
FED. ROAD DIST. NO. 6 ILLINOIS FED. AID PROJECT				