

DATE	
BY	
SURVEYED	
PLOTTED	
TEMPLATE	
AREAS	
CHECKED	
FINAL SURVEY	
NOTE BOOK	
NO.	

DATE	
BY	
SURVEYED	
PLOTTED	
TEMPLATE	
AREAS	
CHECKED	
ORIGINAL SURVEY	
NOTE BOOK	
NO.	

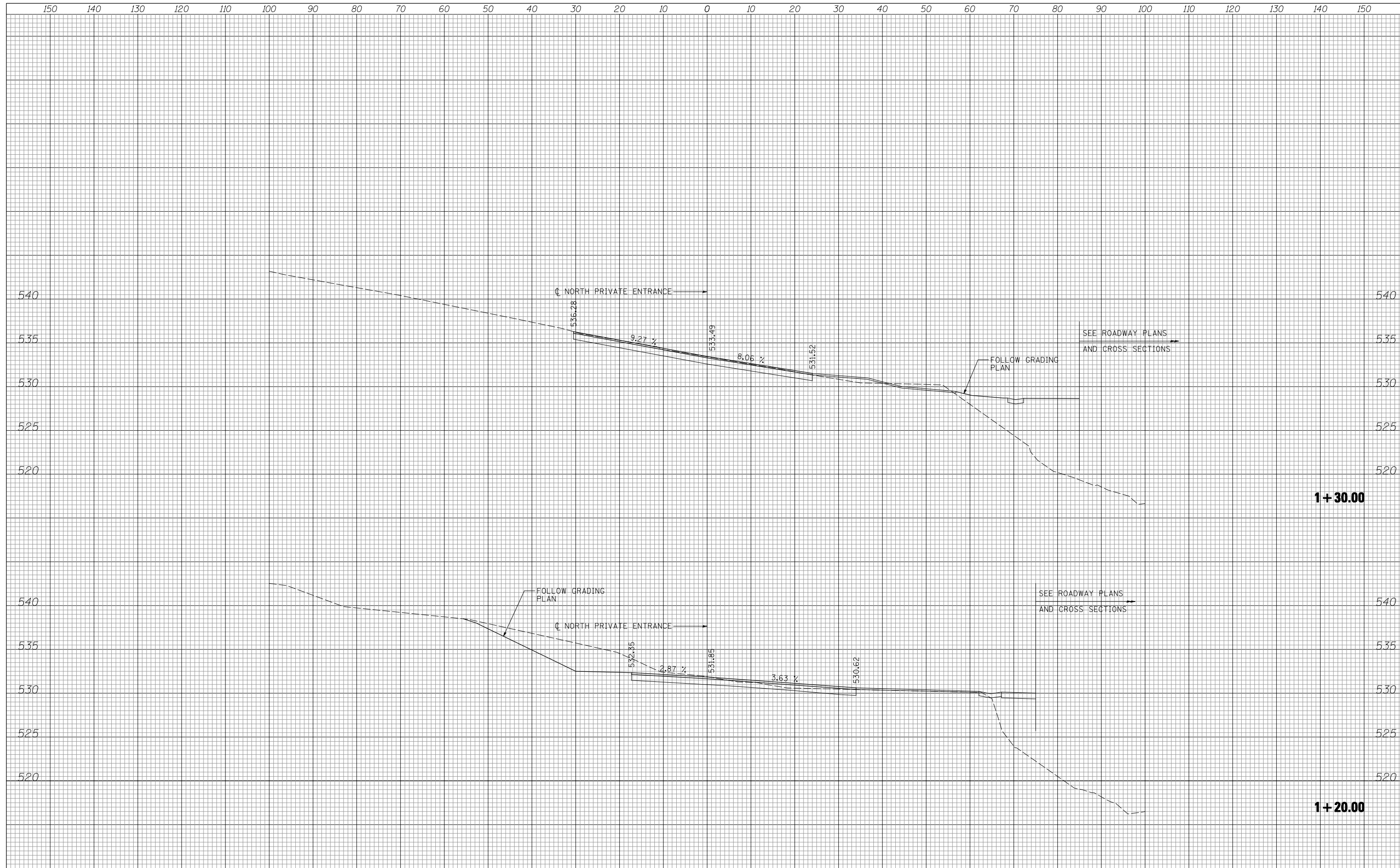

FILE NAME = ...D672867-shr-xshxht-NorthPE.dgn	USER NAME = Plotted by Roadways7	DESIGNED - RC	REVISIED -	STATE OF ILLINOIS DEPARTMENT OF TRANSPORTATION	IL ROUTE 96 OVER INLET DITCH NORTH PE CROSS SECTIONS	F.A.P. RTE.	SECTION	COUNTY	TOTAL SHEETS	SHEET NO.	
MODELNAME	PLOT SCALE = 20.0000' / IN.	CHECKED - AS	REVISIED -			510	510	HANCOCK	38	36	
	PLOT DATE = 10/19/2012	DATE - 10/2012	REVISIED -			SCALE: 1"=10'H, 5'V		SHEET 01 OF 03 SHEETS		STA. 1+20.00 TO STA. 1+30.00	
						FED. ROAD DIST. NO. 6 ILLINOIS FED. AID PROJECT					